

## Building Sketch

|                  |                                 |        |      |       |    |
|------------------|---------------------------------|--------|------|-------|----|
| Borrower         | N/A                             |        |      |       |    |
| Property Address | 4924 Moreland Heights School Rd |        |      |       |    |
| City             | Knoxville                       | County | Knox | State | TN |
| Zip Code         | 37920                           |        |      |       |    |
| Lender/Client    | Whitney Walker-McGhee           |        |      |       |    |

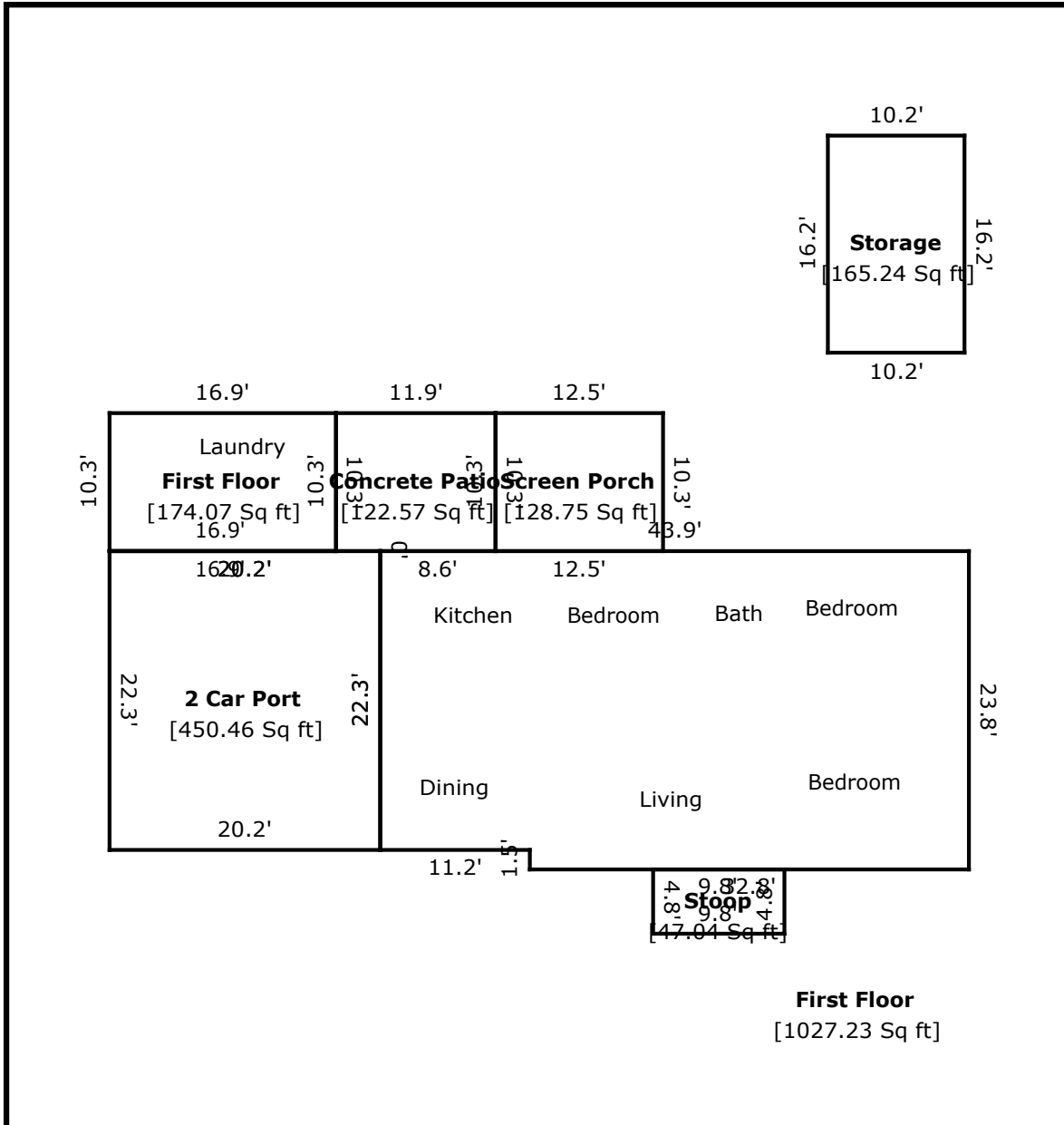

|                                     |                   |   |
|-------------------------------------|-------------------|---|
| TOTAL Sketch by a la mode           |                   | <b>Area Calculations Summary</b>  |
| <b>Living Area</b>                  |                   | <b>Calculation Details</b>  |
| First Floor                         | 174.1 Sq ft       | $16.9 \times 10.3 = 174.1$  |
| First Floor                         | 1027.2 Sq ft      | $23.8 \times 32.8 = 778.4$<br>$22.3 \times 11.2 = 248.9$                                      |
| <b>Total Living Area (Rounded):</b> | <b>1201 Sq ft</b> |   |
| <b>Non-living Area</b>              |                   |   |
| 2 Car Port                          | 450.5 Sq ft       | $20.2 \times 22.3 = 450.5$  |
| Stoop                               | 47 Sq ft          | $9.8 \times 4.8 = 47$   |
| Concrete Patio                      | 122.6 Sq ft       | $11.9 \times 10.3 = 122.6$<br>$0.5 \times 16.9 \times 0 = 0$<br>$0.5 \times 8.6 \times 0 = 0$ |
| Screen Porch                        | 128.7 Sq ft       | $10.3 \times 12.5 = 128.7$  |



## Subject Photo Page

|                  |                                 |        |      |       |    |          |       |
|------------------|---------------------------------|--------|------|-------|----|----------|-------|
| Borrower         | N/A                             |        |      |       |    |          |       |
| Property Address | 4924 Moreland Heights School Rd |        |      |       |    |          |       |
| City             | Knoxville                       | County | Knox | State | TN | Zip Code | 37920 |
| Lender/Client    | Whitney Walker-McGhee           |        |      |       |    |          |       |



### Subject Front

4924 Moreland Heights School Rd

6  
3  
1.0

### Subject Rear

