

INVOICE

FROM:
 Advanced Appraisal TN
 Advanced Appraisal TN
 4607 Chambliss Ave
 Knoxville, TN 37919-1373

Telephone Number: (865) 588-4008 Fax Number:

| INVOICE NUMBER | |
|-----------------------|------------|
| K0065943 | |
| DATES | |
| Invoice Date: | 04/22/2026 |
| Due Date: | 04/22/2026 |
| REFERENCE | |
| Internal Order #: | K0065943 |
| Lender Case #: | |
| Client File #: | |
| FHA/VA Case #: | |
| Main File # on form: | K0065943 |
| Other File # on form: | K0065943 |
| Federal Tax ID: | 30-0830665 |
| Employer ID: | |

TO:
 Kelly Arsenault

E-Mail:

Telephone Number: Fax Number:

Alternate Number:

DESCRIPTION

Lender: Kelly Arsenault Client: Kelly Arsenault
 Purchaser/Borrower: Kelly Arsenault
 Property Address: 225 Ailsie Dr
 City: Knoxville State: TN Zip: 37920
 County: Knox
 Legal Description:

| FEES | AMOUNT |
|------|--------|
|------|--------|

| | |
|-----------------|-------|
| Measurement | 75.00 |
| SUBTOTAL | |
| | 75.00 |

| PAYMENTS | AMOUNT |
|----------|--------|
|----------|--------|

| | | | |
|-----------------|-------|--------------|--|
| Check #: | Date: | Description: | |
| Check #: | Date: | Description: | |
| Check #: | Date: | Description: | |
| SUBTOTAL | | | |

| | | |
|------------------|--|-----------------|
| TOTAL DUE | | \$ 75.00 |
|------------------|--|-----------------|

Supplemental Addendum

File No. K0065943

| | | | | | |
|------------------|-----------------|--------|------|-------|-------------------|
| Borrower | Kelly Arsenault | | | | |
| Property Address | 225 Ailsie Dr | | | | |
| City | Knoxville | County | Knox | State | TN Zip Code 37920 |
| Lender/Client | Kelly Arsenault | | | | |

225 Ailsie Dr- 1633 sq ft

- 1st Level 898 sq ft**
- 2nd Level 734 sq ft**
- Unfinished Basement 480 sq ft**
- Workshop/Office (heated) 284 sq ft**
- Greenhouse 105 sq ft**
- Office (not heated) 121 sq ft**
- Garage 514 sq ft**
- Storage Under Garage 514 sq ft**

Signature _____
Name Jeremy Skalet
Date Signed _____
State Certification # 3215 State TN
Or State License # _____ State _____

Signature _____
Name _____
Date Signed _____
State Certification # _____ State _____
Or State License # _____ State _____

Building Sketch

| | | | | | |
|------------------|-----------------|--------|------|----------|-------|
| Borrower | Kelly Arsenault | | | | |
| Property Address | 225 Ailsie Dr | | | | |
| City | Knoxville | County | Knox | State | TN |
| | | | | Zip Code | 37920 |
| Lender/Client | Kelly Arsenault | | | | |

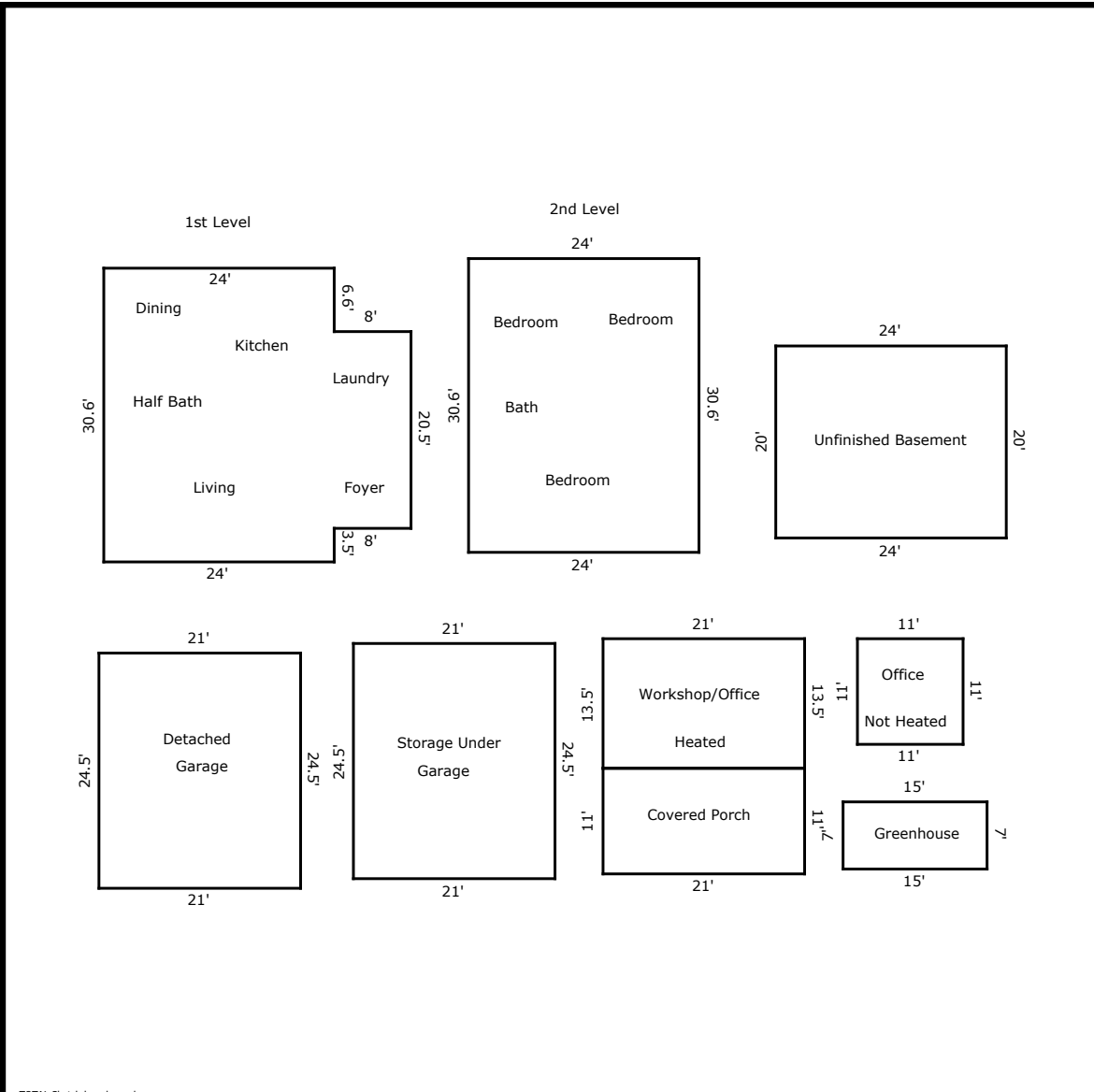

TOTAL Sketch by a la mode

Area Calculations Summary

| Living Area | Calculation Details | |
|-------------------------------------|---------------------|-------------------------------------|
| First Floor | 898.4 Sq ft | 30.6 × 24 = 734.4 20.5 × 8 = 164 |
| Second Floor | 734.4 Sq ft | 24 × 30.6 = 734.4 |
| Total Living Area (Rounded): | 1633 Sq ft | |
| Non-living Area | | |
| 2 Car Detached | 514.5 Sq ft | 24.5 × 21 = 514.5 |
| Concrete Patio | 231 Sq ft | 21 × 11 = 231 |
| Greenhouse | 105 Sq ft | 7 × 15 = 105 |
| Unfinished Basement | 480 Sq ft | 24 × 20 = 480 |
| Office | 121 Sq ft | 11 × 11 = 121 |
| Workshop/Office | 283.5 Sq ft | 13.5 × 21 = 283.5 |
| Storage Under Garage | 514.5 Sq ft | 24.5 × 21 = 514.5 |