

INVOICE

FROM:
 Advanced Appraisal TN
 Advanced Appraisal TN
 4607 Chambliss Ave
 Knoxville, TN 37919-1373

Telephone Number: (865) 588-4008 Fax Number:

INVOICE NUMBER	
K0065818	
DATES	
Invoice Date:	04/09/2026
Due Date:	04/09/2026
REFERENCE	
Internal Order #:	K0065818
Lender Case #:	
Client File #:	
FHA/VA Case #:	
Main File # on form:	K0065818
Other File # on form:	K0065818
Federal Tax ID:	30-0830665
Employer ID:	

TO:

Sharon Bailey
 8915 Linksvue Drive
 KNoxville, TN 37922

E-Mail: sfb2020@comcast.net
 Telephone Number: (865) 531-2020 Fax Number:
 Alternate Number:

DESCRIPTION

Lender: Sharon Bailey Client: Sharon Bailey
 Purchaser/Borrower: Sharon Bailey
 Property Address: 1330 Wagon Hitch Rd
 City: Knoxville State: TN Zip: 37934-2310
 County: Knox
 Legal Description:

FEES **AMOUNT**

Measurement	125.00
SUBTOTAL	
	125.00

PAYMENTS **AMOUNT**

Check #:	Date:	Description:	
Check #:	Date:	Description:	
Check #:	Date:	Description:	
SUBTOTAL			0

TOTAL DUE		\$ 125.00
------------------	--	------------------

Building Sketch

Borrower	Sharon Bailey				
Property Address	1330 Wagon Hitch Rd				
City	Knoxville	County	Knox	State	TN
Zip Code	37934-2310				
Lender/Client	Sharon Bailey				

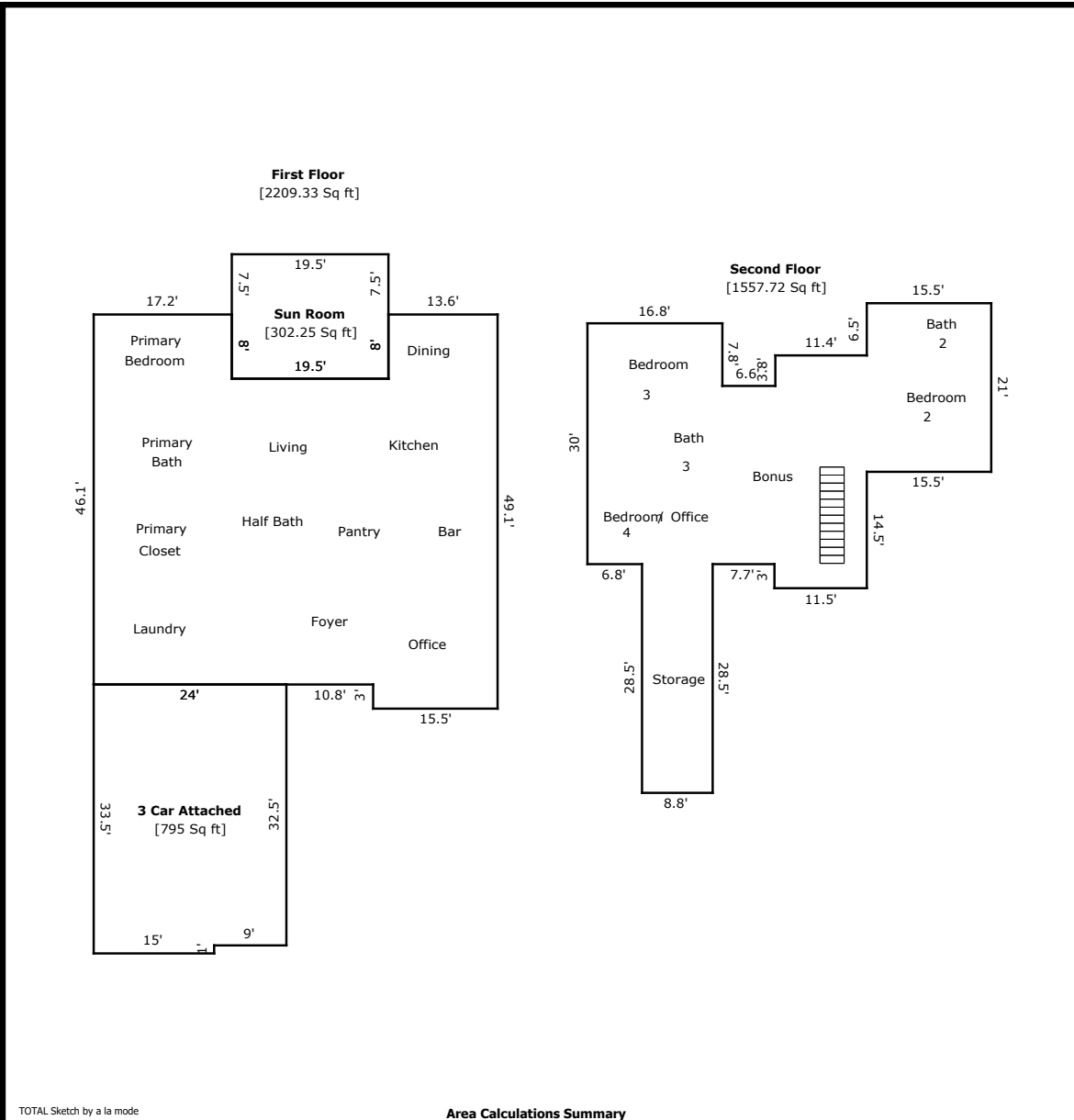

TOTAL Sketch by a la mode

Area Calculations Summary		
Living Area		Calculation Details
First Floor	2209.33 Sq ft	$17.2 \times 8 = 137.6$ $38.1 \times 34.8 = 1325.88$ $13.6 \times 8 = 108.8$ $15.5 \times 41.1 = 637.05$
Second Floor	1557.72 Sq ft	$8.8 \times 28.5 = 250.8$ $21 \times 15.5 = 325.5$ $30 \times 16.8 = 504$ $29 \times 11.4 = 330.6$ $6.6 \times 22.2 = 146.52$ $3 \times 0.1 = 0.3$
Total Living Area (Rounded):	3767 Sq ft	
Non-living Area		
3 Car Attached	795 Sq ft	$24 \times 32.5 = 780$ $1 \times 15 = 15$
Sun Room	302.25 Sq ft	$19.5 \times 15.5 = 302.25$

Supplemental Addendum

File No. K0065818

Borrower	Sharon Bailey						
Property Address	1330 Wagon Hitch Rd						
City	Knoxville	County	Knox	State	TN	Zip Code	37934-2310
Lender/Client	Sharon Bailey						

1330 Wagon Hitch- 3767 sq ft

1st Level- 2209 sq ft

Office 15 x 14
Laundry 12 x 7
Half Bath 5 x 5
Living 18 x 16
Pantry 8 x 5
Bar 8 x 6
Kitchen 17 x 12
Dining 12 x 8
Primary Bed 16 x 15
Primary Bath 12 x 10
Primary Closet 16 x 11

2nd Level- 1558 sq ft

Bed 2 14 x 14
Bath 2 8 x 5
Bonus 24 x 13
Bed 3 14 x 11
Bath 3 12 x 6
Bed 4/Office 14 x 11
Storage 28 x 8

Signature _____
Name Jeremy Skalet
Date Signed _____
State Certification # 3215 State TN
Or State License # _____ State _____

Signature _____
Name _____
Date Signed _____
State Certification # _____ State _____
Or State License # _____ State _____

Subject Photo Page

Borrower	Sharon Bailey						
Property Address	1330 Wagon Hitch Rd						
City	Knoxville	County	Knox	State	TN	Zip Code	37934-2310
Lender/Client	Sharon Bailey						



Subject Front

1330 Wagon Hitch Rd
Sales Price
Gross Living Area
Total Rooms
Total Bedrooms
Total Bathrooms
Location
View
Site
Quality
Age



Subject Rear

Subject Street