

| | | | | | | | | | | | | | |
|--|--|-----------------------|----------|-------------|------------|------------------|----------------------------|----------------|----------------|-------------------------------|--------------------------------|----------------------------|--------------|
| <p>FROM:</p> <p>Advanced Appraisal TN Advanced Appraisal TN 4607 Chambliss Ave Knoxville, TN 37919-1373</p> <p>Telephone Number: (865) 588-4008 Fax Number:</p> | <h2 style="margin: 0;">INVOICE</h2> <table border="1" style="width: 100%; border-collapse: collapse; margin-top: 5px;"> <tr style="background-color: #cccccc;"><td style="text-align: center;">INVOICE NUMBER</td></tr> <tr><td style="text-align: center;">K0065454</td></tr> <tr style="background-color: #cccccc;"><td style="text-align: center;">DATE</td></tr> <tr><td style="text-align: center;">03/02/2026</td></tr> <tr style="background-color: #cccccc;"><td style="text-align: center;">REFERENCE</td></tr> <tr><td>Internal Order #: K0065454</td></tr> <tr><td>Lender Case #:</td></tr> <tr><td>Client File #:</td></tr> <tr><td>Main File # on form: K0065454</td></tr> <tr><td>Other File # on form: K0065454</td></tr> <tr><td>Federal Tax ID: 30-0830665</td></tr> <tr><td>Employer ID:</td></tr> </table> | INVOICE NUMBER | K0065454 | DATE | 03/02/2026 | REFERENCE | Internal Order #: K0065454 | Lender Case #: | Client File #: | Main File # on form: K0065454 | Other File # on form: K0065454 | Federal Tax ID: 30-0830665 | Employer ID: |
| INVOICE NUMBER | | | | | | | | | | | | | |
| K0065454 | | | | | | | | | | | | | |
| DATE | | | | | | | | | | | | | |
| 03/02/2026 | | | | | | | | | | | | | |
| REFERENCE | | | | | | | | | | | | | |
| Internal Order #: K0065454 | | | | | | | | | | | | | |
| Lender Case #: | | | | | | | | | | | | | |
| Client File #: | | | | | | | | | | | | | |
| Main File # on form: K0065454 | | | | | | | | | | | | | |
| Other File # on form: K0065454 | | | | | | | | | | | | | |
| Federal Tax ID: 30-0830665 | | | | | | | | | | | | | |
| Employer ID: | | | | | | | | | | | | | |
| <p>TO:</p> <p>Emily Randall</p> <p>Telephone Number: Fax Number:</p> <p>Alternate Number: E-Mail:</p> | | | | | | | | | | | | | |
| DESCRIPTION | | | | | | | | | | | | | |
| <p>Lender: Emily Randall Client: Emily Randall</p> <p>Purchaser/Borrower: Emily Randall</p> <p>Property Address: 1245 S Heritage Dr</p> <p>City: Maryville State: TN Zip: 37803</p> <p>County: Blount</p> <p>Legal Description:</p> | | | | | | | | | | | | | |
| FEES | AMOUNT | | | | | | | | | | | | |
| Measurement | 200.00 | | | | | | | | | | | | |
| SUBTOTAL | 200.00 | | | | | | | | | | | | |
| PAYMENTS | AMOUNT | | | | | | | | | | | | |
| <p>Check #: Date: Description:</p> <p>Check #: Date: Description:</p> <p>Check #: Date: Description:</p> | | | | | | | | | | | | | |
| SUBTOTAL | 0.00 | | | | | | | | | | | | |
| TOTAL DUE | \$ 200.00 | | | | | | | | | | | | |

Subject Photo Page

| | | | | | | | |
|------------------|--------------------|--------|--------|-------|----|----------|-------|
| Borrower | Emily Randall | | | | | | |
| Property Address | 1245 S Heritage Dr | | | | | | |
| City | Maryville | County | Blount | State | TN | Zip Code | 37803 |
| Lender/Client | Emily Randall | | | | | | |



Subject Front



Subject Rear

Supplemental Addendum

File No. K0065454

| | | | | | | | |
|------------------|--------------------|--------|--------|-------|----|----------|-------|
| Borrower | Emily Randall | | | | | | |
| Property Address | 1245 S Heritage Dr | | | | | | |
| City | Maryville | County | Blount | State | TN | Zip Code | 37803 |
| Lender/Client | Emily Randall | | | | | | |

1245 S Heritage Dr- 5138 sq ft

1st Level- 3577 sq ft

Bed 1 21 x 15
Bath 1 12 x 10
Bed 2 18 x 15
Bath 2 9 x 5
Bed 3 13 x 13
Bath 3 9 x 7
Bed 4 13 x 13
Bath 4 10 x 5
Living 22 x 13
Dining 17 x 13
Kitchen 19 x 13
Office 13 x 9
Laundry/Craft 18 x 8
Mud Room 7 x 7
Sun Room 15 x 11

Basement- 1561 sq ft

Rec 32 x 13
Family 23 x 13
Bath 10 x 9
Bed 20 x 13

Unfinished Basement- 649 sq ft (total for both unfinished areas)

Building Sketch

| | | | | | |
|------------------|--------------------|----------|--------|-------|----|
| Borrower | Emily Randall | | | | |
| Property Address | 1245 S Heritage Dr | | | | |
| City | Maryville | County | Blount | State | TN |
| Lender/Client | Emily Randall | Zip Code | 37803 | | |

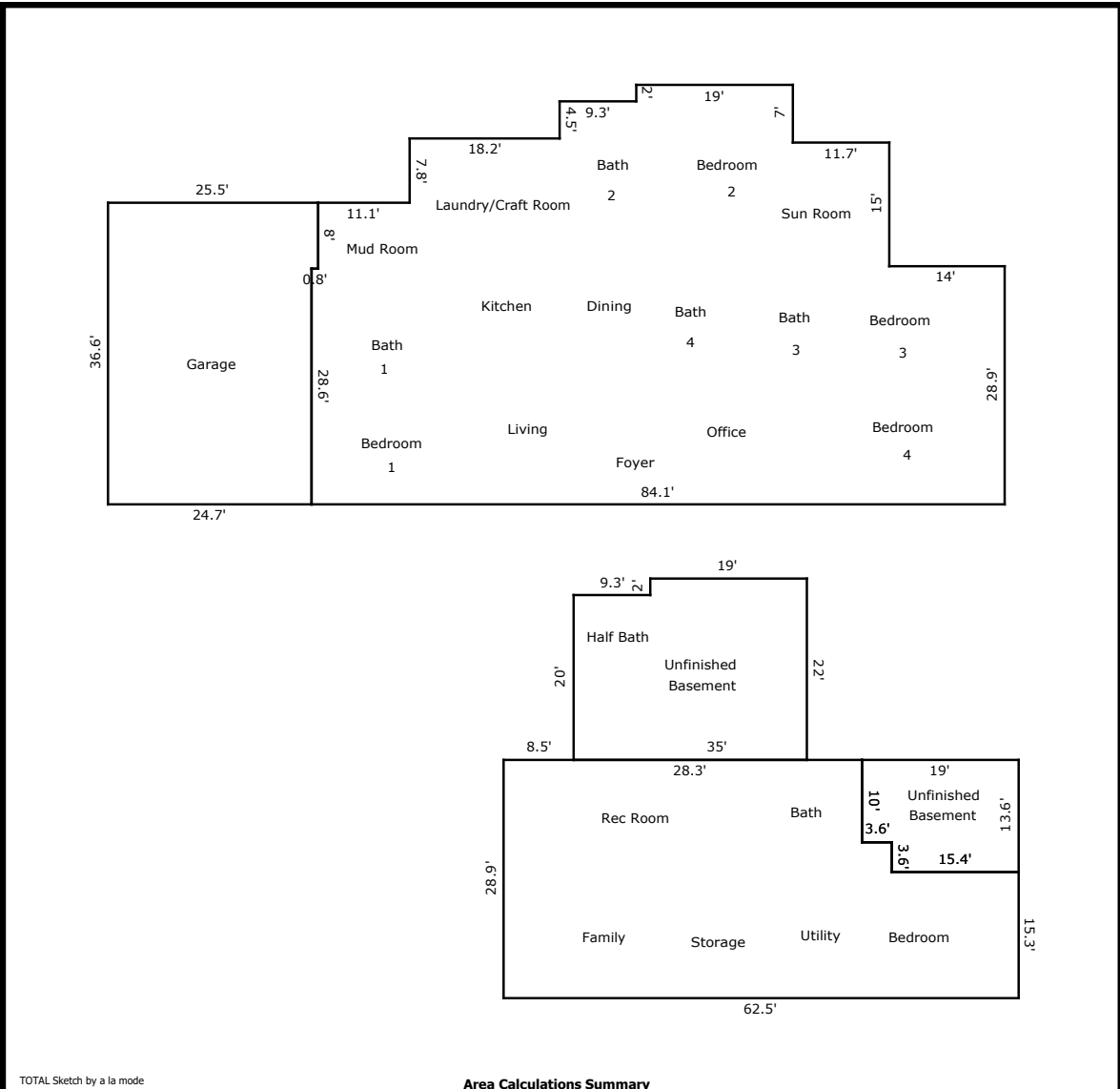

TOTAL Sketch by a la mode

Area Calculations Summary

| Living Area | Area | Calculation Details |
|-------------------------------------|-------------------|--|
| Basement | 1560.81 Sq ft | $15.3 \times 15.4 = 235.62$ $28.9 \times 43.5 = 1257.15$ $3.6 \times 18.9 = 68.04$ |
| First Level | 3577.32 Sq ft | $28.9 \times 14 = 404.6$ $70.1 \times 28.6 = 2004.86$ $15.3 \times 11.7 = 179.01$ $22.3 \times 19 = 423.7$ $8 \times 11.1 = 88.8$ $15.8 \times 18.2 = 287.56$ $20.3 \times 9.3 = 188.79$ |
| Total Living Area (Rounded): | 5138 Sq ft | |
| Non-living Area | | |
| 3 Car Attached | 910.42 Sq ft | $24.7 \times 28.6 = 706.42$ $8 \times 25.5 = 204$ |
| Unfinished Basement | 245.44 Sq ft | $13.6 \times 15.4 = 209.44$ $3.6 \times 10 = 36$ |
| Unfinished Basement | 604 Sq ft | $22 \times 19 = 418$ $9.3 \times 20 = 186$ |