

Supplemental Addendum

File No. K0060526

Borrower	N/A						
Property Address	1304 Hickoryoak Ln						
City	Knoxville	County	Knox	State	TN	Zip Code	37919
Lender/Client	N/A						

Measurements of 1304 Hickoryoak Ln

1st Level **1352 square feet**
2nd Level **1040 square feet**

Total **2392 square feet**

The Square Footage-Method for Calculating: ANSI® Z765-2021 (American National Standards Institute®) Measuring Standard for calculating gross living area (GLA), and non-GLA areas of the subject property, was utilized in creating the sketch for this measurement report.

Interior Rooms

Main level

Living 15.5 x 17.5
Dining 12 x 11
Kitchen 12 x 9.5
Breakfast 8 x 10.5
Family 14 x 17.5
Half Bath 5 x 5.5
Laundry 5 x 5.5
Office 10 x 13.5

2nd level

Bedroom 10 x 10.5 x irr
Bedroom 10 x 10.5 x irr
Bath 10.5 x 5
Bedroom 22.5 x 17.5x irr
Bath 7.5 x 13.5 x irr

Interior rooms are measured to the nearest 0.25 foot.

Signature 
Name Charles Skalet
Date Signed 06/17/2024
State Certification # CR-2399 State TN
Or State License # _____ State _____

Signature _____
Name _____
Date Signed _____
State Certification # _____ State _____
Or State License # _____ State _____

Subject Photo Page

Borrower	N/A						
Property Address	1304 Hickoryoak Ln						
City	Knoxville	County	Knox	State	TN	Zip Code	37919
Lender/Client	N/A						



Subject Front

1304 Hickoryoak Ln

2,392

8

3

2.1

44

Subject Rear



Subject Street

Chi Hk

Building Sketch

Borrower	N/A				
Property Address	1304 Hickoryoak Ln				
City	Knoxville	County	Knox	State	TN Zip Code 37919
Lender/Client	N/A				

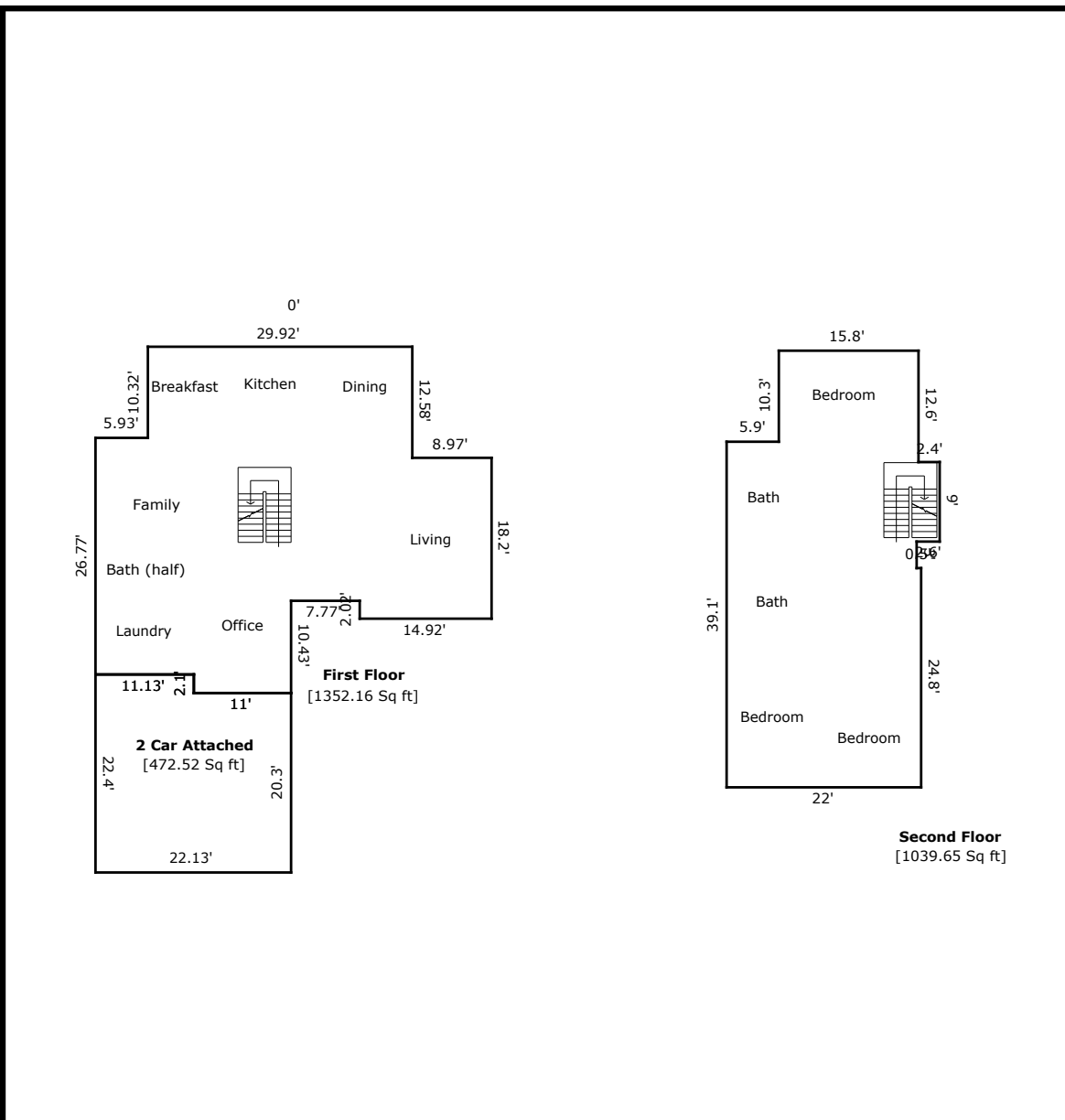

TOTAL Sketch by a la mode

Area Calculations Summary

Living Area	Calculation Details	
First Floor	1352.16 Sq ft	$18.2 \times 8.97 = 163.22$ $29.92 \times 10.32 = 308.73$ $35.84 \times 18.43 = 660.68$ $10.43 \times 11 = 114.78$ $8.33 \times 11.13 = 92.73$ $2.02 \times 5.95 = 12.01$
Second Floor	1039.65 Sq ft	$22 \times 24.8 = 545.6$ $15.8 \times 10.3 = 162.74$ $14.3 \times 21.5 = 307.45$ $2.6 \times 9 = 23.4$ $2.3 \times 0.2 = 0.46$
Total Living Area (Rounded):	2392 Sq ft	
Non-living Area		
2 Car Attached	472.52 Sq ft	$22.13 \times 20.3 = 449.16$ $2.1 \times 11.13 = 23.36$

Chi Hk