

Supplemental Addendum

File No. K0060062

Borrower	N/A				
Property Address	420 Royal Birkdale Rd				
City	Farragut	County	Knox	State	TN      Zip Code    37934
Lender/Client	Carla Bailey				

Measurements for 420 Royal Birkdale Rd

1st Floor1675 square feet

2nd Floor1253 square feet

Total GLA2929 square feet

Garage741 square feet

The Square Footage-Method for Calculating: ANSI® Z765-2021 (American National Standards Institute®) Measuring Standard for calculating gross living area (GLA), and non-GLA areas of the subject property, was utilized in creating the sketch for this appraisal report.

Signature  
Name Charles Skalet  
Date Signed  
State Certification # CR-2399      State TN  
Or State License #      State

Signature  
Name  
Date Signed  
State Certification #      State  
Or State License #      State

Subject Photo Page

Borrower	N/A				
Property Address	420 Royal Birkdale Rd				
City	Farragut	County	Knox	State	TN      Zip Code    37934
Lender/Client	Carla Bailey				



Subject Front

420 Royal Birkdale Rd



Subject Rear



Subject Street

Building Sketch (Page - 1)

Borrower	N/A				
Property Address	420 Royal Birkdale Rd				
City	Farragut	County	Knox	State	TN      Zip Code    37934
Lender/Client	Carla Bailey				

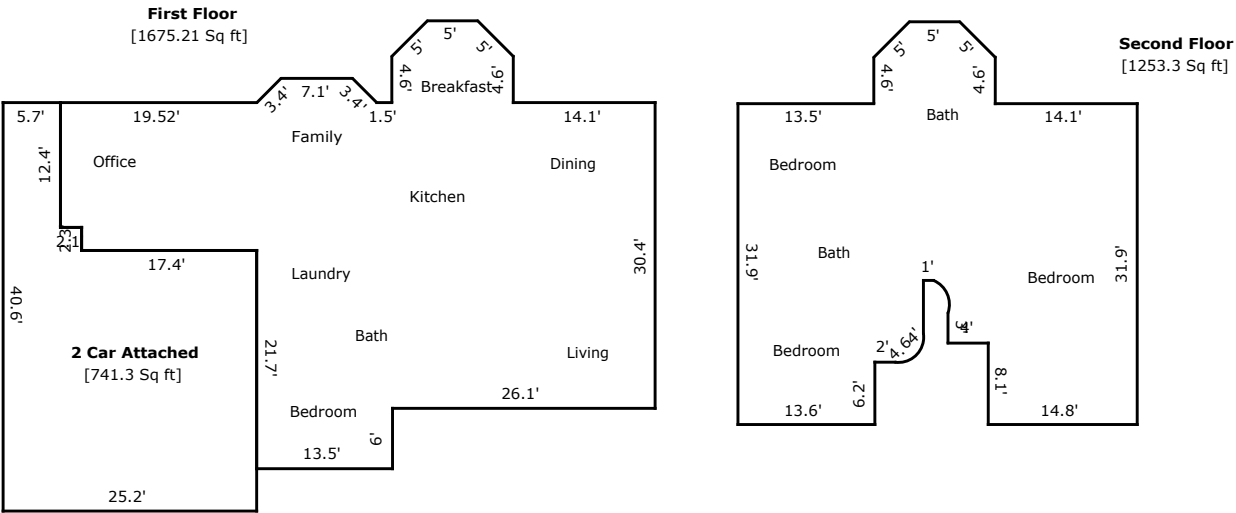

TOTAL Sketch by a la mode

Building Sketch (Page - 2)

Borrower	N/A				
Property Address	420 Royal Birkdale Rd				
City	Farragut	County	Knox	State	TN      Zip Code    37934
Lender/Client	Carla Bailey				

TOTAL Sketch by a la mode

Area Calculations Summary

Living Area		Calculation Details	
First Floor	1675.21 Sq ft	$0.5 \times 2.4 \times 2.4$	= 2.89
		$0.5 \times 2.4 \times 2.4$	= 2.89
		$7.1 \times 2.4$	= 17.07
		$13.5 \times 6$	= 81
		$39.6 \times 15.7$	= 621.72
		$57 \times 2.3$	= 131.1
		$59.1 \times 12.4$	= 732.84
		$12.07 \times 4.6$	= 55.53
		$0.5 \times 3.54 \times 3.54$	= 6.25
		$0.5 \times 3.54 \times 3.54$	= 6.25
		$5 \times 3.54$	= 17.68
Second Floor	1253.3 Sq ft	$14.8 \times 8.1$	= 119.88
		$13.6 \times 6.2$	= 84.32
		$0.5 \times 2.83 \times 2.83$	= 4
		$15.6 \times 2.83$	= 44.12
		$18.8 \times 3$	= 56.4
		$18.43 \times 5.3$	= 97.67
		$0.5 \times 1.44 \times 3.23$	= 2.33
		$18.8 \times 3.23$	= 60.69
		$39.67 \times 17.57$	= 697.08
		$12.07 \times 4.6$	= 55.53
		$0.5 \times 3.54 \times 3.54$	= 6.25
		$0.5 \times 3.54 \times 3.54$	= 6.25
		$5 \times 3.54$	= 17.68
		Arc	= 2.8
		Negative Arc	= 1.7
Total Living Area (Rounded):		2929 Sq ft	
Non-living Area			
2 Car Attached	741.3 Sq ft	$25.2 \times 25.9$	= 652.68
		$2.3 \times 2.1$	= 4.83
		$14.7 \times 5.7$	= 83.79