

Supplemental Addendum

File No. K60026

Borrower	N/A				
Property Address	3322 Bellevue St				
City	Knoxville	County	Knox	State	TN      Zip Code    37917
Lender/Client	N/A				

Measurements for 3322 Bellevue St

1st Floor	1254 square feet
Total GLA	1254 square feet
2nd Level (no heat)	154 square feet
Unfinished Basement	1031 square feet

The Square Footage-Method for Calculating: ANSI® Z765-2021 (American National Standards Institute®) Measuring Standard for calculating gross living area (GLA), and non-GLA areas of the subject property, was utilized in creating the sketch for this appraisal report.

Interior Room Measurements

1st Floor

Living	18 x 12
Dining	9.5 x 9
Eat in kitchen	17 x 10.5
Bedroom 1	12.5 x 9
Bathroom 1	9 x 4
Office	12.5 x 9
Bedroom 2	17 x 11.5

2nd Floor

Bonus	15.5 x 9
-------	----------

Basement

Half bath	5 x 4.5
Laundry	12 x 10

The room measurements are interior wall to interior wall and rounded to the nearest 0.5 foot.

Signature \_\_\_\_\_  
Name Charles Skalet \_\_\_\_\_  
Date Signed \_\_\_\_\_  
State Certification # CR-2399 State TN \_\_\_\_\_  
Or State License # \_\_\_\_\_ State \_\_\_\_\_

Signature \_\_\_\_\_  
Name \_\_\_\_\_  
Date Signed \_\_\_\_\_  
State Certification # \_\_\_\_\_ State \_\_\_\_\_  
Or State License # \_\_\_\_\_ State \_\_\_\_\_

Subject Photo Page

Borrower	N/A					
Property Address	3322 Bellevue St					
City	Knoxville	County	Knox	State	TN	Zip Code 37917
Lender/Client	N/A					



Subject Front

3322 Bellevue St



Subject Rear



Subject Street

Building Sketch

Borrower	N/A				
Property Address	3322 Bellevue St				
City	Knoxville	County	Knox	State	TN      Zip Code    37917
Lender/Client	N/A				

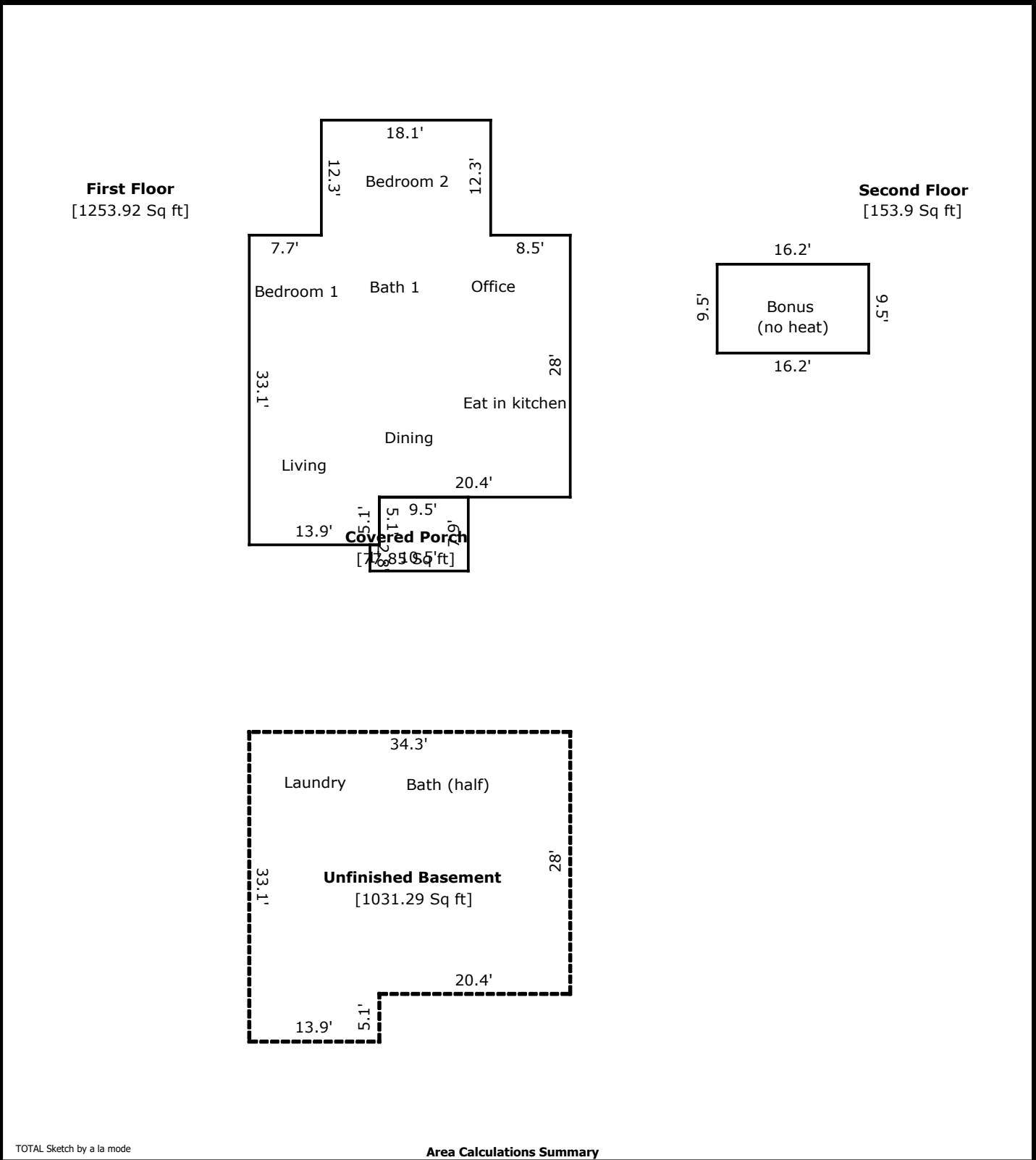

Living Area		Calculation Details	
First Floor	1253.92 Sq ft	$18.1 \times 12.3 =$	222.63
		$34.3 \times 28 =$	960.4
		$5.1 \times 13.9 =$	70.89
Total Living Area (Rounded):		1254 Sq ft	
Non-living Area			
Second Floor	153.9 Sq ft	$9.5 \times 16.2 =$	153.9
Unfinished Basement	1031.29 Sq ft	$34.3 \times 28 =$	960.4
		$5.1 \times 13.9 =$	70.89
Covered Porch	77.85 Sq ft	$7.9 \times 9.5 =$	75.05
		$1 \times 2.8 =$	2.8