

Building Sketch

Borrower					
Property Address	1540 Whitower Dr				
City	Knoxville	County	KNOXVILLE	State	TN
Zip Code	37919				
Lender/Client	Rachael Wedekind				

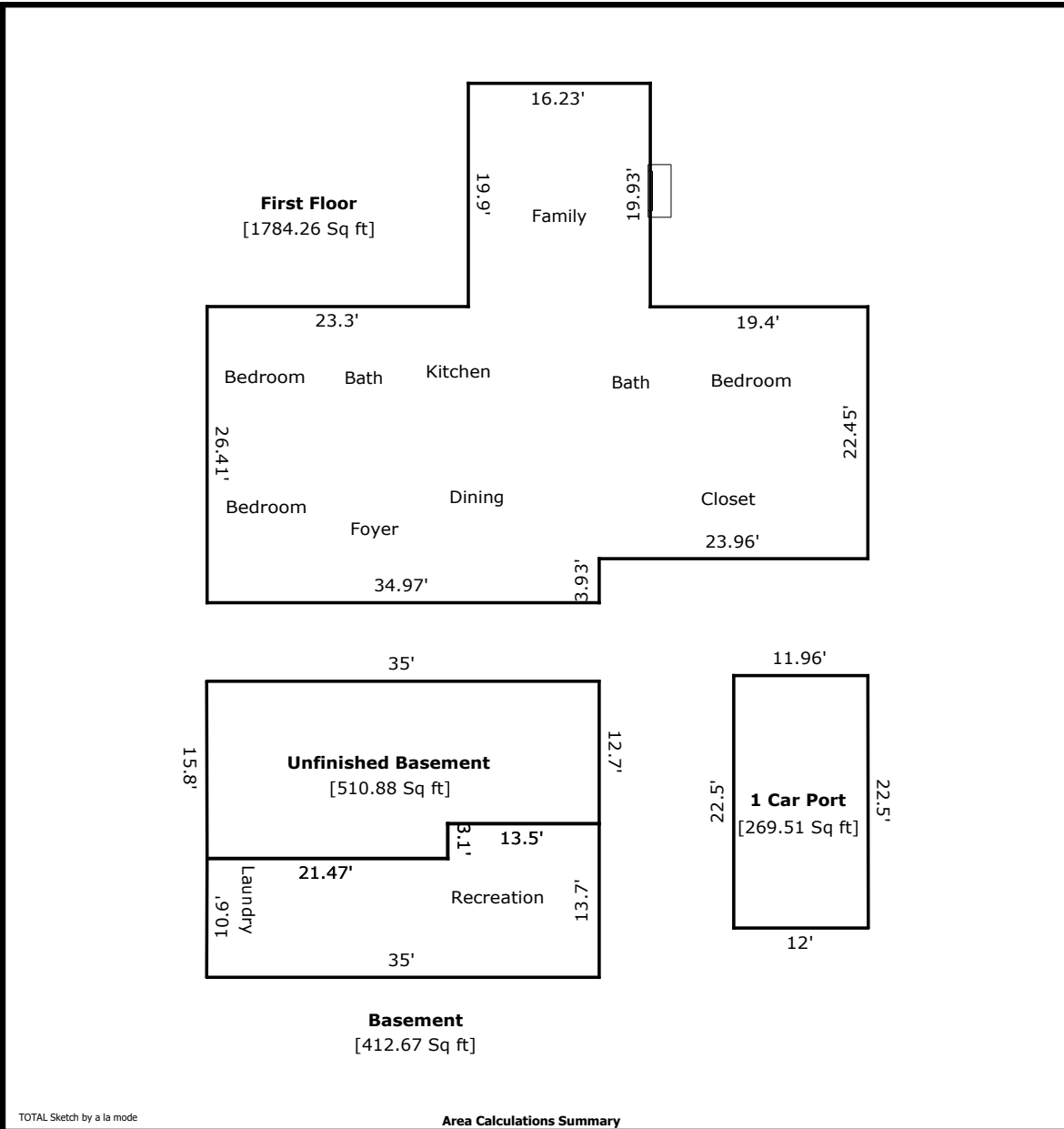

TOTAL Sketch by a la mode

Area Calculations Summary

Living Area	Calculation Details	
First Floor	1784.26 Sq ft	$26.41 \times 23.3 = 615.17$ $22.45 \times 19.4 = 435.56$ $16.23 \times 42.38 = 687.73$ $3.93 \times 11.67 = 45.81$
Total Living Area (Rounded):	1784 Sq ft	
Non-living Area		
Unfinished Basement	510.88 Sq ft	$12.7 \times 13.5 = 171.45$ $15.8 \times 21.47 = 339.15$ $0.5 \times 15.8 \times 0.03 = 0.27$
Basement	412.67 Sq ft	$13.7 \times 13.5 = 184.95$ $10.6 \times 21.47 = 227.53$ $0.5 \times 10.6 \times 0.03 = 0.18$
1 Car Port	269.51 Sq ft	$22.5 \times 11.96 = 269.03$ $0.5 \times 22.5 \times 0.04 = 0.48$

Subject Photo Page

Borrower							
Property Address	1540 Whitower Dr						
City	Knoxville	County	KNOXVILLE	State	TN	Zip Code	37919
Lender/Client	Rachael Wedekind						



Subject Front

1540 Whitower Dr

Subject Rear



Subject Street