



<b>Supplemental Addendum</b>					File No. 0059092	
Borrower						
Property Address 1517 Aldenwood Ln						
City		Knoxville		County		Knox
				State		TN
Lender/Client		Deborah Cope				

Measurements of 1517 Aldenwood Ln

1st Floor	1244 sf
<u>Finished Basement</u>	<u>1590 sf</u>
Total Finished	2834 sf

Garage	478 sf
--------	--------

The Square Footage-Method for Calculating: ANSI® Z765-2021 (American National Standards Institute®) Measuring Standard for calculating gross living area (GLA), and non-GLA areas of the subject property, was utilized in creating the sketch for this measurement report.

Interior Room Measurements (measured to the nearest 0.5 ft)

1st Floor

Living	21 x 12.5
Kitchen	13.5 x 12
Dining	12 x 8.5
Bathroom 1	11.5 x 10.5 x irr
Bedroom 1	11.5 x 10
Bedroom 2	11.5 x 11 x irr
Bedroom 3	12.5 x 11.5

Basement

Primary Bed	22 x 12.5
Primary Bath	12.5 x 11 x irr
Bathroom 3	9.5 x 6 x irr
Laundry	14 x 6
Utility	12.5 x 8.5 x irr
Family	23.5 x 17.5 x irr

Signature _____	Signature _____
Name <u>Charles Skalet</u>	Name _____
Date Signed _____	Date Signed _____
State Certification # <u>CR-2399</u> State <u>TN</u>	State Certification # _____ State _____
Or State License # _____ State _____	Or State License # _____ State _____

Subject Photo Page

Borrower				
Property Address 1517 Aldenwood Ln				
City	Knoxville	County	Knox	State TN Zip Code 37919
Lender/Client Deborah Cope				



**Subject Front**  
1517 Aldenwood Ln



**Subject Rear**



**Subject Street**

Building Sketch

Borrower				
Property Address 1517 Aldenwood Ln				
City	Knoxville	County	Knox	State TN Zip Code 37919
Lender/Client Deborah Cope				

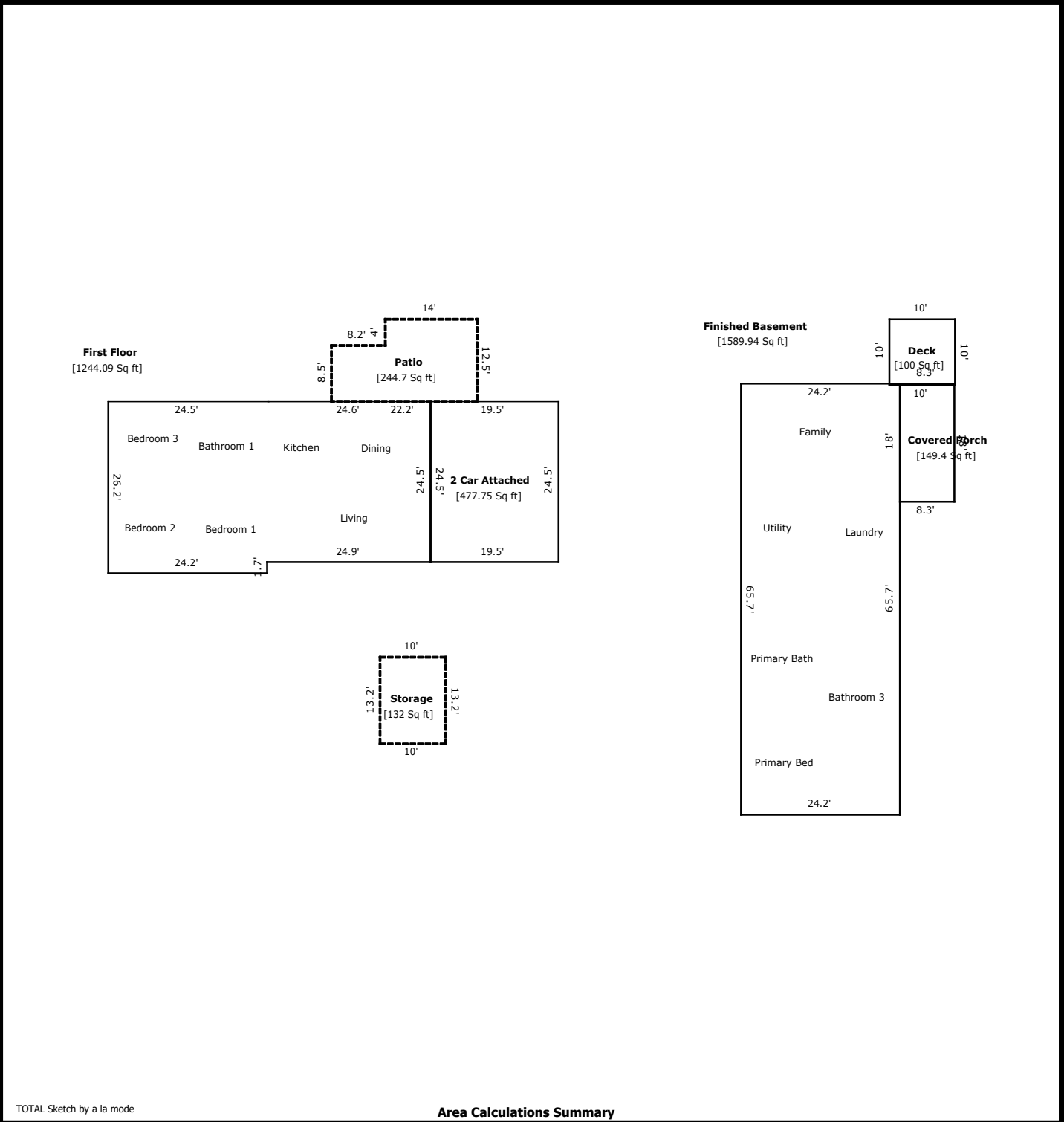

TOTAL Sketch by a la mode

Area Calculations Summary

Living Area		Calculation Details	
First Floor	1244.09 Sq ft	$24.5 \times 24.9 =$	610.05
		$26.2 \times 24.2 =$	634.04
Total Living Area (Rounded):		1244 Sq ft	
Non-living Area			
Covered Porch	149.4 Sq ft	$18 \times 8.3 =$	149.4
Deck	100 Sq ft	$10 \times 10 =$	100
Finished Basement	1589.94 Sq ft	$65.7 \times 24.2 =$	1589.94
Storage	132 Sq ft	$13.2 \times 10 =$	132
Patio	244.7 Sq ft	$8.5 \times 8.2 =$	69.7
		$14 \times 12.5 =$	175
2 Car Attached	477.75 Sq ft	$19.5 \times 24.5 =$	477.75