

Subject Photo Page

Borrower	N/A						
Property Address	1605 Verdi Ln						
City	Knoxville	County	Knox	State	TN	Zip Code	37922
Lender/Client							



Subject Front



Subject Rear



Subject Street

Building Sketch

Borrower	N/A				
Property Address	1605 Verdi Ln				
City	Knoxville	County	Knox	State	TN
				Zip Code	37922
Lender/Client					

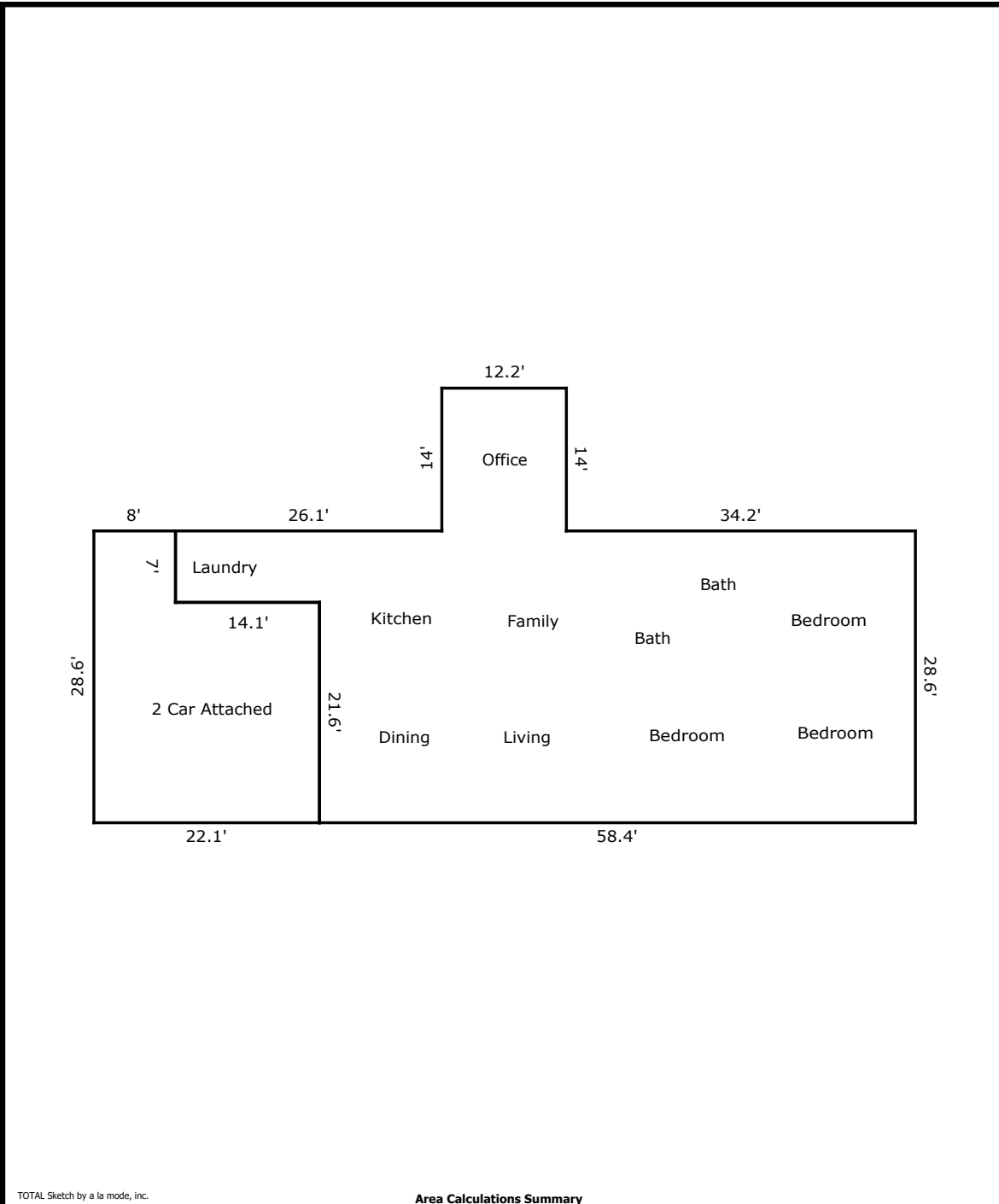

TOTAL Sketch by a la mode, inc.

Area Calculations Summary

Living Area	Calculation Details	
First Floor	1939.74 Sq ft	$12.2 \times 14 = 170.8$ $7 \times 14.1 = 98.7$ $28.6 \times 58.4 = 1670.24$
Total Living Area (Rounded):	1940 Sq ft	
Non-living Area		
2 Car Attached	533.36 Sq ft	$22.1 \times 21.6 = 477.36$ $7 \times 8 = 56$

Supplemental Addendum

File No. 0058925

Borrower	N/A						
Property Address	1605 Verdi Ln						
City	Knoxville	County	Knox	State	TN	Zip Code	37922
Lender/Client							

Measurements of 1605 Verdi Ln

Main Level **1,940 sq ft**

Total **1,940 sq ft**

Garage **533 sq ft**

The Square Footage-Method for Calculating: ANSI® Z765-2021 (American National Standards Institute®) Measuring Standard for calculating gross living area (GLA), and non-GLA areas of the subject property, was utilized in creating the sketch for this measurement report.

Signature _____
 Name Charles Skalet
 Date Signed 07/17/2023
 State Certification # CR-2399 State TN
 Or State License # _____ State _____

Signature _____
 Name _____
 Date Signed _____
 State Certification # _____ State _____
 Or State License # _____ State _____