

Subject Photo Page

Borrower	N/A				
Property Address	899 Point Harbor Dr				
City	Lenoir City	County	Loudon	State	TN Zip Code 37772
Lender/Client					



Subject Front



Subject Rear



Subject Street

Supplemental Addendum

File No. 0058743

Borrower	N/A				
Property Address	899 Point Harbor Dr				
City	Lenoir City	County	Loudon	State	TN Zip Code 37772
Lender/Client					

Measurements of 899 Point Harbour Dr

Main Level 1418 sq ft
Second Level 1054 sq ft
Basement 1305 sq ft

Total 3777 sq ft

Garage 518 sq ft

The Square Footage-Method for Calculating: ANSI® Z765-2021 (American National Standards Institute®) Measuring Standard for calculating gross living area (GLA), and non-GLA areas of the subject property, was utilized in creating the sketch for this measurement report.

Interior Rooms

1st Level

Dining 14.5 x 11.5
Kitchen 17.5 x 11.5
Living 14 x 27
Half Bath 4 x 5.5
Family 16 x 8
Laundry 10 x 11.5

2nd Level

Bedroom 1 22.5 x 18
Bath 1 22.5 x 4.5
Bedroom 2 14 x 14
Bath 2 9.5 x 5.5

Basement

Bedroom 3 19 x 13
Bath 3 9.5 x 7
Office 9 x 7.5
Rec Room 18 x 23
Laundry/Utility 13 x 10

The room measurements are interior wall to interior wall and rounded to the nearest 0.5 foot.

Signature _____
 Name Charles Skalet
 Date Signed 07/17/2023
 State Certification # CR-2399 State TN
 Or State License # _____ State _____

Signature _____
 Name _____
 Date Signed _____
 State Certification # _____ State _____
 Or State License # _____ State _____

Building Sketch

Borrower	N/A				
Property Address	899 Point Harbor Dr				
City	Lenoir City	County	Loudon	State	TN
				Zip Code	37772
Lender/Client					

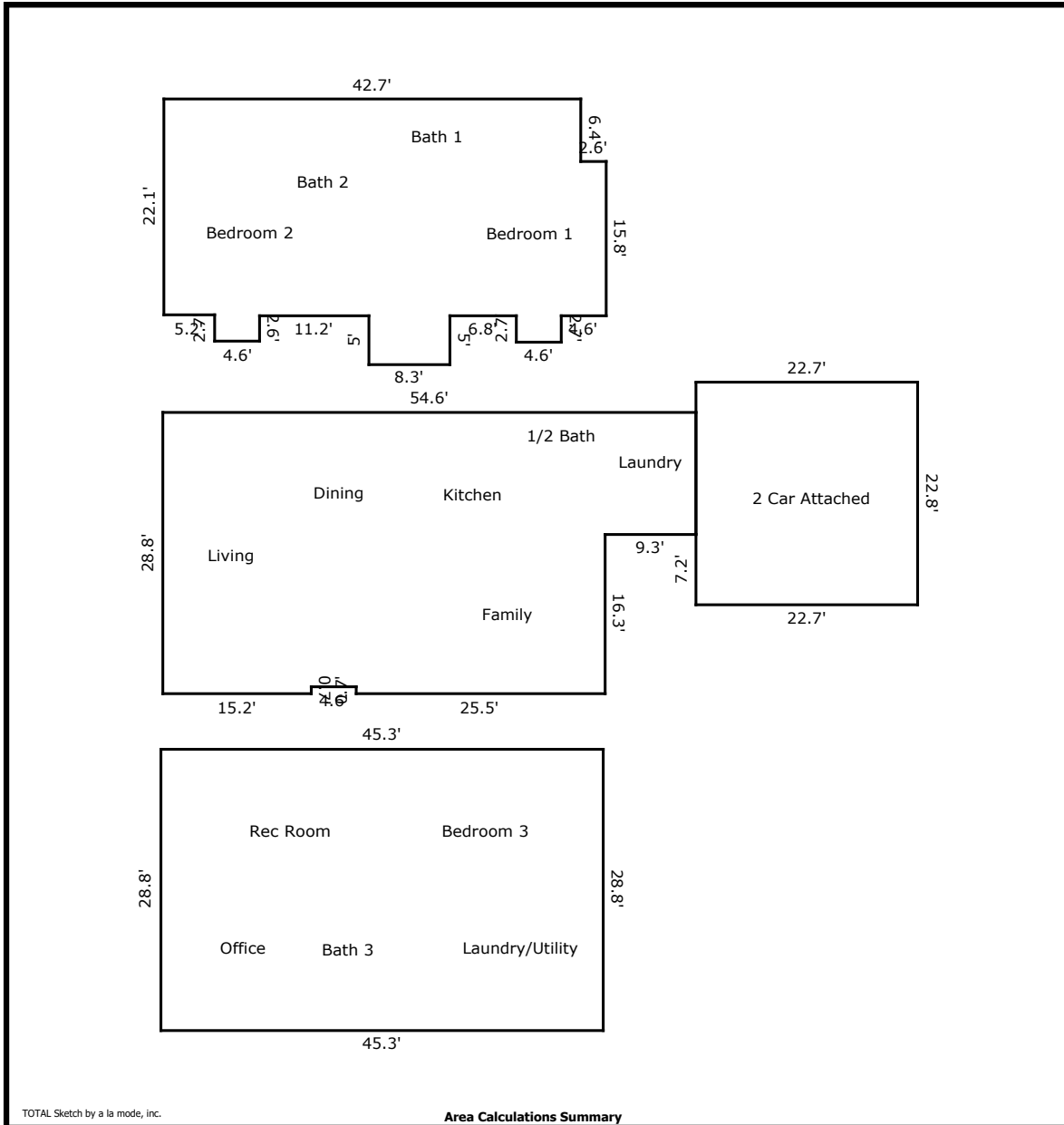

Area Calculations Summary

Living Area	Calculation Details	
First Floor	1417.67 Sq ft	$12.5 \times 9.3 = 116.25$ $28.8 \times 25.5 = 734.4$ $19.8 \times 28.1 = 556.38$ $0.7 \times 15.2 = 10.64$
Second Floor	1054.38 Sq ft	$4.6 \times 2.7 = 12.42$ $8.3 \times 5 = 41.5$ $4.6 \times 2.6 = 11.96$ $22.1 \times 5.2 = 114.92$ $22.2 \times 37.5 = 832.5$ $2.6 \times 15.8 = 41.08$
Basement	1304.64 Sq ft	$28.8 \times 45.3 = 1304.64$
Total Living Area (Rounded):	3777 Sq ft	
Non-living Area		
2 Car Attached	517.56 Sq ft	$22.7 \times 22.8 = 517.56$