

Supplemental Addendum

File No. 0058060

Borrower	N/A		
Property Address	1523 Bickerstaff Blvd		
City	Knoxville	County	Knox
Lender/Client		State	TN
		Zip Code	37922

Measurements of 1523 Bickerstaff Blvd

1st Floor **1938 sq ft**
2nd Floor **1399 sq ft**
Total Finished **3337 sq ft**

The Square Footage-Method for Calculating: ANSI® Z765-2021 (American National Standards Institute®) Measuring Standard for calculating gross living area (GLA), and non-GLA areas of the subject property, was utilized in creating the sketch for this measurement report.

Interior Room Measurements (measured from interior and rounded to the nearest 0.25 ft)

1ST LEVEL

Primary Bed 18 x 14
Primary Bath 16 x 8
1/2 Bath 5.5 x 5
Dining 15 x 11.5
Living Room 19.5 x 18
Kitchen 27.5 x 11.5
Laundry 8 x 6

2ND LEVEL

Bonus or Bed 17 x 12
Bath 8.5 x 8
Bed (back left) 15 x 12
Bath 8 x 6
Bed 12.5 x 11
Bed (far right) 14 x 11.5
Bath 9 x 5.5

Signature 
 Name Charles Skalet
 Date Signed _____
 State Certification # CR-2399 State TN
 Or State License # _____ State _____

Signature _____
 Name _____
 Date Signed _____
 State Certification # _____ State _____
 Or State License # _____ State _____

Building Sketch (Page - 1)

Borrower	N/A				
Property Address	1523 Bickerstaff Blvd				
City	Knoxville	County	Knox	State	TN
Lender/Client				Zip Code	37922

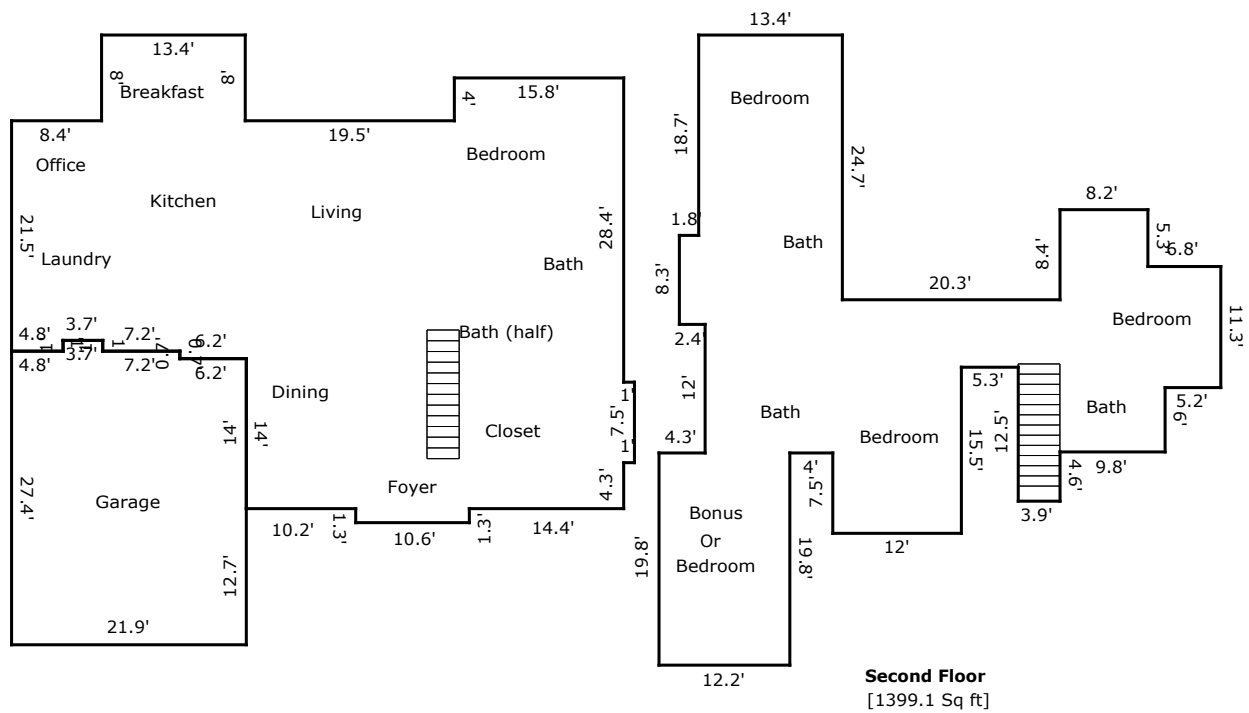

Second Floor
[1399.1 Sq ft]

TOTAL Sketch by a la mode

Building Sketch (Page - 2)

Borrower	N/A						
Property Address	1523 Bickerstaff Blvd						
City	Knoxville	County	Knox	State	TN	Zip Code	37922
Lender/Client							

TOTAL Sketch by a la mode

Area Calculations Summary

Living Area		Calculation Details
First Floor	1937.41 Sq ft	$7.5 \times 1 = 7.5$ $13.4 \times 8 = 107.2$ $10.6 \times 1.3 = 13.78$ $35.2 \times 14 = 492.8$ $26.2 \times 15.8 = 413.96$ $22.2 \times 25.6 = 568.32$ $15.7 \times 20.5 = 321.85$ $1 \times 7.2 = 7.2$ $1 \times 4.8 = 4.8$
Second Floor	1399.1 Sq ft	$12.2 \times 19.8 = 241.56$ $11.3 \times 5.2 = 58.76$ $17.3 \times 1.6 = 27.68$ $22.6 \times 8.2 = 185.32$ $18.8 \times 3.9 = 73.32$ $6.3 \times 5.3 = 33.39$ $21.8 \times 11.1 = 241.98$ $46.5 \times 0.9 = 41.85$ $39 \times 11.9 = 464.1$ $27 \times 0.6 = 16.2$ $8.3 \times 1.8 = 14.94$
Total Living Area (Rounded):	3337 Sq ft	
Non-living Area		
3 Car Attached	599.42 Sq ft	$3.7 \times 1 = 3.7$ $21.9 \times 26.7 = 584.73$ $15.7 \times 0.7 = 10.99$

Subject Photo Page

Borrower	N/A						
Property Address	1523 Bickerstaff Blvd						
City	Knoxville	County	Knox	State	TN	Zip Code	37922
Lender/Client							



Subject Front
1523 Bickerstaff Blvd



Subject Rear



Subject Street