

Supplemental Addendum

File No. 0056837

Borrower						
Property Address	2327 E Glenwood Ave					
City	Knoxville	County	Knox	State	TN	Zip Code 37917
Lender/Client	Tiffany Reid					

Measurements for 2327 E Glenwood Ave

1st Floor 840 sq ft

The Square Footage-Method for Calculating: ANSI® Z765-2021 (American National Standards Institute®) Measuring Standard for calculating gross living area (GLA), and non-GLA areas of the subject property, was utilized in creating the sketch for this measurement report.

Interior Rooms

Living	15 x 11.5
Kitchen	10 x 11.5
Dining	11.5 x 8
Laundry	12.5 x 7.5
Bath	4.5 x 7
Bed	11.5 x 11.5
Bed	11.5 x 8.5

Signature   
Name Charles Skalet  
Date Signed 11/16/2022  
State Certification # CR-2399 State TN  
Or State License #

Signature  
Name  
Date Signed  
State Certification # State  
Or State License # State

Building Sketch

Borrower					
Property Address 2327 E Glenwood Ave					
City	Knoxville	County	Knox	State	TN Zip Code 37917
Lender/Client Tiffany Reid					

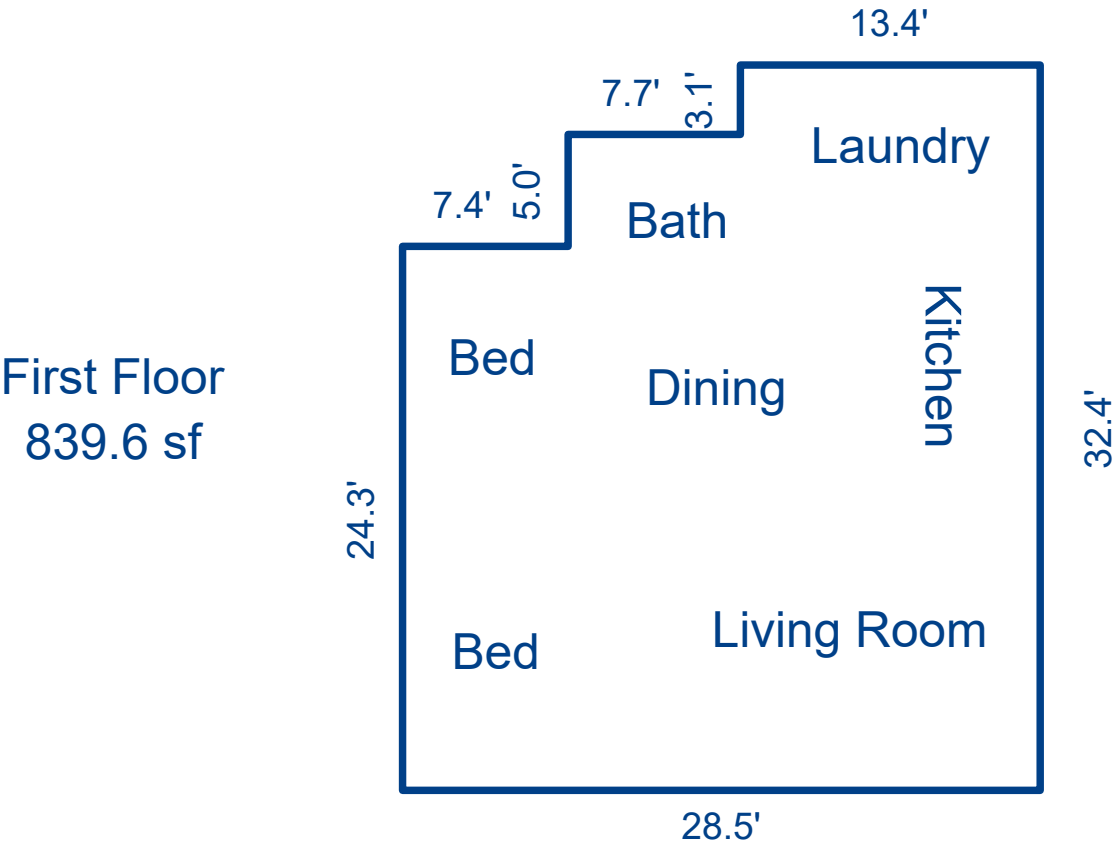

Sketch by Apex Sketch

AREA CALCULATIONS SUMMARY						AREA CALCULATIONS BREAKDOWN				
Code	Description	Factor	Net Size	Perimeter	Net Totals	Name	Base x	Height x	Width =	Area
GLA1	First Floor	1.0	839.6	121.8	839.6	First Floor		29.3 x	21.1 =	618.2
								24.3 x	7.4 =	179.8
								13.4 x	3.1 =	41.5

Subject Photo Page

Borrower					
Property Address 2327 E Glenwood Ave					
City	Knoxville	County	Knox	State	TN Zip Code 37917
Lender/Client Tiffany Reid					



Subject Front

Sales Price  
Gross Living Area  
Total Rooms  
Total Bedrooms  
Total Bathrooms  
Location  
View  
Site  
Quality  
Age

Subject Rear



Subject Street