



Supplemental Addendum

File No. 0056767

Borrower	Judy Teasley				
Property Address	9901 Westland Dr				
City	Knoxville	County	Knox	State	TN      Zip Code    37922
Lender/Client	Judy Teasley				

9901 Westland- 3392 sq ft

1st Level- 1153 sq ft

Living 24 x 13  
Dining 13 x 10  
Kitchen 13 x 11  
Breakfast 11 x 6  
Laundry 8 x 6  
Office 10 x 11  
Half Bath 5 x 5

2nd Level- 835 sq ft

Bed 1    12 x 12  
Bath 1    9 x 5  
Bed 2    12 x 10  
Bed 3    15 x 12  
Bath 2    9 x 10

Basement- 957 sq ft

Bed 4 12 x 11  
Bath 3    9 x 6  
Family 24 x 12  
Rec    14 x 9

Bonus Above Garage 30 x 12

Signature \_\_\_\_\_  
Name Jeremy Skalet  
Date Signed \_\_\_\_\_  
State Certification #    3215      State TN  
Or State License #      \_\_\_\_\_ State \_\_\_\_\_

Signature \_\_\_\_\_  
Name \_\_\_\_\_  
Date Signed \_\_\_\_\_  
State Certification #    \_\_\_\_\_ State \_\_\_\_\_  
Or State License #      \_\_\_\_\_ State \_\_\_\_\_

Building Sketch

Borrower	Judy Teasley					
Property Address	9901 Westland Dr					
City	Knoxville	County	Knox	State	TN	Zip Code 37922
Lender/Client	Judy Teasley					

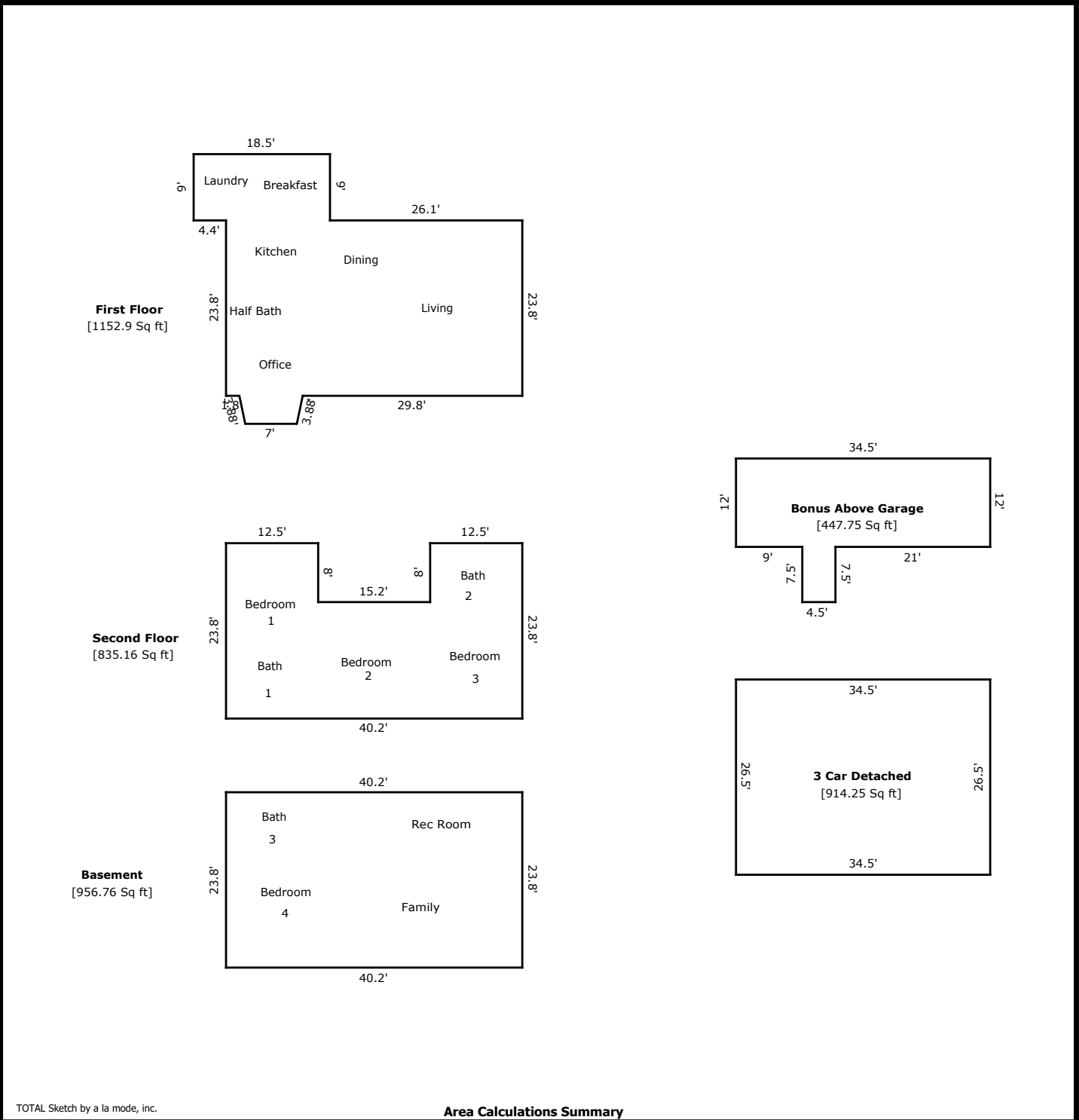

TOTAL Sketch by a la mode, inc.

Area Calculations Summary

Living Area		Calculation Details	
First Floor	1152.9 Sq ft	$0.5 \times 0.8 \times 3.8 =$	1.52
		$0.5 \times 3.8 \times 0.8 =$	1.52
		$7 \times 3.8 =$	26.6
		$18.5 \times 9 =$	166.5
		$40.2 \times 23.8 =$	956.76
Second Floor	835.16 Sq ft	$40.2 \times 15.8 =$	635.16
		$12.5 \times 8 =$	100
		$8 \times 12.5 =$	100
Basement	956.76 Sq ft	$40.2 \times 23.8 =$	956.76
Bonus Above Garage	447.75 Sq ft	$4.5 \times 7.5 =$	33.75
		$12 \times 34.5 =$	414
Total Living Area (Rounded):		3393 Sq ft	
Non-living Area			
3 Car Detached	914.25 Sq ft	$26.5 \times 34.5 =$	914.25

Subject Photo Page

Borrower	Judy Teasley					
Property Address	9901 Westland Dr					
City	Knoxville	County	Knox	State	TN	Zip Code 37922
Lender/Client	Judy Teasley					



Subject Front

9901 Westland Dr  
Sales Price  
Gross Living Area     3,393  
Total Rooms  
Total Bedrooms  
Total Bathrooms  
Location  
View  
Site  
Quality  
Age



Subject Rear



Garage