

Supplemental Addendum

File No. 0055916

Borrower/Client				
Property Address	12200 Brighton Ct			
City	Knoxville	County	State	TN Zip Code 37934
Lender	Rachael Wedekind			

Measurements of 12200 Brighton Ct

1st Floor 1982 square feet
2nd Floor 2235 square feet
Total 4217 sq ft

Interior Rooms

1st Level

Living Room 18.5 x 13.5
Dining Room 15.5 x 13.5
Eat in Kitchen 23.5 x 17 x irr
Great Room 23.5 x 17
Bed 14 x 11
Bath 7.5 x 5.5

2nd Level

Primary Bed 17 x 13.5
Primary Bath 13.5 x 9.5
Bedroom 14.5 x 13.5
Bedroom 14 x 13
Bath 10 x 8
Bonus Room 17.5 x 17.5
Bed 15.5 x 10.5
Bath 11 x 5



Signature _____
Name _____
Date Signed 07/08/2022
State Certification # CR-2399 State TN
Or State License # _____ State _____

Signature _____
Name _____
Date Signed _____
State Certification # _____ State _____
Or State License # _____ State _____

Subject Photo Page

Borrower/Client				
Property Address 12200 Brighton Ct				
City	Knoxville	County	State	TN Zip Code 37934
Lender Rachael Wedekind				



Subject Front

- Sales Price
- Gross Living Area
- Total Rooms
- Total Bedrooms
- Total Bathrooms
- Location
- View
- Site
- Quality
- Age

Subject Rear



Subject Street

Building Sketch

Borrower/Client				
Property Address 12200 Brighton Ct				
City	Knoxville	County	State	TN Zip Code 37934
Lender Rachael Wedekind				

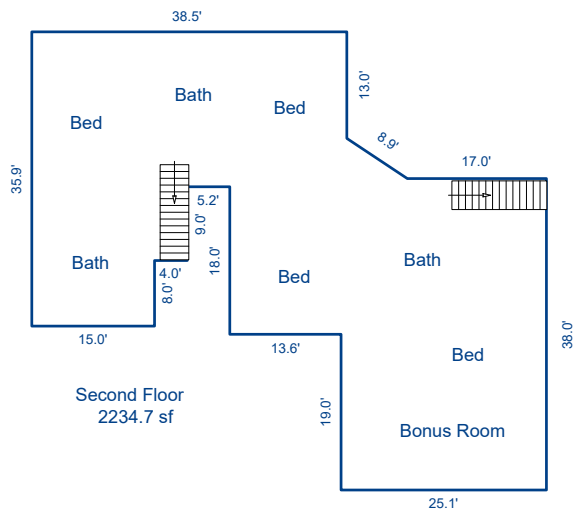
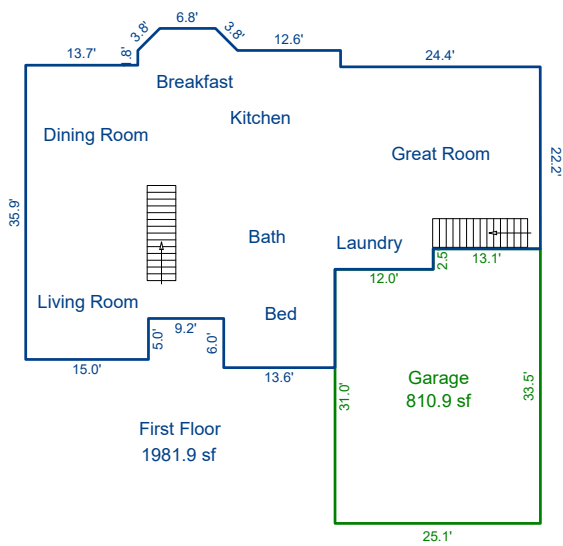

Sketch by Apex Sketch

AREA CALCULATIONS SUMMARY						AREA CALCULATIONS BREAKDOWN				
Code	Description	Factor	Net Size	Perimeter	Net Totals	Name	Base x	Height x	Width =	Area
GLA1	First Floor	1.0	1981.9	215.4	1981.9	First Floor	0.5 x	22.2 x	0.0 =	0.2
GLA2	Second Floor	1.0	2234.7	268.2	2234.7		35.9 x	15.0 =	538.5	
GAR	Garage	1.0	810.9	117.2	810.9		1.8 x	1.3 =	2.3	
							32.7 x	10.9 =	355.8	
							6.8 x	2.7 =	18.3	
							0.5 x	3.8 x	1.9 =	3.6
							0.5 x	3.8 x	1.9 =	3.6
							6.0 x	1.7 =	10.1	
							38.7 x	11.9 =	461.3	
							26.7 x	0.7 =	18.2	
							24.7 x	11.3 =	279.6	
							22.2 x	13.1 =	290.4	
							38.5 x	5.9 =	227.2	
							18.0 x	14.3 =	257.4	
						19.0 x	9.0 =	171.0		
						19.0 x	0.7 =	13.3		
	Net LIVABLE	cnt	2 (rounded)		4,217	4 addl items				
						20 total items			(rounded)	4,217