

Supplemental Addendum

File No.

Borrower	Sharon Bailey			
Property Address	9831 George Williams Rd			
City	Knoxville	County	State	TN Zip Code 37922
Lender/Client	Sharon Bailey			

9831 George Williams- 3137 sq ft

1st Level- 2077 sq ft

- Half Bath 4 x 4
- Laundry 8 x 5
- Breakfast 10 x 8
- Kitchen 14 x 12
- Dining 14 x 12
- Living 17 x 14
- Office 17 x 11
- Bath 2 13 x 5
- Bed 2 16 x 11
- Main Bed 16 x 13
- Main Bath 11 x 7

2nd Level- 1060 sq ft

- Bed 3 14 x 11
- Bath 3 11 x 11
- Bed 4 11 x 10
- Bed 5 14 x 14

Unfinished Basement- 1780 sq ft

Garage/Shop- 841 sq ft

Signature _____
Name Jeremy Skalet
Date Signed _____
State Certification # 3215 State TN
Or State License # _____ State _____

Signature _____
Name _____
Date Signed _____
State Certification # _____ State _____
Or State License # _____ State _____

Subject Photo Page

Borrower	Sharon Bailey				
Property Address	9831 George Williams Rd				
City	Knoxville	County	State	TN	Zip Code 37922
Lender/Client	Sharon Bailey				



Subject Front

9831 George Williams
Sales Price
Gross Living Area 3,137
Total Rooms
Total Bedrooms
Total Bathrooms
Location
View
Site
Quality
Age



Subject Rear



Garage/Shop

Building Sketch

Borrower	Sharon Bailey		
Property Address	9831 George Williams Rd		
City	Knoxville	County	State TN Zip Code 37922
Lender/Client	Sharon Bailey		

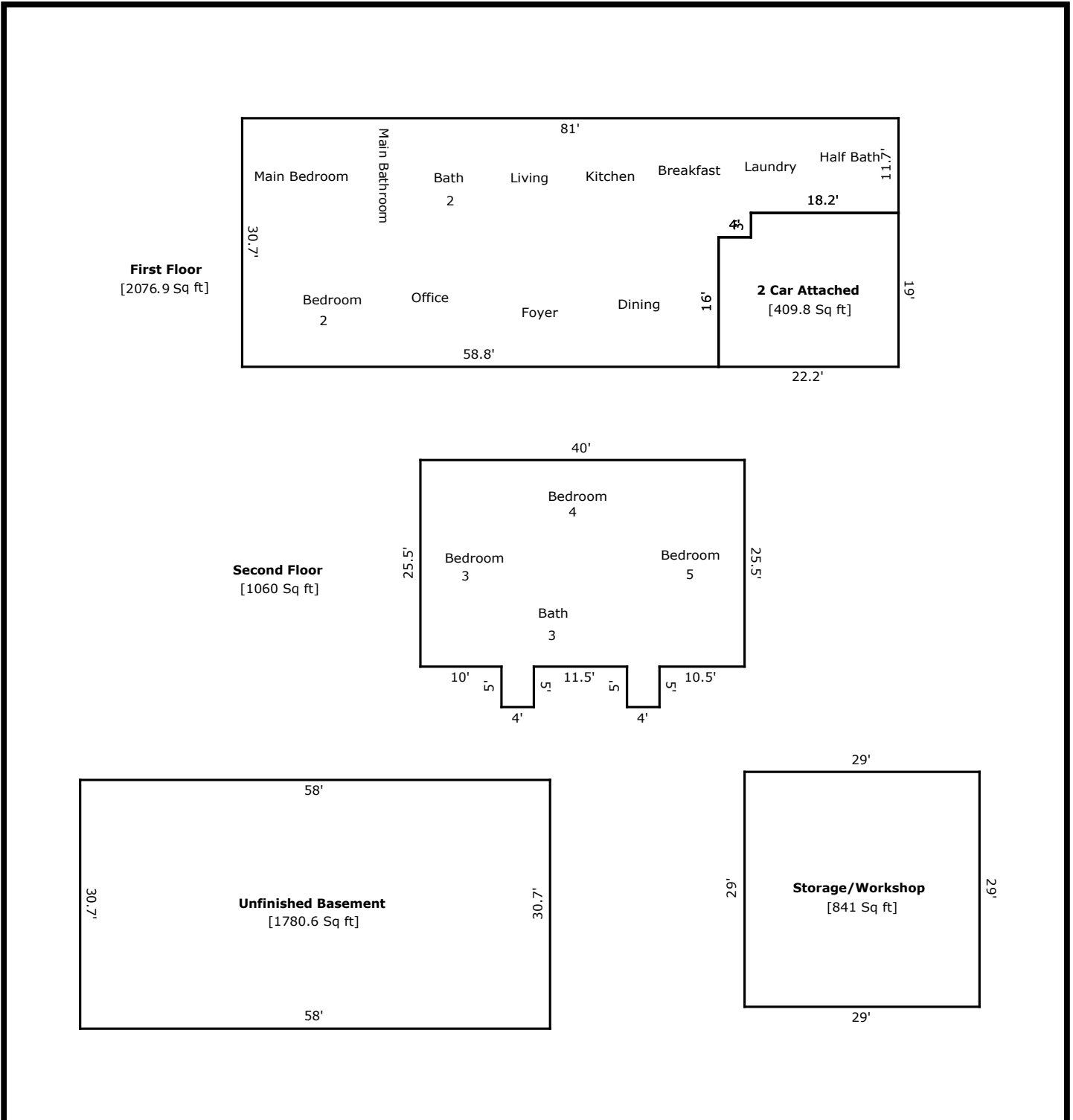

TOTAL Sketch by a la mode, inc.

Area Calculations Summary

Living Area	Calculation Details	
First Floor	2076.9 Sq ft	$11.7 \times 18.2 = 212.94$ $30.7 \times 58.8 = 1805.16$ $4 \times 14.7 = 58.8$
Second Floor	1060 Sq ft	$40 \times 25.5 = 1020$ $4 \times 5 = 20$ $4 \times 5 = 20$
Total Living Area (Rounded):	3137 Sq ft	
Non-living Area		
2 Car Attached	409.8 Sq ft	$19 \times 18.2 = 345.8$ $4 \times 16 = 64$
Unfinished Basement	1780.6 Sq ft	$58 \times 30.7 = 1780.6$
Storage/Workshop	841 Sq ft	$29 \times 29 = 841$