

Supplemental Addendum

File No. 0055098

|                                     |           |        |      |       |                   |
|-------------------------------------|-----------|--------|------|-------|-------------------|
| Borrower                            |           |        |      |       |                   |
| Property Address 313 Heathermoor Dr |           |        |      |       |                   |
| City                                | Knoxville | County | Knox | State | TN Zip Code 37934 |
| Lender/Client Debbie Holloway       |           |        |      |       |                   |

Measurements of 313 Heathermoor Dr

|           |            |
|-----------|------------|
| 1st Level | 2336 sq ft |
| 2nd Level | 1258 sq ft |
| Total     | 3593 sq ft |

The Square Footage-Method for Calculating: ANSI® Z765-2021 (American National Standards Institute®) Measuring Standard for calculating gross living area (GLA), and non-GLA areas of the subject property, was utilized in creating the sketch for this measurement report.

Interior Room Measurements

|             |                        |
|-------------|------------------------|
| 1st Level   |                        |
| Office      | 14.5 x 13              |
| Bedroom     | 19 x 14.5              |
| Bath        | 14..5 x 14 x irregular |
| Living Room | 20 x 17                |
| 1/2 Bath    | 6 x 5                  |
| Dining Room | 16 x 12.5              |
| Laundry     | 6 x 6                  |
| Kitchen     | 16 x 12.5              |
| Breakfast   | 11 x 10                |

|           |                       |
|-----------|-----------------------|
| 2nd Level |                       |
| Bonus/Bed | 26.5 x 15 x irregular |
| Bed       | 12.5 x 11.5           |
| Bath      | 11 x 6                |
| Bed       | 12 x 12               |
| Bath      | 8 x 5                 |

Signature 

Name Charles Skalet

Date Signed 04/14/2022

State Certification # CR-2399 State TN

Or State License # State

Signature \_\_\_\_\_

Name \_\_\_\_\_

Date Signed \_\_\_\_\_

State Certification # \_\_\_\_\_ State \_\_\_\_\_

Or State License # \_\_\_\_\_ State \_\_\_\_\_

Subject Photo Page

|                                     |           |        |      |       |                   |
|-------------------------------------|-----------|--------|------|-------|-------------------|
| Borrower                            |           |        |      |       |                   |
| Property Address 313 Heathermoor Dr |           |        |      |       |                   |
| City                                | Knoxville | County | Knox | State | TN Zip Code 37934 |
| Lender/Client Debbie Holloway       |           |        |      |       |                   |



Subject Front

Sales Price  
Gross Living Area  
Total Rooms  
Total Bedrooms  
Total Bathrooms  
Location  
View  
Site  
Quality  
Age

Subject Rear



Subject Street

Building Sketch

|                  |                    |        |      |       |    |                |
|------------------|--------------------|--------|------|-------|----|----------------|
| Borrower         |                    |        |      |       |    |                |
| Property Address | 313 Heathermoor Dr |        |      |       |    |                |
| City             | Knoxville          | County | Knox | State | TN | Zip Code 37934 |
| Lender/Client    | Debbie Holloway    |        |      |       |    |                |

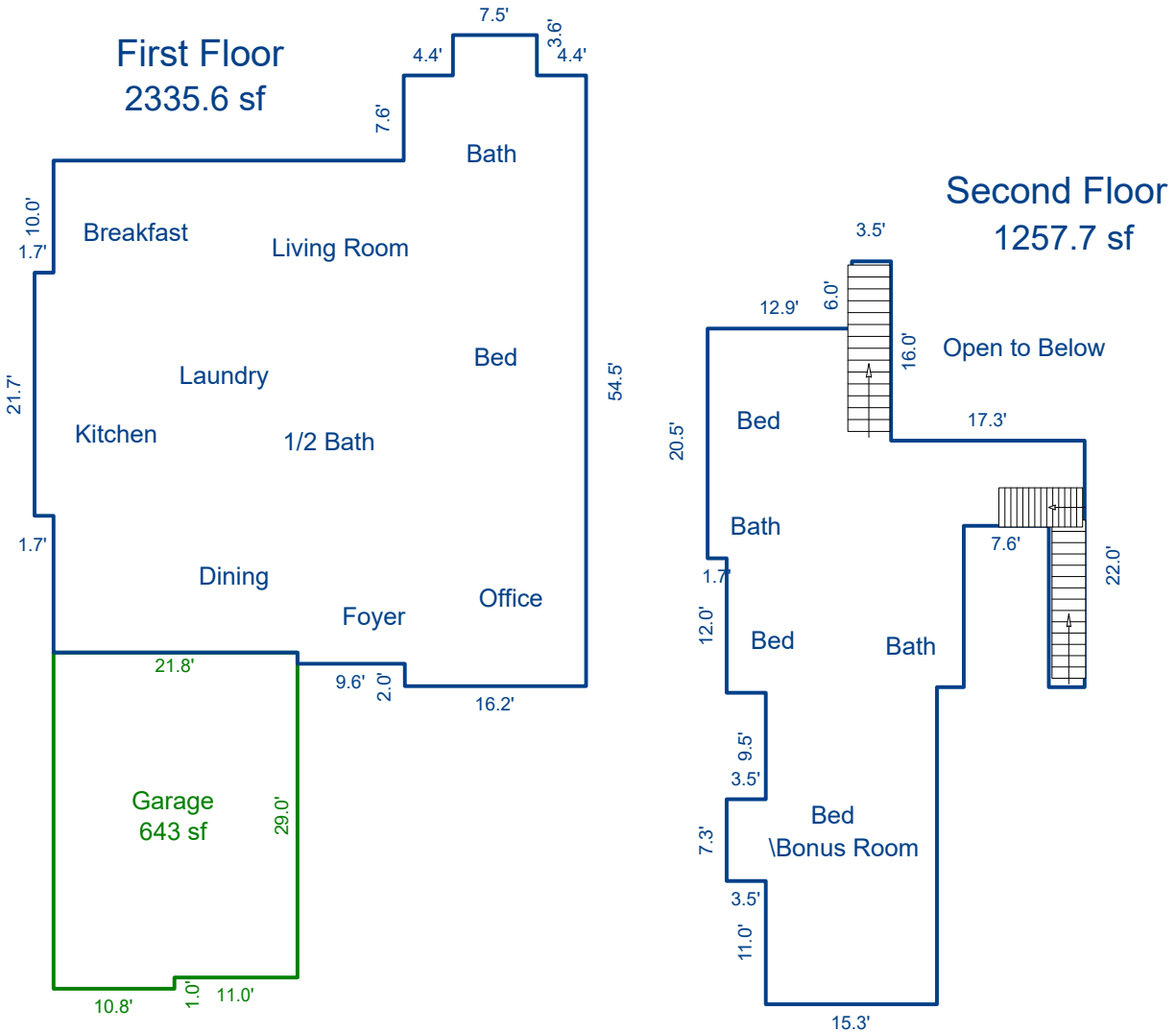

Sketch by Apex Sketch

| AREA CALCULATIONS SUMMARY |              |        |          |           |            | AREA CALCULATIONS BREAKDOWN |                |   |        |   |       |           |       |       |
|---------------------------|--------------|--------|----------|-----------|------------|-----------------------------|----------------|---|--------|---|-------|-----------|-------|-------|
| Code                      | Description  | Factor | Net Size | Perimeter | Net Totals | Name                        | Base           | x | Height | x | Width | =         | Area  |       |
| GLA1                      | First Floor  | 1.0    | 2335.6   | 214.8     | 2335.6     | First Floor                 |                |   | 7.5    | x | 3.6   | =         | 27.0  |       |
| GLA2                      | Second Floor | 1.0    | 1257.7   | 235.8     | 1257.7     |                             |                |   | 21.7   | x | 1.7   | =         | 36.9  |       |
| GAR                       | Garage       | 1.0    | 643.0    | 103.6     | 643.0      |                             |                |   | 54.5   | x | 16.2  | =         | 882.9 |       |
|                           |              |        |          |           |            | Second Floor                |                |   | 52.5   | x | 0.1   | =         | 5.2   |       |
|                           |              |        |          |           |            |                             |                |   | 44.9   | x | 9.5   | =         | 426.6 |       |
|                           |              |        |          |           |            |                             |                |   | 43.9   | x | 21.8  | =         | 957.0 |       |
|                           |              |        |          |           |            |                             |                |   | 7.3    | x | 3.5   | =         | 25.5  |       |
|                           |              |        |          |           |            |                             |                |   | 22.0   | x | 3.2   | =         | 70.4  |       |
|                           |              |        |          |           |            |                             |                |   | 23.6   | x | 3.5   | =         | 82.6  |       |
|                           |              |        |          |           |            |                             |                |   | 14.1   | x | 7.6   | =         | 107.2 |       |
|                           |              |        |          |           |            |                             |                |   | 17.6   | x | 12.9  | =         | 227.0 |       |
|                           |              |        |          |           |            |                             |                |   | 22.9   | x | 2.9   | =         | 66.4  |       |
|                           |              |        |          |           |            |                             |                |   | 21.2   | x | 11.5  | =         | 243.8 |       |
|                           |              |        |          |           |            |                             |                |   | 28.3   | x | 15.3  | =         | 433.0 |       |
|                           |              |        |          |           |            |                             |                |   | 3.5    | x | 0.5   | =         | 1.8   |       |
|                           | Net LIVABLE  | cnt    | 2        | (rounded) | 3,593      |                             | 15 total items |   |        |   |       | (rounded) |       | 3,593 |