



Supplemental Addendum

File No. 0054877

Borrower	The Holli McCray Group						
Property Address	4510 Holbert						
City	Knoxville	County	Knox	State	TN	Zip Code	37932
Lender/Client	The Holli McCray Group						

4510 Holbert Dr- 1020 sq ft

No one came to the door on the day of my scheduled appointment and therefore I could not get interior dimensions or room count.

Signature \_\_\_\_\_  
Name Jeremy Skalet  
Date Signed \_\_\_\_\_  
State Certification # 3215 State TN  
Or State License # \_\_\_\_\_ State \_\_\_\_\_

Signature \_\_\_\_\_  
Name \_\_\_\_\_  
Date Signed \_\_\_\_\_  
State Certification # \_\_\_\_\_ State \_\_\_\_\_  
Or State License # \_\_\_\_\_ State \_\_\_\_\_

Subject Photo Page

Borrower	The Holli McCray Group					
Property Address	4510 Holbert					
City	Knoxville	County	Knox	State	TN	Zip Code 37932
Lender/Client	The Holli McCray Group					



Subject Front

4510 Holbert  
Sales Price  
Gross Living Area 1,020  
Total Rooms  
Total Bedrooms  
Total Bathrooms  
Location  
View  
Site  
Quality  
Age



Subject Rear

Subject Street

Building Sketch

Borrower	The Holli McCray Group				
Property Address	4510 Holbert				
City	Knoxville	County	Knox	State	TN
Lender/Client	The Holli McCray Group				
				Zip Code	37932

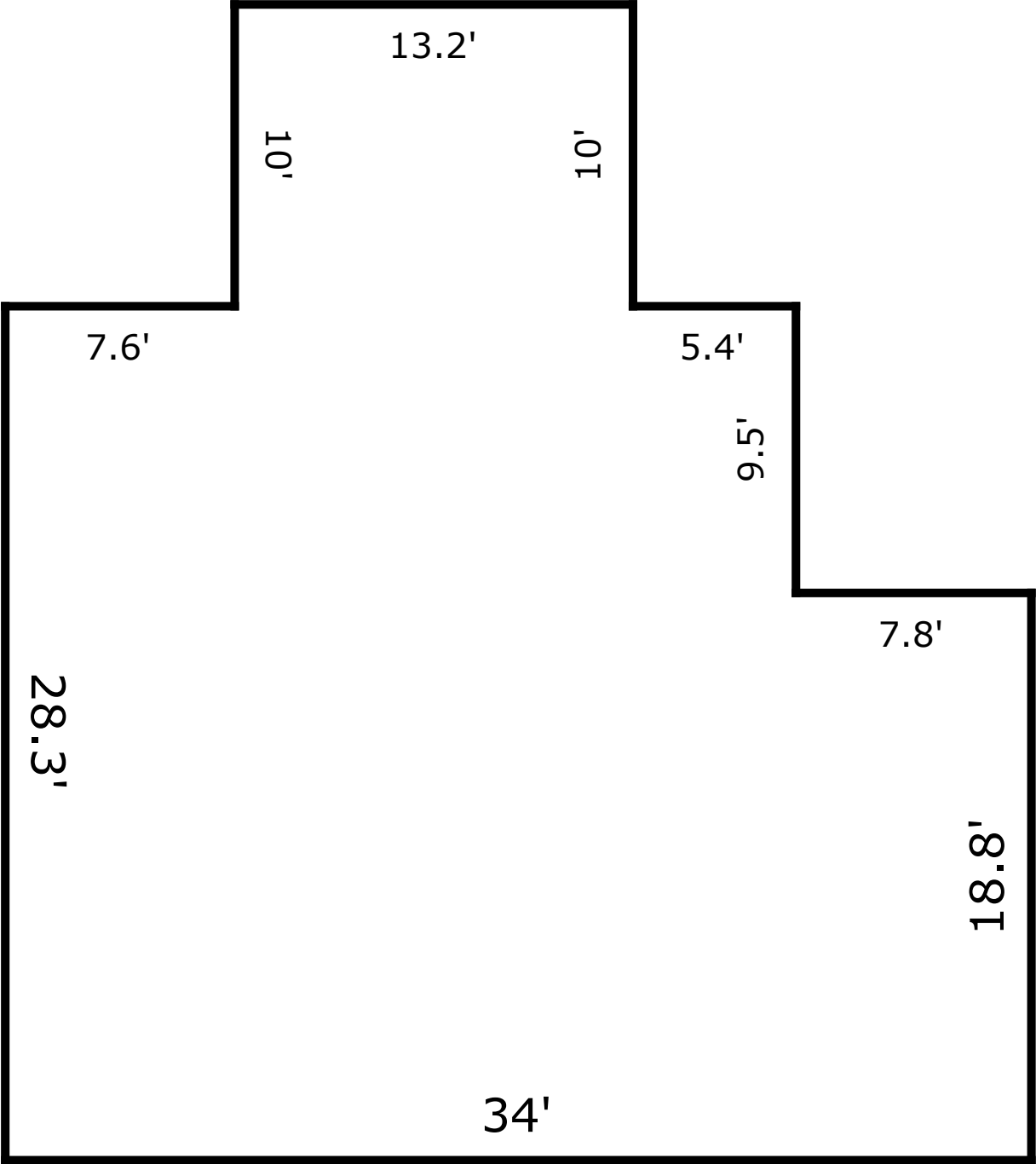

TOTAL Sketch by a la mode, inc.

Area Calculations Summary

Living Area		Calculation Details
First Floor	1020.1 Sq ft	<div>13.2 × 10 = 132</div> <div>28.3 × 26.2 = 741.46</div> <div>18.8 × 7.8 = 146.64</div>
Total Living Area (Rounded):		1020 Sq ft