



## Subject Photo Page

Borrower	The Holli McCray Group						
Property Address	424 Clover Fork Dr						
City	Knoxville	County	Knox	State	TN	Zip Code	37932
Lender/Client	The Holli McCray Group						



### Subject Front

424 Clover Fork Dr  
Sales Price  
Gross Living Area  
Total Rooms  
Total Bedrooms  
Total Bathrooms  
Location  
View  
Site  
Quality  
Age



### Subject Rear

### Subject Street

# Supplemental Addendum

File No. 0054426

Borrower	The Holli McCray Group		
Property Address	424 Clover Fork Dr		
City	Knoxville	County	Knox
		State	TN
		Zip Code	37932
Lender/Client	The Holli McCray Group		

**424 Clover Fork- 3459 sq ft**

**1st Level- 1792 sq ft**

- Office 18 x 12
- Dining 14 x 12
- Kitchen/Breakfast 18 x 14
- Half Bath 8 x 6
- Living 19 x 14
- Sun Room 19 x 12
- Laundry/Mud Room 15 x 7

**2nd Level- 1667 sq ft**

- Bonus 18 x 12
- Master Closet 21 x 6
- Master Bed 17 x 14
- Master Bath 17 x 10
- Bath 9 x 8
- Bed 2 12 x 11
- Bed 3 13 x 12
- Bed 4 13 x 13

Signature \_\_\_\_\_  
Name Jeremy Skalet  
Date Signed \_\_\_\_\_  
State Certification # 3215 State TN  
Or State License # \_\_\_\_\_ State \_\_\_\_\_

Signature \_\_\_\_\_  
Name \_\_\_\_\_  
Date Signed \_\_\_\_\_  
State Certification # \_\_\_\_\_ State \_\_\_\_\_  
Or State License # \_\_\_\_\_ State \_\_\_\_\_

## Building Sketch

Borrower	The Holli McCray Group				
Property Address	424 Clover Fork Dr				
City	Knoxville	County	Knox	State	TN
Lender/Client	The Holli McCray Group				
				Zip Code	37932

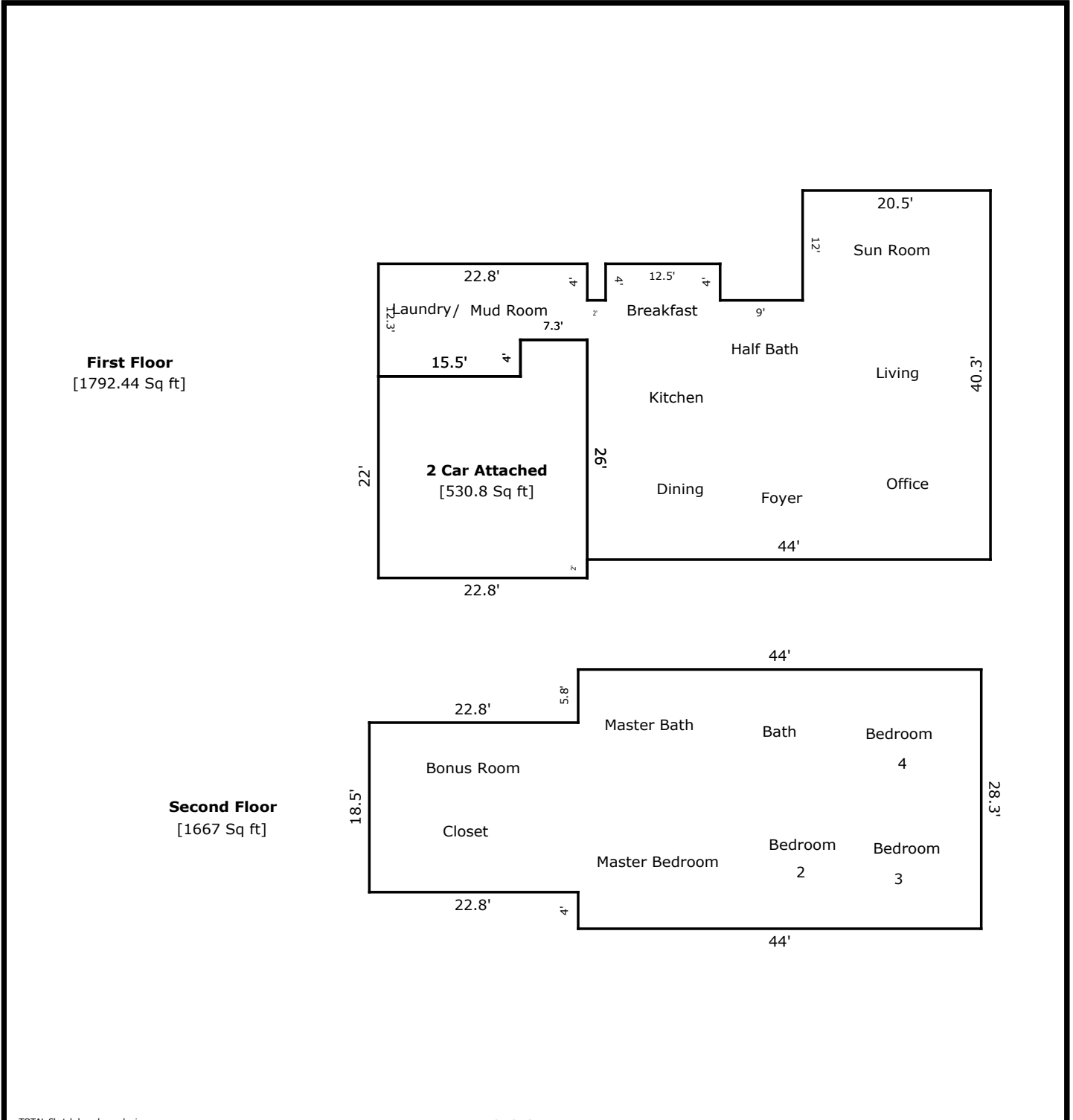

TOTAL Sketch by a la mode, inc.

### Area Calculations Summary

Living Area	Area	Calculation Details
First Floor	1792.44 Sq ft	$12.5 \times 4 = 50$ $12.3 \times 15.5 = 190.65$ $8.3 \times 7.3 = 60.59$ $28.3 \times 23.5 = 665.05$ $20.5 \times 40.3 = 826.15$
Second Floor	1667 Sq ft	$18.5 \times 22.8 = 421.8$ $44 \times 28.3 = 1245.2$
<b>Total Living Area (Rounded):</b>	<b>3459 Sq ft</b>	
<b>Non-living Area</b>		
2 Car Attached	530.8 Sq ft	$22.8 \times 22 = 501.6$ $4 \times 7.3 = 29.2$