

Subject Photo Page

Borrower	The Holli McCray Group					
Property Address	1022 Tea Olive Ln					
City	Knoxville	County	Knox	State	TN	Zip Code 37919
Lender/Client	The Holli McCray Group					



Subject Front

1022 Tea Olive Ln
Sales Price
Gross Living Area
Total Rooms
Total Bedrooms
Total Bathrooms
Location
View
Site
Quality
Age



Subject Rear

Subject Street

Supplemental Addendum

File No. 0052999

Borrower	The Holli McCray Group				
Property Address	1022 Tea Olive Ln				
City	Knoxville	County	Knox	State	TN Zip Code 37919
Lender/Client	The Holli McCray Group				

1022 Tea Olive- 3490 sq ft

1st Level- 1792 sq ft

- Dining 12 x 12
- Great Room 18 x 14
- Kitchen/Breakfast 18 x 16
- Half Bath 5 x 5
- Laundry 8 x 6
- Master Bed 17 x 14
- Master Bath 15x 11

2nd Level- 1698 sq ft

- Bed 2 13 x 11
- Bath 2 7 x 7
- Bed 3 14 x 12
- Bed 4 13 x 13
- Bonus 22 x 14
- Bath 3 8 x 8
- Bed 5 16 x 12

Signature _____
Name Jeremy Skalet
Date Signed _____
State Certification # 3215 State TN
Or State License # _____ State _____

Signature _____
Name _____
Date Signed _____
State Certification # _____ State _____
Or State License # _____ State _____

Building Sketch

Borrower	The Holli McCray Group					
Property Address	1022 Tea Olive Ln					
City	Knoxville	County	Knox	State	TN	Zip Code 37919
Lender/Client	The Holli McCray Group					

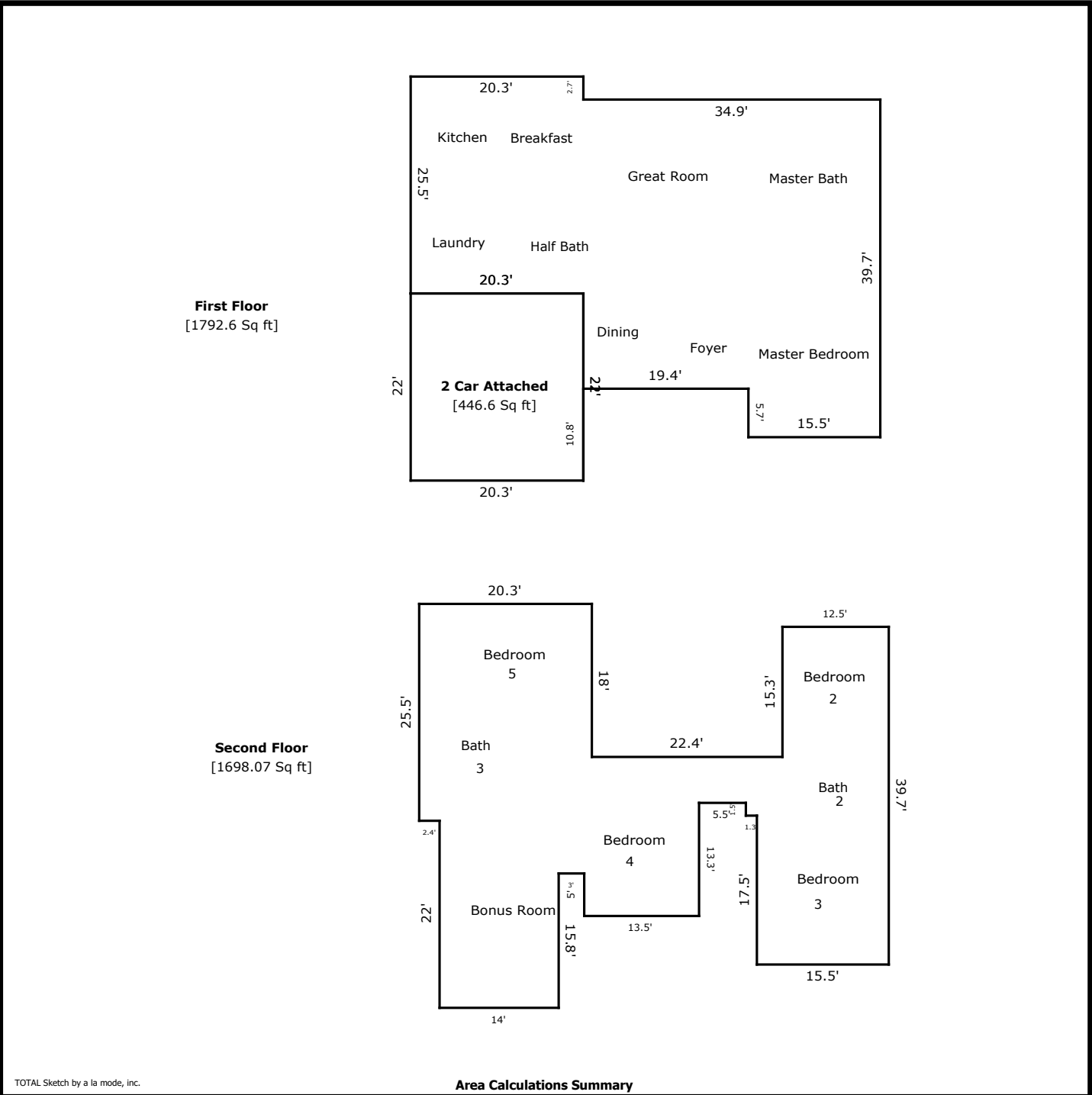

TOTAL Sketch by a la mode, inc.

Area Calculations Summary

Living Area		Calculation Details
First Floor	1792.6 Sq ft	<div>25.5 × 20.3= 517.65</div> <div>34.9 × 34 = 1186.6</div> <div>5.7 × 15.5 = 88.35</div>
Second Floor	1698.07 Sq ft	<div>20.3 × 18 = 365.4</div> <div>14 × 15.8 = 221.2</div> <div>15.5 × 17.5= 271.25</div> <div>12.5 × 15.3= 191.25</div> <div>6.9 × 16.8 = 115.92</div> <div>5.4 × 5.5 = 29.7</div> <div>18.7 × 13.5= 252.45</div> <div>13.7 × 17 = 232.9</div> <div>2.4 × 7.5 = 18</div>
Total Living Area (Rounded):		3491 Sq ft
Non-living Area		
2 Car Attached	446.6 Sq ft	<div>22 × 20.3 = 446.6</div>