

FROM:

Advanced Appraisal Services
PO Box 11373
Knoxville, TN 37939-1373

Telephone Number: (865) 588-4008 Fax Number:

T0:

Valarie Thompson

Telephone Number: (865) 719-5547 Fax Number:
Alternate Number: E-Mail: valariethompsonrealtor@gmail.com

INVOICE

INVOICE NUMBER

0052497

DATE

06/15/2021

REFERENCE

Internal Order #: 0052497
Lender Case #:
Client File #:
Main File # on form: 0052497
Other File # on form: 0052497
Federal Tax ID:
Employer ID:

DESCRIPTION

Lender: N/A Client: Valarie Thompson
Purchaser/Borrower: N/A
Property Address: 11807 Rebel Pass
City: Knoxville
County: Knox State: TN Zip: 37934
Legal Description: Block B Lot 29 Farragut Crossing Unit 2

FEESEAMOUNT

Measurement100.00

SUBTOTAL100.00

PAYMENTSEAMOUNT

Check #: Date: Description:
Check #: Date: Description:
Check #: Date: Description:

SUBTOTAL0.00

TOTAL DUE\$100.00

Supplemental Addendum

File No. 0052497

Borrower	N/A				
Property Address	11807 Rebel Pass				
City	Knoxville	County	Knox	State	TN Zip Code 37934
Lender/Client	N/A				

Measurements for 11807 Rebel Pass

1st Floor	1721 square feet
2nd Floor	1332 square feet
Garage	510 square feet

The above measurements are completed according to appraisal industry standards.

Subject Photo Page

Borrower	N/A					
Property Address	11807 Rebel Pass					
City	Knoxville	County	Knox	State	TN	Zip Code 37934
Lender/Client	N/A					



Subject Front



Subject Street

Building Sketch

Borrower	N/A						
Property Address	11807 Rebel Pass						
City	Knoxville	County	Knox	State	TN	Zip Code	37934
Lender/Client	N/A						

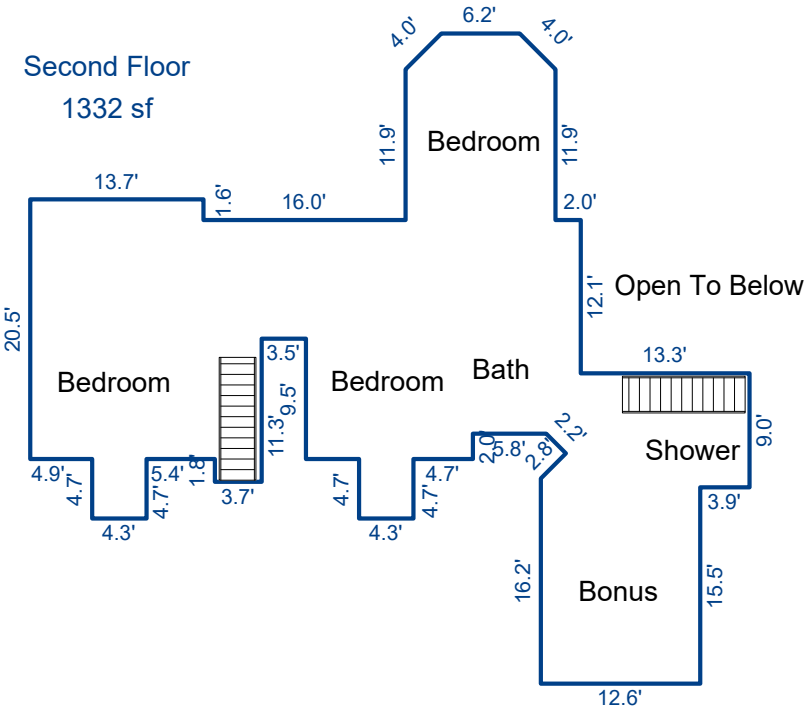
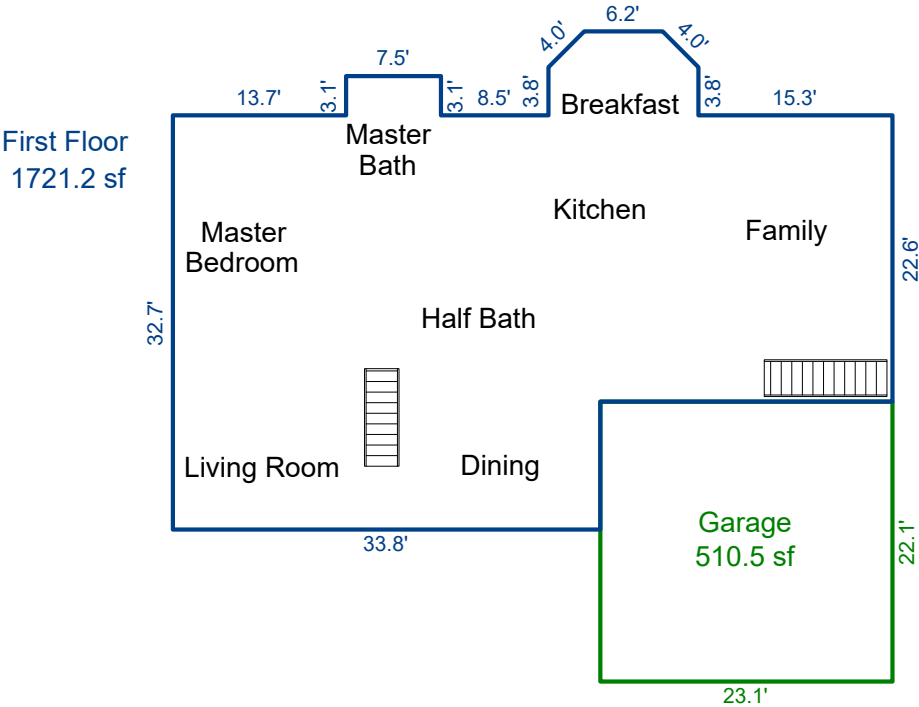

Sketch by Apex Sketch

AREA CALCULATIONS SUMMARY						AREA CALCULATIONS BREAKDOWN					
Code	Description	Factor	Net Size	Perimeter	Net Totals	Name	Base	x	Height	x	Width = Area
GLA1	First Floor	1.0	1721.2	195.3	1721.2	First Floor			7.5 x	3.1 =	23.3
GLA2	Second Floor	1.0	1332.0	263.7	1332.0				11.9 x	3.8 =	45.1
GAR	Garage	1.0	510.5	90.4	510.5				6.2 x	2.8 =	17.5
							0.5 x	4.0 x	2.0 =	4.0	
							0.5 x	4.0 x	2.0 =	4.0	
									33.8 x	32.7 =	1105.3
									23.1 x	22.6 =	522.1
						Second Floor			11.9 x	11.9 =	141.1
									6.2 x	2.8 =	17.5
							0.5 x	4.0 x	2.0 =	4.0	
							0.5 x	4.0 x	2.0 =	4.0	
									4.7 x	4.3 =	20.2
									4.7 x	4.3 =	20.2
									12.2 x	4.8 =	58.0
									9.1 x	3.5 =	32.0
							0.5 x	5.0 x	2.5 =	6.3	
	Net LIVABLE	cnt	2	(rounded)	3,053	10 addl items					
						26 total items				(rounded)	3,053