



Subject Photo Page

Borrower	The Holli McCray Group					
Property Address	2064 Eliza Glynne					
City	Knoxville	County	Knox	State	TN	Zip Code 37932
Lender/Client	The Holli McCray Group					



Subject Front

2064 Eliza Glynne  
Sales Price  
Gross Living Area  
Total Rooms  
Total Bedrooms  
Total Bathrooms  
Location  
View  
Site  
Quality  
Age



Subject Rear

Subject Street

Supplemental Addendum

File No. 0050933

Borrower	The Holli McCray Group						
Property Address	2064 Eliza Glynne						
City	Knoxville	County	Knox	State	TN	Zip Code	37932
Lender/Client	The Holli McCray Group						

2064 Eliza Glynne- 2852 sq ft

1st Level- 826 sq ft

Living 16 x 14  
Dining 10 x 10  
Kitchen 16 x 14  
Half Bath 4 x 6

2nd Level- 1217 sq ft

Bed 2 11 x 11  
Bath 2 9 x 4  
Bed 3 14 x 11  
Main Bed 16 x 13  
Main Bath 9 x 8  
Laundry 6 x 5  
Bed/Bonus 15 x 12

Basement- 808 sq ft

Bath 8 x 5  
Family 24 x 16  
Rec 15 x 12

Signature \_\_\_\_\_  
Name Jeremy Skalet  
Date Signed \_\_\_\_\_  
State Certification # 3215 State TN  
Or State License # \_\_\_\_\_ State \_\_\_\_\_

Signature \_\_\_\_\_  
Name \_\_\_\_\_  
Date Signed \_\_\_\_\_  
State Certification # \_\_\_\_\_ State \_\_\_\_\_  
Or State License # \_\_\_\_\_ State \_\_\_\_\_

Building Sketch

Borrower	The Holli McCray Group				
Property Address	2064 Eliza Glynne				
City	Knoxville	County	Knox	State	TN
Lender/Client	The Holli McCray Group				
				Zip Code	37932

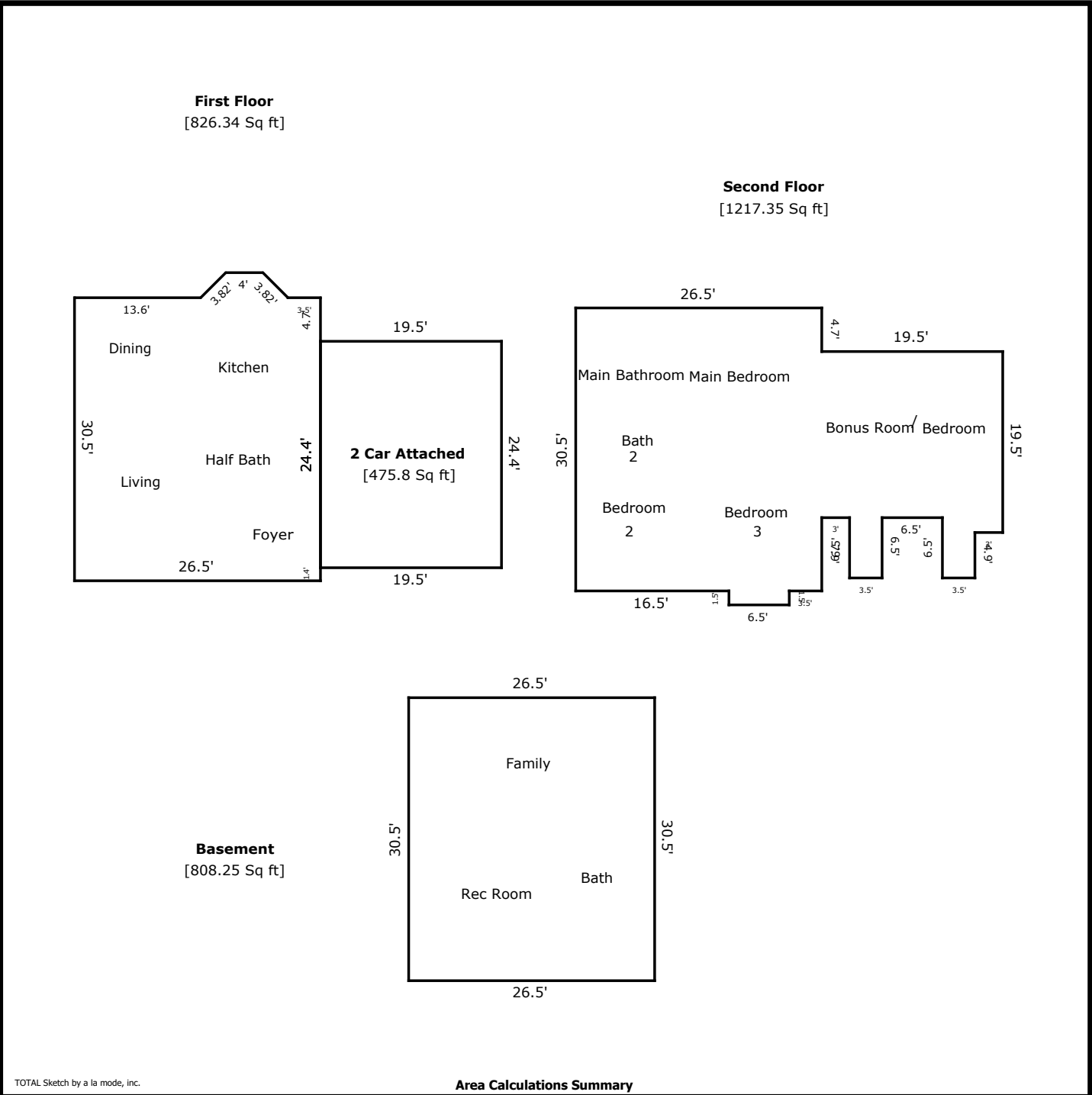

TOTAL Sketch by a la mode, inc.

Area Calculations Summary

Living Area		Calculation Details	
First Floor	826.34 Sq ft	$0.5 \times 2.7 \times 2.7 =$	3.64
		$0.5 \times 2.7 \times 2.7 =$	3.64
		$4 \times 2.7 =$	10.8
		$26.5 \times 30.5 =$	808.25
Second Floor	1217.35 Sq ft	$3.5 \times 6.5 =$	22.75
		$6.5 \times 1.5 =$	9.75
		$30.5 \times 26.5 =$	808.25
		$19.5 \times 17.9 =$	349.05
		$3.5 \times 4.9 =$	17.15
		$6.5 \times 1.6 =$	10.4
Basement	808.25 Sq ft	$30.5 \times 26.5 =$	808.25
Total Living Area (Rounded):		2852 Sq ft	
Non-living Area			
2 Car Attached	475.8 Sq ft	$19.5 \times 24.4 =$	475.8