

Supplemental Addendum

File No. 0050176

Borrower					
Property Address 12418 Hound Ears Pt					
City	Knoxville	County	Knox	State	TN
Lender/Client			Gina Johnson		
Zip Code 37934					

Measurements of 12418 Hound Ear Pt

1st Floor 1715 square feet
 2nd Floor 2119 square feet
 3rd Floor 237 square feet
 Finished Basement 1217 square feet

Interior Rooms

1st Level

Family Room 25 x 17
 Living Room 15 x 13
 Eat in Kitchen 21.5 x 13
 Dining Room 16 x 11.5
 Laundry 5 x 3.5

2nd Level

Main Bedroom 18 x 15
 Main Bath 12.5 x 8.5 x irr
 Bedroom 15.5 x 13.5 x irr
 Bedroom 15 x 12
 Bedroom 15 x 13
 Bath 9 x 4.5
 Bonus Room 22.5 x 21.5 x irr

3rd Level

Office 13.5 x 13

Basement

Office 12 x 12
 Rec Room 24.5 x 19.5
 Bedroom 13 x 12
 Bath 5.5 x 5

Signature 
 Name Charles Skalet
 Date Signed 09/10/2020
 State Certification # CR-2399 State TN
 Or State License # _____ State _____

Signature _____
 Name _____
 Date Signed _____
 State Certification # _____ State _____
 Or State License # _____ State _____

Subject Photo Page

Borrower				
Property Address	12418 Hound Ears Pt			
City	Knoxville	County	Knox	State TN Zip Code 37934
Lender/Client	Gina Johnson			



Subject Front

Sales Price
Gross Living Area
Total Rooms
Total Bedrooms
Total Bathrooms
Location
View
Site
Quality
Age



Subject Street

Building Sketch

Borrower				
Property Address 12418 Hound Ears Pt				
City	Knoxville	County	Knox	State TN Zip Code 37934
Lender/Client	Gina Johnson			

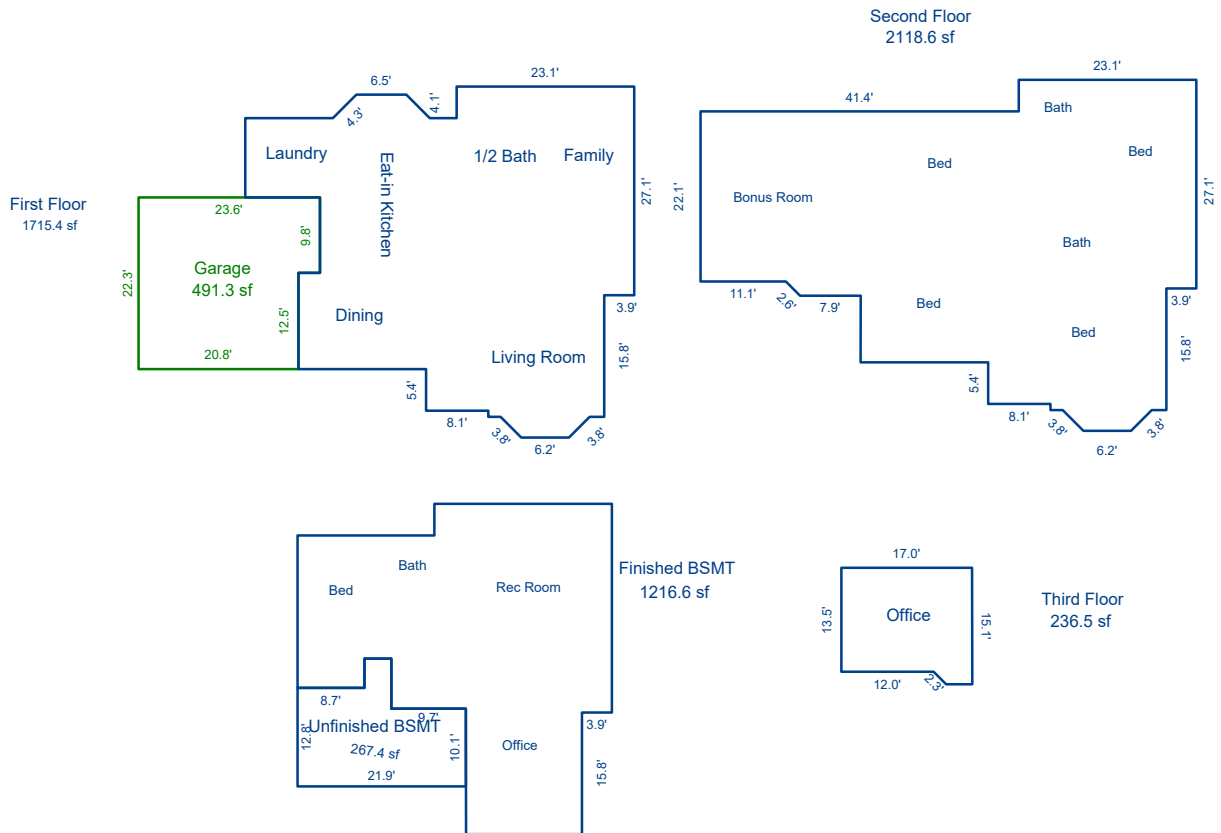

Sketch by Apex Sketch

AREA CALCULATIONS SUMMARY						AREA CALCULATIONS BREAKDOWN					
Code	Description	Factor	Net Size	Perimeter	Net Totals	Name	Base x	Height x	Width =	Area	
GLA1	First Floor	1.0	1715.4	197.4	1715.4	First Floor	8.9 x	6.2 x	=	55.1	
GLA2	Second Floor	1.0	2118.6	216.0	2118.6		0.5 x	3.8 x	1.9 =	3.6	
GLA3	Third Floor	1.0	236.5	63.3	236.5		6.2 x	2.7 =	16.7		
BSMT	Finished BSMT	1.0	1216.6	175.2	1484.1		6.2 x	1.6 =	9.9		
	Unfinished BSMT	1.0	267.4	77.0			0.5 x	3.8 x	1.9 =	3.6	
GAR	Garage	1.0	491.3	91.8	491.3		6.2 x	2.7 =	16.7		
							8.1 x	5.4 =	43.7		
							6.2 x	1.9 =	11.8		
							12.6 x	10.3 =	129.8		
							6.5 x	3.1 =	19.8		
							0.5 x	4.3 x	2.2 =	4.7	
							0.5 x	4.3 x	2.2 =	4.7	
							11.4 x	10.3 =	117.4		
							26.6 x	10.3 =	274.0		
						40.9 x	12.7 =	519.2			
23.1 x	4.1 =	94.7									
Net LIVABLE			cnt	3 (rounded)	4,071	20 addl items		(rounded)	4,071		
						36 total items					