

Supplemental Addendum

File No. 0048904

Borrower	The Holli McCray Group						
Property Address	7429 Bridgefield						
City	Powell	County	Knox	State	TN	Zip Code	37932
Lender/Client	The Holli McCray Group						

7429 Bridgefield- 2052 sq ft

1st Level- 1886 sq ft

- Living 18 x 15
- Dining 11 x 10
- Kitchen 13 x 11
- Breakfast 9 x 8
- Family 17 x 13
- Laundry 7 x 6
- Bath 8 x 8
- Bed 2 11 x 10
- Bed 3 14 x 12
- Main Bed 17 x 13
- Main Bath 9 x 5

Basement- 166 sq ft

Office 12 x 12

Signature _____
Name Jeremy Skalet
Date Signed _____
State Certification # 3215 State TN
Or State License # _____ State _____

Signature _____
Name _____
Date Signed _____
State Certification # _____ State _____
Or State License # _____ State _____

Subject Photo Page

Borrower	The Holli McCray Group					
Property Address	7429 Bridgefield					
City	Powell	County	Knox	State	TN	Zip Code 37932
Lender/Client	The Holli McCray Group					



Subject Front

7429 Bridgefield
Sales Price
Gross Living Area 2,052
Total Rooms
Total Bedrooms
Total Bathrooms
Location
View
Site
Quality
Age



Subject Rear

Subject Street

Building Sketch

Borrower	The Holli McCray Group						
Property Address	7429 Bridgefield						
City	Powell	County	Knox	State	TN	Zip Code	37932
Lender/Client	The Holli McCray Group						

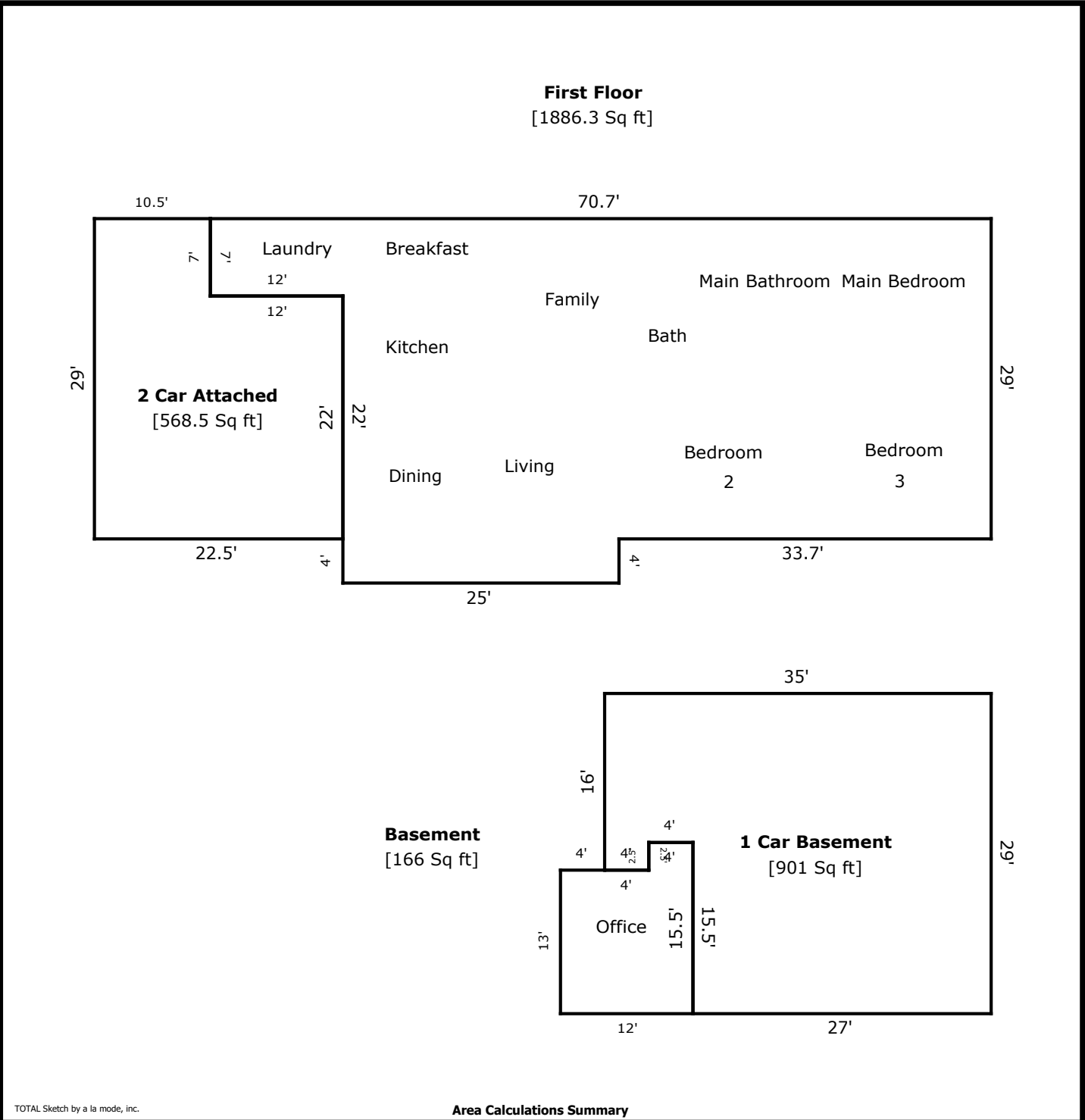

Living Area		Calculation Details	
First Floor	1886.3 Sq ft	$29 \times 33.7 =$	977.3
		$25 \times 26 =$	650
		$7 \times 37 =$	259
Basement	166 Sq ft	$12 \times 13 =$	156
		$2.5 \times 4 =$	10
Total Living Area (Rounded):		2052 Sq ft	
Non-living Area			
1 Car Basement	901 Sq ft	$29 \times 27 =$	783
		$4 \times 2.5 =$	10
		$8 \times 13.5 =$	108
2 Car Attached	568.5 Sq ft	$22.5 \times 22 =$	495
		$10.5 \times 7 =$	73.5