



Supplemental Addendum

File No. 0046621

Borrower	The Holli McCray Group						
Property Address	2528 Sable Point						
City	Knoxville	County	Knox	State	TN	Zip Code	37932
Lender/Client	The Holli McCray Group						

2528 Sable Point- 2077 sq ft

1st Level- 813 sq ft

Living 19 x 11  
Dining 12 x 10  
Kitchen 12 x 11  
Breakfast 9 x 9  
Half Bath 5 x 5

2nd Level- 1263 sq ft

Bonus 21 x 15  
Bed 2 11 x 10  
Bed 3 11 x 10  
Bath 11 x 5  
Master Bed 18 x 11  
Master Bath 10 x 8

Signature \_\_\_\_\_  
Name Jeremy Skalet  
Date Signed \_\_\_\_\_  
State Certification # 3215 State TN  
Or State License # \_\_\_\_\_ State \_\_\_\_\_

Signature \_\_\_\_\_  
Name \_\_\_\_\_  
Date Signed \_\_\_\_\_  
State Certification # \_\_\_\_\_ State \_\_\_\_\_  
Or State License # \_\_\_\_\_ State \_\_\_\_\_

Subject Photo Page

Borrower	The Holli McCray Group					
Property Address	2528 Sable Point					
City	Knoxville	County	Knox	State	TN	Zip Code 37932
Lender/Client	The Holli McCray Group					



Subject Front

2528 Sable Point



Subject Rear

Subject Street

Building Sketch

Borrower	The Holli McCray Group					
Property Address	2528 Sable Point					
City	Knoxville	County	Knox	State	TN	Zip Code 37932
Lender/Client	The Holli McCray Group					

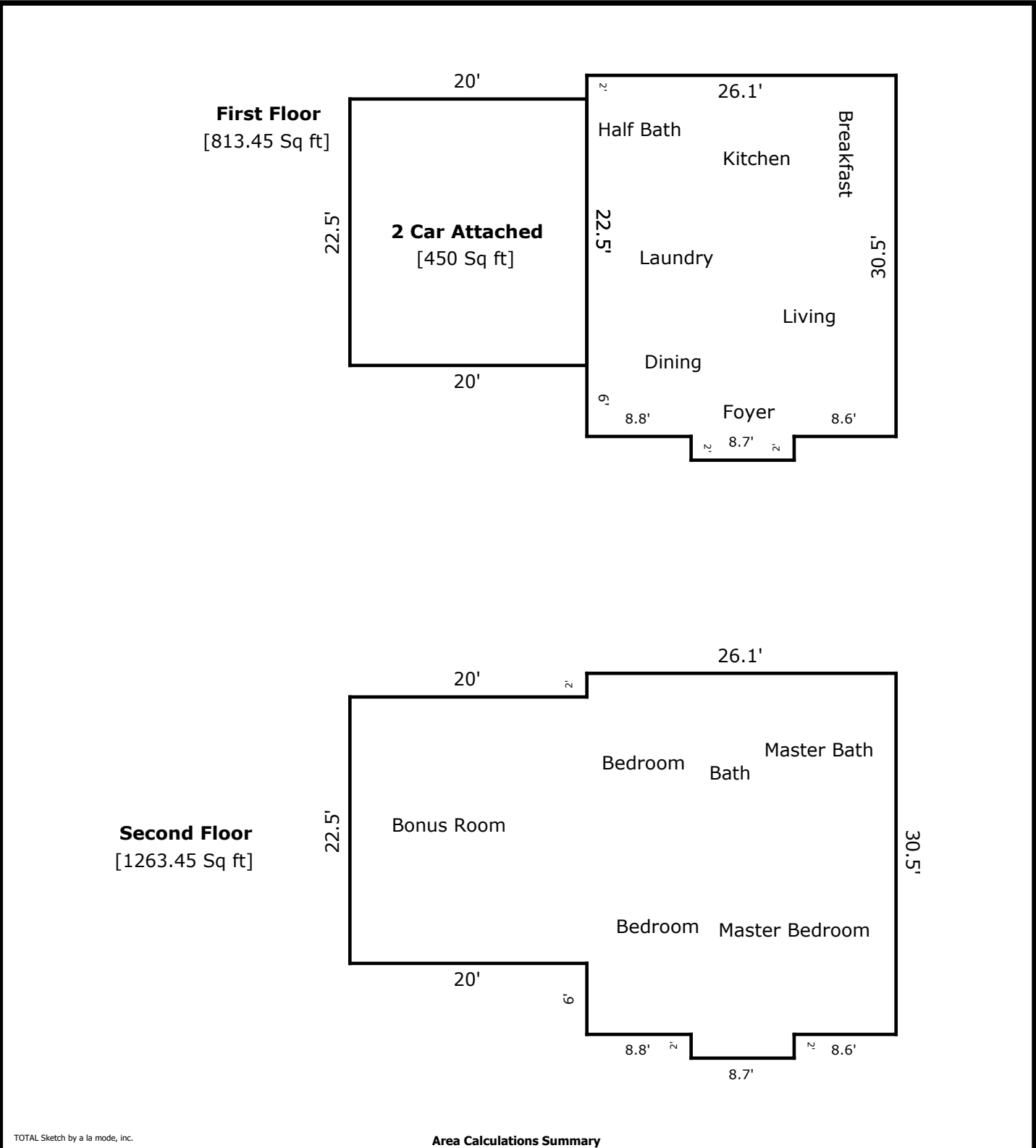

TOTAL Sketch by a la mode, inc.

Area Calculations Summary

Living Area		Calculation Details	
First Floor	813.45 Sq ft	$8.7 \times 2 = 17.4$	$26.1 \times 30.5 = 796.05$
Second Floor	1263.45 Sq ft	$8.7 \times 2 = 17.4$	$22.5 \times 20 = 450$
Total Living Area (Rounded):		2077 Sq ft	
Non-living Area			
2 Car Attached	450 Sq ft	$20 \times 22.5 =$	450