

Subject Photo Page

Borrower	The Holli McCray Group					
Property Address	15275 Fork Creek Rd					
City	Philadelphia	County	Loudon	State	TN	Zip Code 37932
Lender/Client	The Holli McCray Group					



Subject Front

15275 Fork Creek Rd
Sales Price
Gross Living Area
Total Rooms
Total Bedrooms
Total Bathrooms
Location
View
Site
Quality
Age 14

Subject Rear

Subject Street

Supplemental Addendum

File No. 0045961

Borrower	The Holli McCray Group				
Property Address	15275 Fork Creek Rd				
City	Philadelphia	County	Loudon	State	TN Zip Code 37932
Lender/Client	The Holli McCray Group				

15275 Fork Creek- 3832 sq ft

1st Level- 1440 sq ft

Living 23 x 14
Dining 15 x 11
Kitchen 15 x 11
Bath 12 x 10
Laundry 10 x 7
Bed 17 x 14

2nd Level- 952 sq ft

Master Bath 14 x 11
Master Bed 20 x 14
Bonus 26 x 14

Basement- 1440 sq ft

Rec 29 x 17
Bath 10 x 8
Bed 15 x 13
Family 24 x 14

Signature _____
Name Jeremy Skalet
Date Signed _____
State Certification # 3215 State TN
Or State License # _____ State _____

Signature _____
Name _____
Date Signed _____
State Certification # _____ State _____
Or State License # _____ State _____

Building Sketch

Borrower	The Holli McCray Group					
Property Address	15275 Fork Creek Rd					
City	Philadelphia	County	Loudon	State	TN	Zip Code 37932
Lender/Client	The Holli McCray Group					

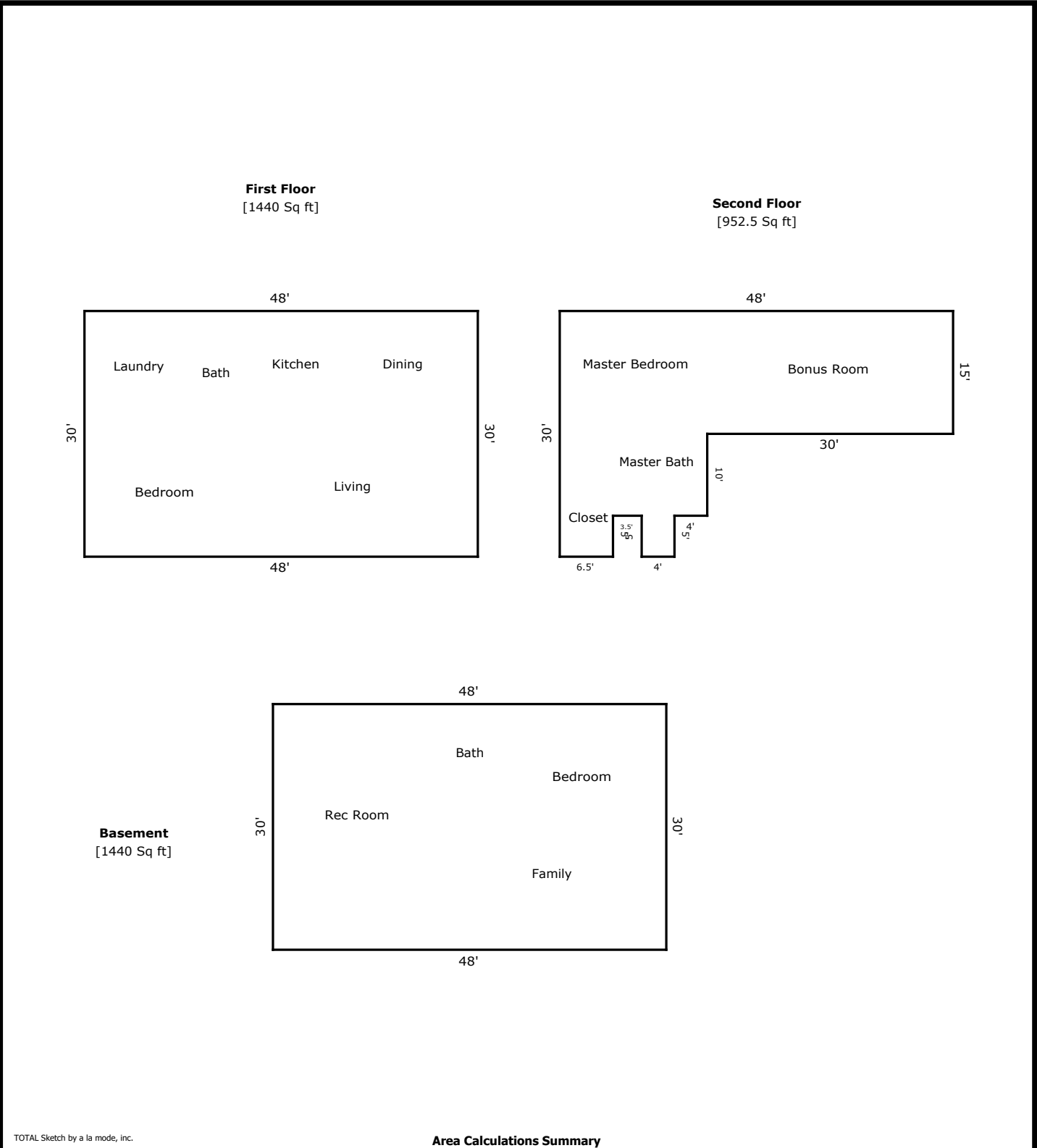

TOTAL Sketch by a la mode, inc.

Area Calculations Summary

Living Area		Calculation Details
First Floor	1440 Sq ft	30 × 48= 1440
Second Floor	952.5 Sq ft	4 × 5 = 20 6.5 × 5 = 32.5 25 × 18= 450 30 × 15= 450
Basement	1440 Sq ft	30 × 48= 1440
Total Living Area (Rounded):		3833 Sq ft