

FROM:

Telephone Number: (865) 588-4008 Fax Number: (865) 637-2394

0045037

Invoice Date: 07/09/2019

Due Date: 07/09/2019

Internal Order #: 0045037

Lender Case #:

Client File #:

FHA/VA Case #:

Main File # on form: 0045037

Other File # on form: 0045037

Federal Tax ID: 62-1867763

Employer ID:

Knoxville, TN

E-Mail: verdeaux@kw.com

Telephone Number: (865) 851-0181

Fax Number:

Alternate Number:

Lender: The Holli McCray Group

Purchaser/Borrower: The Holli McCray Group

Property Address: 6724 Timber Run

City: Knoxville

County: Knox

Legal Description: Lot 237 Sterchi Hills Unit 8

Client: The Holli McCray Group

AMOUNT

Measurement

75.00

Interior

0.00

SUBTOTAL

75.00

AMOUNT

Check #:

Date:

Description:

Check #:

Date:

Description:

Check #:

Date:

Description:

SUBTOTAL

0

TOTAL DUE

\$

75.00

Supplemental Addendum

File No. 0045037

Borrower	The Holli McCray Group				
Property Address	6724 Timber Run				
City	Knoxville	County	Knox	State	TN Zip Code 37932
Lender/Client	The Holli McCray Group				

6724 Timber Run- 2434 sq ft

1st Level- 951 sq ft

Office 11 x 11
Half Bath 6 x 3
Living 18 x 13
Kitchen/Breakfast 18 x 10
Dining 13 x 11

2nd Level- 1483 sq ft

Master Bed 17 x 14
Master Bath 15 x 11
Bed 2 12 x 11
Bed 3 12 x 11
Bath 11 x 6
Laundry 9 x 5
Bed 4 14 x 12
Bonus 14 x 15

Signature _____
Name Jeremy Skalet _____
Date Signed _____
State Certification # 3215 _____ State TN _____
Or State License # _____ State _____

Signature _____
Name _____
Date Signed _____
State Certification # _____ State _____
Or State License # _____ State _____

Subject Photo Page

Borrower	The Holli McCray Group					
Property Address	6724 Timber Run					
City	Knoxville	County	Knox	State	TN	Zip Code 37932
Lender/Client	The Holli McCray Group					



Subject Front

6724 Timber Run
Sales Price
Gross Living Area 2,434
Total Rooms
Total Bedrooms
Total Bathrooms
Location
View
Site
Quality
Age



Subject Rear

Subject Street

Building Sketch

Borrower	The Holli McCray Group					
Property Address	6724 Timber Run					
City	Knoxville	County	Knox	State	TN	Zip Code 37932
Lender/Client	The Holli McCray Group					

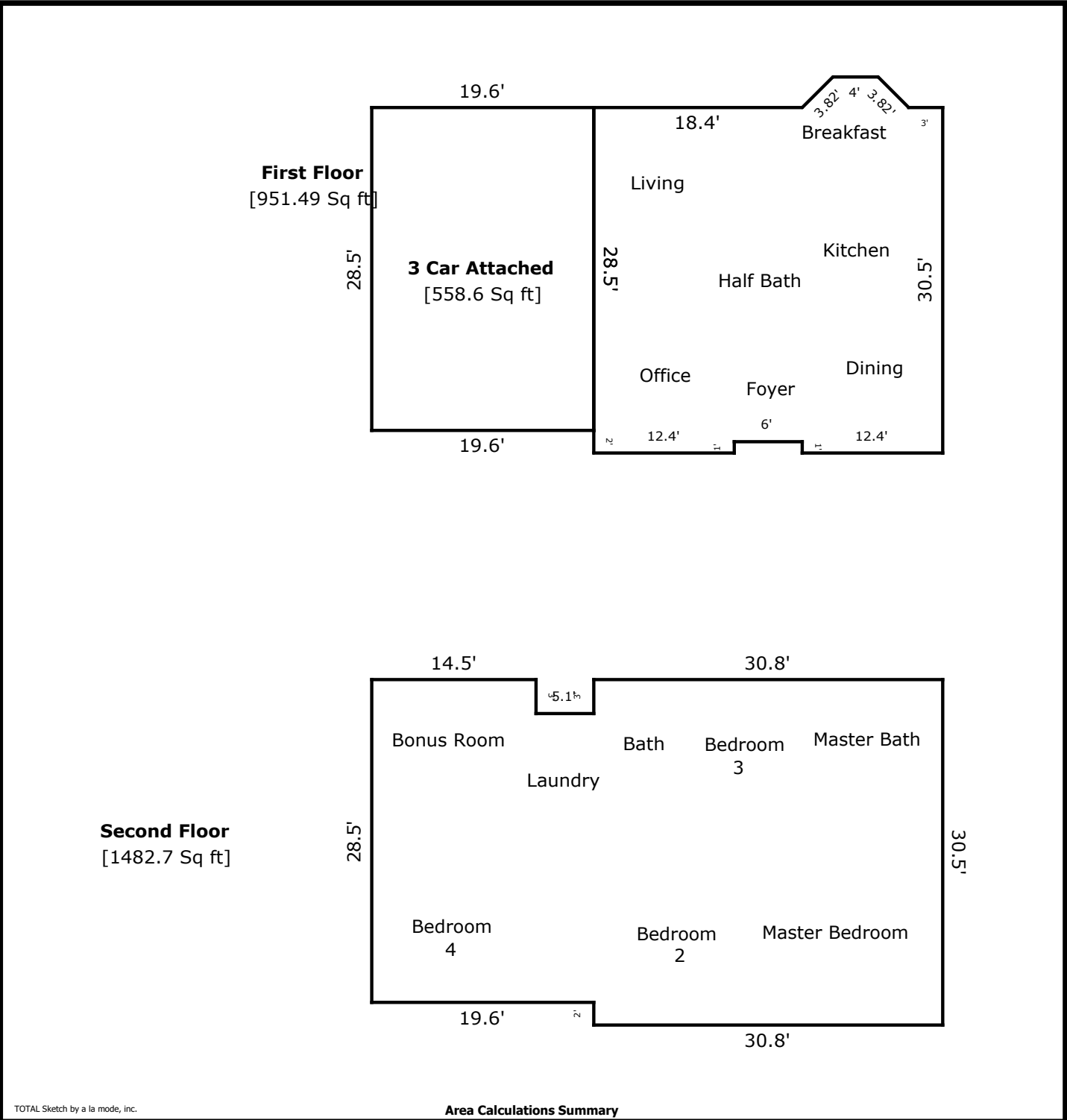

TOTAL Sketch by a la mode, inc.

Area Calculations Summary

Living Area		Calculation Details
First Floor	951.49 Sq ft	<div>0.5 × 2.7 × 2.7 = 3.64</div> <div>0.5 × 2.7 × 2.7 = 3.64</div> <div>4 × 2.7 = 10.8</div> <div>30.8 × 29.5 = 908.6</div> <div>12.4 × 1 = 12.4</div> <div>1 × 12.4 = 12.4</div>
Second Floor	1482.7 Sq ft	<div>30.5 × 30.8 = 939.4</div> <div>19.6 × 25.5 = 499.8</div> <div>14.5 × 3 = 43.5</div>
Total Living Area (Rounded):		2434 Sq ft
Non-living Area		
3 Car Attached	558.6 Sq ft	19.6 × 28.5 = 558.6