

FROM:

Telephone Number: (865) 588-4008 Fax Number: (865) 637-2394

0045292

Due Date: 08/02/2019

Employer ID:

Alternate Number:

Legal Description: Lot 6 Ivybridge S/D

75.00

0

75.00

Supplemental Addendum

File No. 0045292

Borrower	The Holli McCray Group					
Property Address	5615 Summer Grove					
City	Knoxville	County	Knox	State	TN	Zip Code 37932
Lender/Client	The Holli McCray Group					

5615 Summer Grove- 2149 sq ft

1st Level- 840 sq ft

Laundry 12 x 5
Kitchen/Breakfast 21 x 12
Dining 12 x 10
Living 18 x 13
Half Bath 6 x 4

2nd Level- 1309 sq ft

Master Bed 16 x 13
Master Bath 13 x 8
Bath 10 x 8
Bonus 20 x 13
Bed 2 11 x 11
Bed 3 11 x 11

Signature _____
Name Jeremy Skalet
Date Signed _____
State Certification # 3215 State TN
Or State License # _____ State _____

Signature _____
Name _____
Date Signed _____
State Certification # _____ State _____
Or State License # _____ State _____

Subject Photo Page

Borrower	The Holli McCray Group				
Property Address	5615 Summer Grove				
City	Knoxville	County	Knox	State	TN Zip Code 37932
Lender/Client	The Holli McCray Group				



Subject Front

5615 Summer Grove

2,149



Subject Rear

Subject Street

Building Sketch

Borrower	The Holli McCray Group				
Property Address	5615 Summer Grove				
City	Knoxville	County	Knox	State	TN
Lender/Client	The Holli McCray Group				
				Zip Code	37932

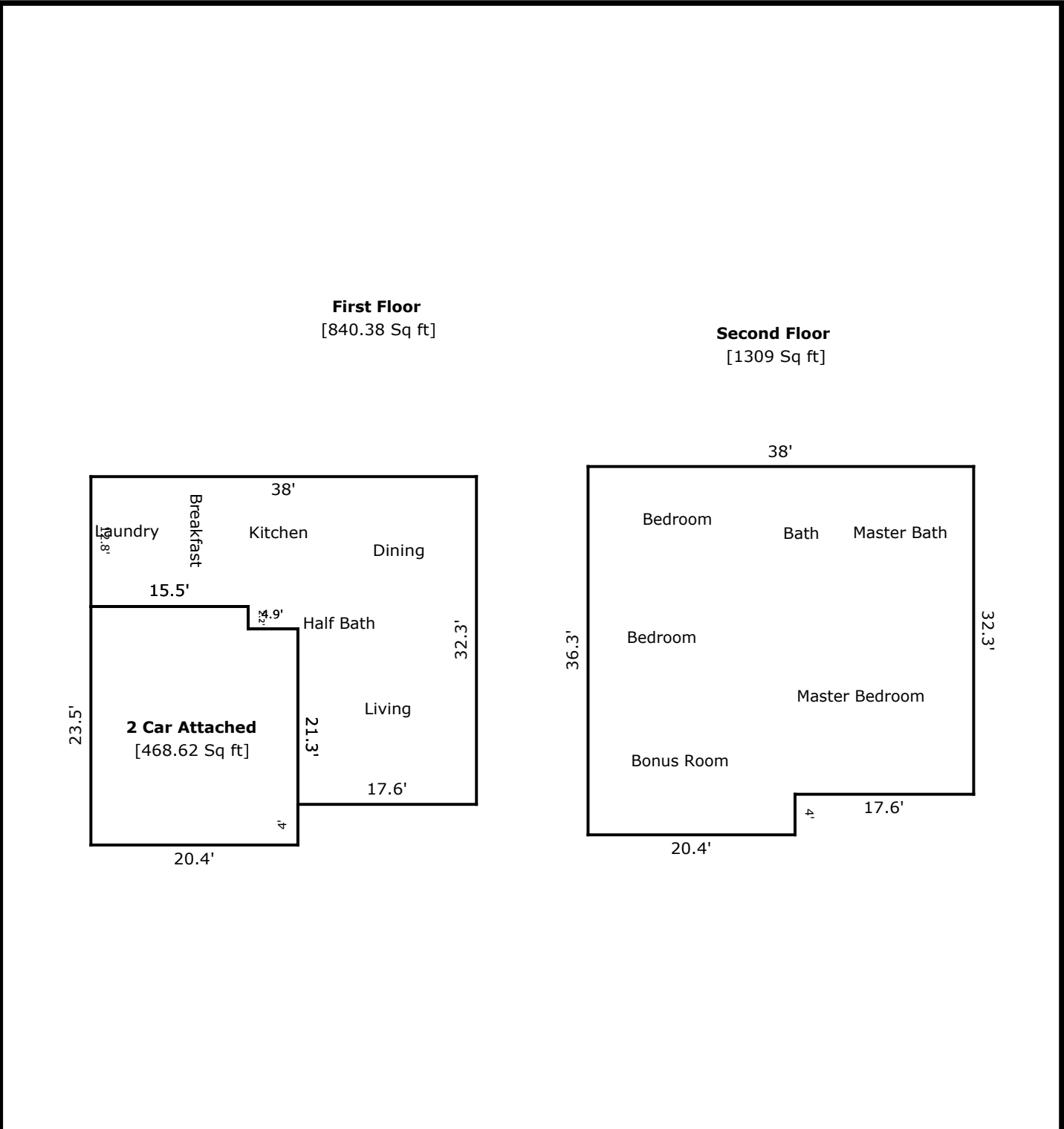

TOTAL Sketch by a la mode, inc.

Area Calculations Summary

Living Area		Calculation Details
First Floor	840.38 Sq ft	17.6 × 17.3= 304.48 12.8 × 15.5= 198.4 22.5 × 15 = 337.5
Second Floor	1309 Sq ft	38 × 32.3 = 1227.4 4 × 20.4 = 81.6
Total Living Area (Rounded):		2149 Sq ft
Non-living Area		
2 Car Attached	468.62 Sq ft	20.4 × 21.3= 434.52 2.2 × 15.5 = 34.1