

Photograph Addendum

Borrower	John Verdeaux						
Property Address	500 Miller Rd						
City	Clinton	County	Anderson	State	TN	Zip Code	37716
Lender/Client	The Holli McCray Group						



502b Miller Rd Front



502b Miller Rd Side/Rear



502 Miller Rd Front



502 Miller Rd Rear



Barn Side



Barn Front

Photograph Addendum

Borrower	John Verdeaux						
Property Address	500 Miller Rd						
City	Clinton	County	Anderson	State	TN	Zip Code	37716
Lender/Client	The Holli McCray Group						



Barn Rear



Barn Interior



Street



Street

Building Sketch

Borrower	John Verdeaux		
Property Address	500 Miller Rd		
City	Clinton	County	Anderson
		State	TN
		Zip Code	37716
Lender/Client	The Holli McCray Group		

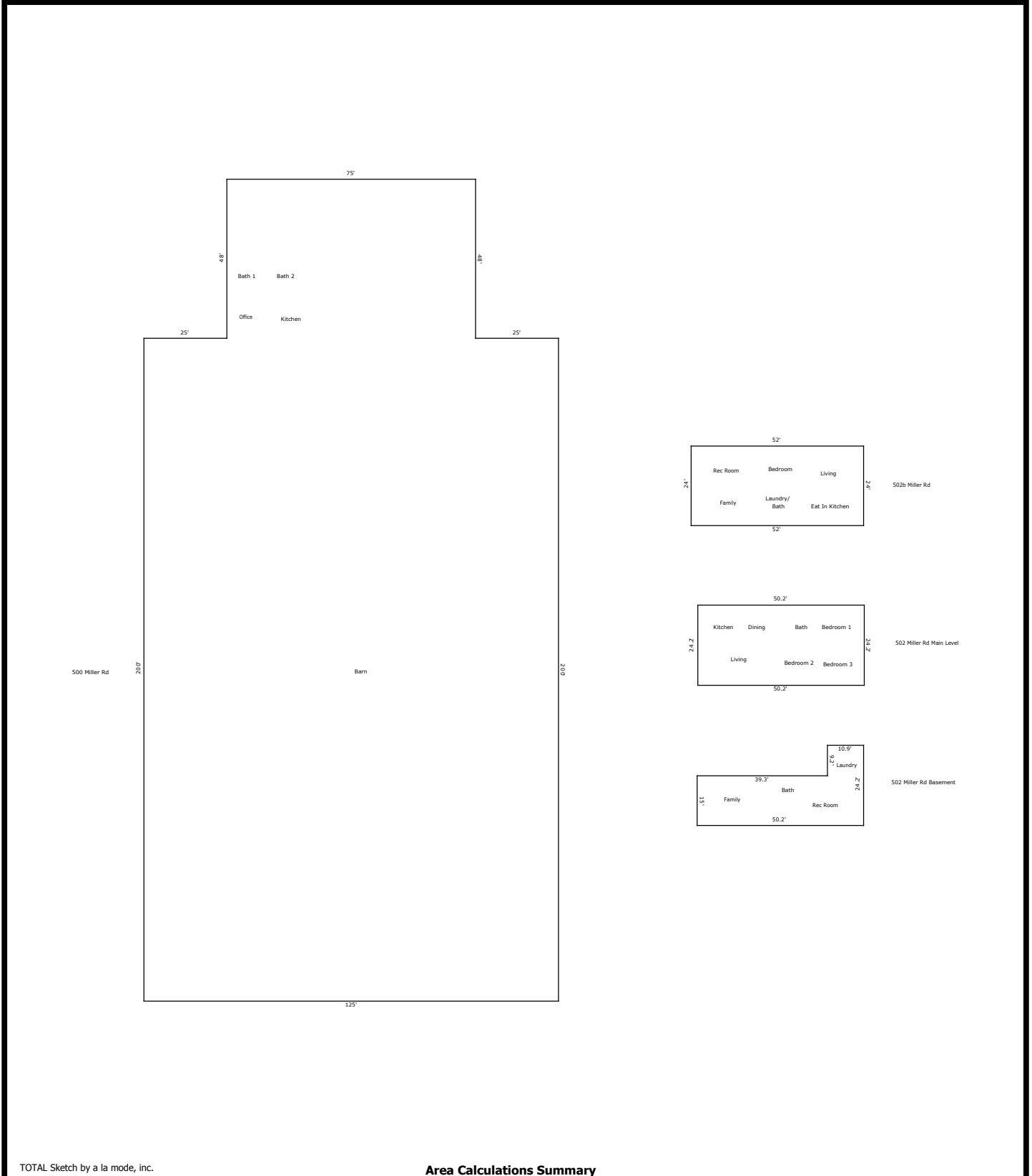

TOTAL Sketch by a la mode, inc.

Area Calculations Summary

Living Area		Calculation Details
502b Miller Rd	1248 Sq ft	24 × 52 = 1248
502 Miller Main Level	1214.84 Sq ft	24.2 × 50.2 = 1214.84
502 Miller Basement	853.28 Sq ft	10.9 × 9.2 = 100.28 50.2 × 15 = 753
Total Living Area (Rounded):	3316 Sq ft	
Non-living Area		
Barn (500 Miller Rd)	28600 Sq ft	125 × 200 = 25000 48 × 75 = 3600

Supplemental Addendum

File No. 0044647

Borrower	John Verdeaux				
Property Address	500 Miller Rd				
City	Clinton	County	Anderson	State	TN
Lender/Client	The Holli McCray Group				
				Zip Code	37716

Measurements for 502 Miller Rd**1st Floors - 1,215 sf****Basement - 853 sf****GLA - 2,068 square feet****Dimensions****Living - 20.5 x 13.5****Kitchen - 15 x 9.5****Dining - 9.5 x 5.5****Bath - 8 x 7.5****Bedroom 1 - 11 x 14 x irr****Bedroom 2 - 12 x 13****Bedroom 3 - 11.5 x 9.5****Family - 23.5 x 10****Rec Room - 17.5 x 11****Basement Bath - 4 x 6.5****Laundry - 10 x 8.5****Measurements for 502b Miller Rd****1st Floors - 1,248 sf****GLA - 1,248 square feet****Dimensions****Living - 14 x 10.5****Eat-in Kitchen - 11 x 8.5****Laundry/Bath - 7.5 x 11****Bedroom - 10.5 x 12****Family - 27 x 12****Rec Room - 10 x 20****TOTAL GLA - 3,316 square feet****Measurements for Barn****TOTAL GBA - 28,600 square feet****Office - 12 x 14.5****Kitchen - 13 x 12.5****Bath 1 - 8 x 8****Bath 2 - 8 x 7.5****The above measurements are completed according to appraisal industry standards.**