

# INVOICE

**FROM:**

Advanced Appraisal Services  
 Advanced Appraisal Services  
 PO Box 11373  
 Knoxville, TN 37939-1373

Telephone Number: (865) 588-4008      Fax Number: (865) 637-2394

**TO:**

Tiffany Dorn

E-Mail: tiffany@dornere.com

Telephone Number:

Fax Number:

Alternate Number:

**INVOICE NUMBER**

0044256

**DATES**

Invoice Date: 04/11/2019

Due Date:

**REFERENCE**

Internal Order #: 0044256

Lender Case #:

Client File #:

FHA/VA Case #:

Main File # on form: 0044256

Other File # on form: 0044256

Federal Tax ID: 62-1867763

Employer ID:

**DESCRIPTION**

Lender:	N/A	Client:	Tiffany Dorn		
Purchaser/Borrower:	N/A				
Property Address:	1733 Bonnie Roach Ln				
City:	Knoxville				
County:	Knox	State:	TN	Zip:	37922
Legal Description:	Lot 25 Arbor Gate S/D				

**FEES**

**AMOUNT**

Measure	75.00
---------	-------

<b>SUBTOTAL</b>	75.00
-----------------	-------

**PAYMENTS**

**AMOUNT**

Check #:	Date:	Description:	
Check #:	Date:	Description:	
Check #:	Date:	Description:	

<b>SUBTOTAL</b>	0
-----------------	---

<b>TOTAL DUE</b>	<b>\$ 75.00</b>
------------------	-----------------

### Subject Photo Page

Borrower	N/A				
Property Address	1733 Bonnie Roach Ln				
City	Knoxville	County	Knox	State	TN      Zip Code 37922
Lender/Client	Tiffany Dorn				



**Subject Street**



**Subject Front**

**Supplemental Addendum**

File No. 0044256

Borrower	N/A						
Property Address	1733 Bonnie Roach Ln						
City	Knoxville	County	Knox	State	TN	Zip Code	37922
Lender/Client	Tiffany Dorn						

**Measurements for 1733 Bonnie Roach Ln****1st Floor**                      **1494 square feet****2nd Floor**                      **840 square feet****Garage**                         **449 square feet**

The above measurements are completed according to appraisal industry standards.

### Building Sketch

Borrower	N/A				
Property Address	1733 Bonnie Roach Ln				
City	Knoxville	County	Knox	State	TN
Lender/Client	Tiffany Dorn				
				Zip Code	37922

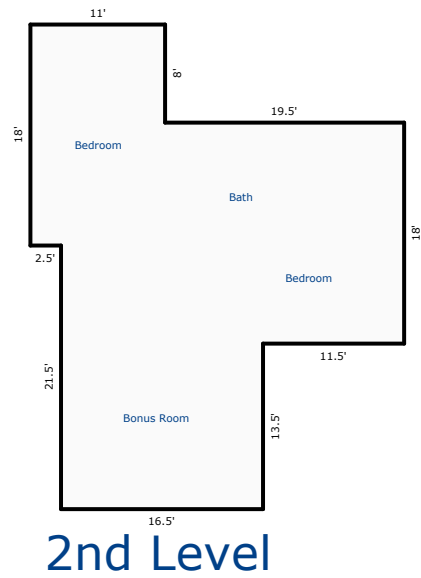
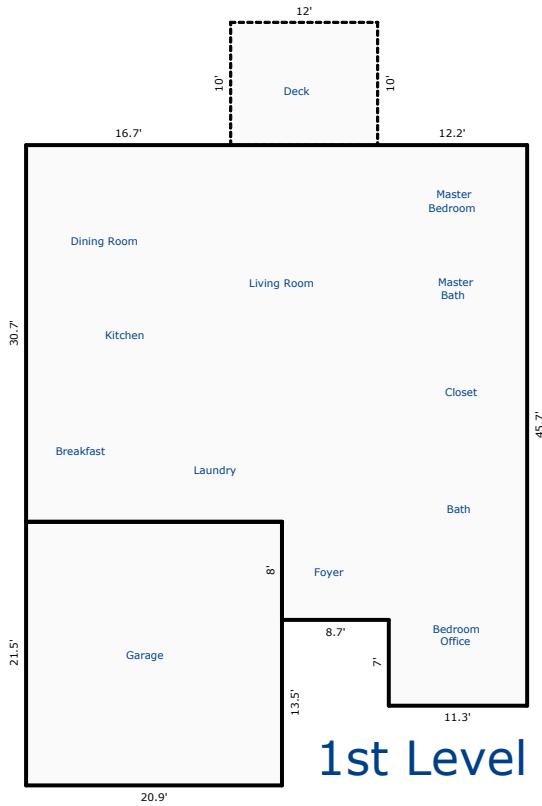

Sketch by Apex Sketch v5 Standard™

Comments:

AREA CALCULATIONS SUMMARY			
Code	Description	Net Size	Net Totals
GLA1	First Floor	1494.73	
	Second Floor	839.75	2334.48
GAR	Garage	449.35	449.35
P/P	Wood Deck	120.00	120.00
Net LIVABLE Area		(rounded)	2334

LIVING AREA BREAKDOWN		
	Breakdown	Subtotals
<b>First Floor</b>		
	40.9 x 30.7	1255.63
	7.0 x 11.3	79.10
	8.0 x 20.0	160.00
<b>Second Floor</b>		
	13.5 x 16.5	222.75
	30.5 x 10.0	305.00
	8.0 x 28.0	224.00
	8.0 x 11.0	88.00
7 Items	(rounded)	2334