

INVOICE

FROM:

Advanced Appraisal Services
 Advanced Appraisal Services
 PO Box 11373
 Knoxville, TN 37939-1373

Telephone Number: (865) 588-4008 Fax Number: (865) 637-2394

TO:

The Holli McCray Group

Knoxville, TN

E-Mail: verdeaux@kw.com

Telephone Number: (865) 851-0181

Fax Number:

Alternate Number:

INVOICE NUMBER

0043797

DATES

Invoice Date: 02/25/2019

Due Date: 02/25/2019

REFERENCE

Internal Order #: 0043797

Lender Case #:

Client File #:

FHA/VA Case #:

Main File # on form: 0043797

Other File # on form: 0043797

Federal Tax ID: 62-1867763

Employer ID:

DESCRIPTION

Lender: The Holli McCray Group **Client:** The Holli McCray Group
Purchaser/Borrower: Aubrey Deck
Property Address: 821 Asheville Hwy
City: Strawberry Plains
County: Sevier **State:** TN **Zip:** 37932
Legal Description: Lot 0022 Sherwood Forest

FEES

AMOUNT

Measure	75.00
interior	0.00

SUBTOTAL 75.00

PAYMENTS

AMOUNT

Check #:	Date:	Description:	
Check #:	Date:	Description:	
Check #:	Date:	Description:	

SUBTOTAL 0

TOTAL DUE \$ 75.00

Supplemental Addendum

File No. 0043797

Borrower	Aubrey Deck		
Property Address	821 Asheville Hwy		
City	Strawberry Plains	County	Sevier
		State	TN
		Zip Code	37932
Lender/Client	The Holli McCray Group		

821 Asheville Hwy- 1358 sq ft

- Kitchen 14 x 12**
- Dining 11 x 12**
- Living 18 x 13**
- Master Bed 15 x 12**
- Master Bath 9 x 7**
- Bed 2 13 x 10**
- Bed 3 16 x 11**
- Bath 8 x 7**

Signature _____
 Name Jeremy Skalet
 Date Signed _____
 State Certification # 3215 State TN
 Or State License # _____ State _____

Signature _____
 Name _____
 Date Signed _____
 State Certification # _____ State _____
 Or State License # _____ State _____

Subject Photo Page

Borrower	Aubrey Deck				
Property Address	821 Asheville Hwy				
City	Strawberry Plains	County	Sevier	State	TN Zip Code 37932
Lender/Client	The Holli McCray Group				



Subject Front

821 Asheville Hwy

1,358



Subject Rear

Subject Street

Building Sketch

Borrower	Aubrey Deck				
Property Address	821 Asheville Hwy				
City	Strawberry Plains	County	Sevier	State	TN
Lender/Client	The Holli McCray Group				
				Zip Code	37932

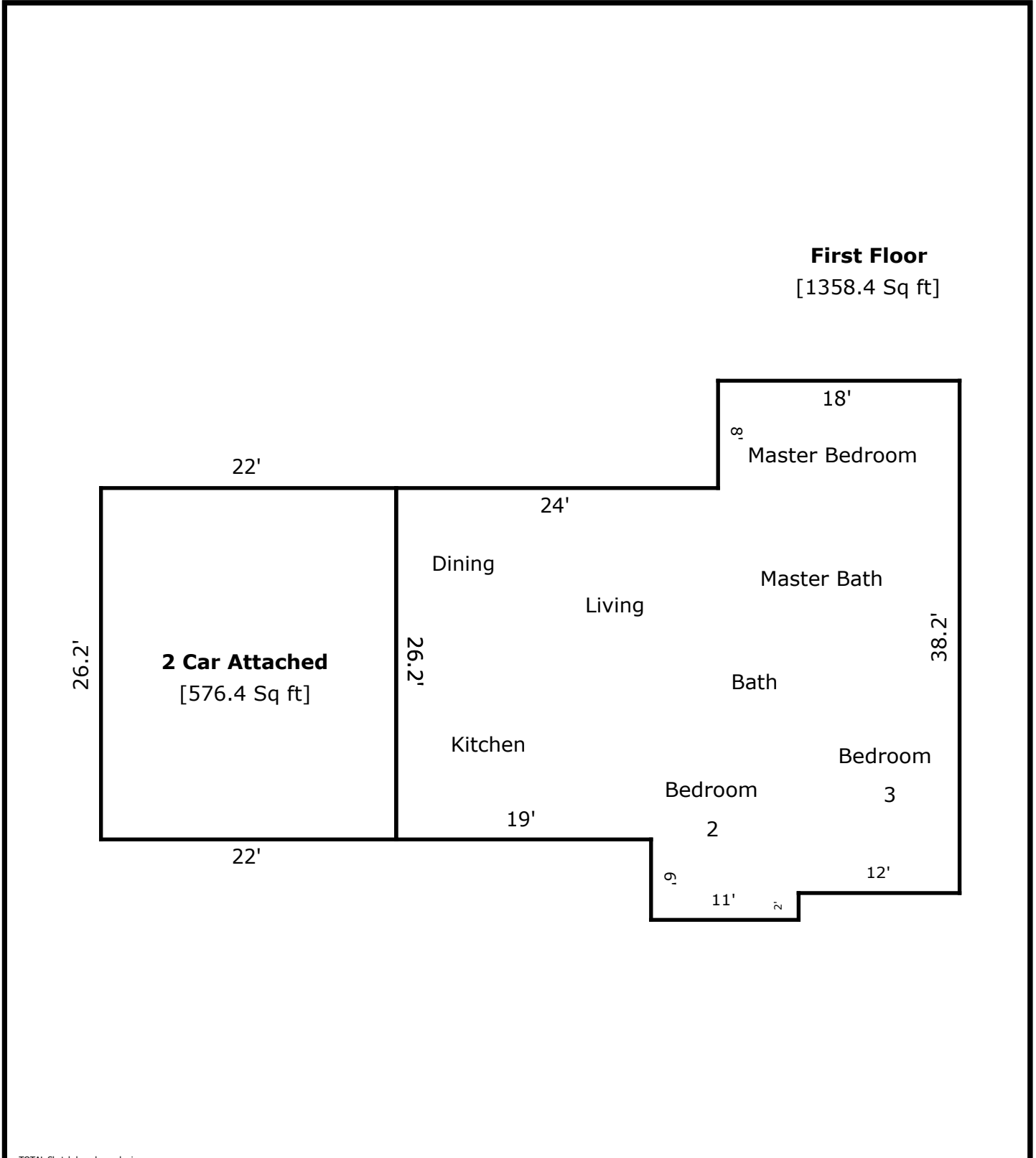

TOTAL Sketch by a la mode, inc.

Area Calculations Summary

Living Area	Calculation Details	
First Floor	1358.4 Sq ft	26.2 × 19 = 497.8 18 × 8 = 144 23 × 30.2 = 694.6 11 × 2 = 22
Total Living Area (Rounded):	1358 Sq ft	
Non-living Area		
2 Car Attached	576.4 Sq ft	22 × 26.2 = 576.4