

# INVOICE

**FROM:**

Advanced Appraisal Services  
 Advanced Appraisal Services  
 PO Box 11373  
 Knoxville, TN 37939-1373

Telephone Number: (865) 588-4008 Fax Number: (865) 637-2394

**TO:**

The Holli McCray Group

Knoxville, TN

E-Mail: verdeaux@kw.com

Telephone Number: (865) 851-0181 Fax Number:

Alternate Number:

**INVOICE NUMBER**

0043884

**DATES**

Invoice Date: 02/28/2019

Due Date: 02/28/2019

**REFERENCE**

Internal Order #: 0043884

Lender Case #:

Client File #:

FHA/VA Case #:

Main File # on form: 0043884

Other File # on form: 0043884

Federal Tax ID: 62-1867763

Employer ID:

**DESCRIPTION**

**Lender:** The Holli McCray Group **Client:** The Holli McCray Group  
**Purchaser/Borrower:** Amber Magnus  
**Property Address:** 1912 Mahogany Wood Trl  
**City:** Knoxville  
**County:** Knox **State:** TN **Zip:** 37932  
**Legal Description:** Lot 3 Woodcreek Reserve

**FEES**

**AMOUNT**

Measure	75.00
interior	0.00

**SUBTOTAL** 75.00

**PAYMENTS**

**AMOUNT**

<b>Check #:</b>	<b>Date:</b>	<b>Description:</b>	
Check #:	Date:	Description:	
Check #:	Date:	Description:	

**SUBTOTAL** 0

**TOTAL DUE** \$ 75.00

**Supplemental Addendum**

File No. 0043884

Borrower	Amber Magnus				
Property Address	1912 Mahogany Wood Trl				
City	Knoxville	County	Knox	State	TN Zip Code 37932
Lender/Client	The Holli McCray Group				

**1912 Mahogany Wood- 2449 sq ft**

**1st Level- 984 sq ft**

- Dining 15 x 11**
- Half Bath 7 x 3**
- Kitchen 15 x 10**
- Breakfast 14 x 8**
- Living 20 x 15**

**2nd Level- 1465 sq ft**

- Bonus 20 x 14**
- Master Bed 16 x 15**
- Master Bath 14 x 9**
- Laundry 7 x 6**
- Bath 11 x 5**
- Bed 2 13 x 12**
- Bed 3 13 x 12**

Signature \_\_\_\_\_  
 Name Jeremy Skalet  
 Date Signed \_\_\_\_\_  
 State Certification # 3215 State TN  
 Or State License # \_\_\_\_\_ State \_\_\_\_\_

Signature \_\_\_\_\_  
 Name \_\_\_\_\_  
 Date Signed \_\_\_\_\_  
 State Certification # \_\_\_\_\_ State \_\_\_\_\_  
 Or State License # \_\_\_\_\_ State \_\_\_\_\_

### Subject Photo Page

Borrower	Amber Magnus				
Property Address	1912 Mahogany Wood Trl				
City	Knoxville	County	Knox	State	TN
Lender/Client	The Holli McCray Group				
				Zip Code	37932



#### Subject Front

1912 Mahogany Wood Trl

2,449

2



#### Subject Rear

#### Subject Street

### Building Sketch

Borrower	Amber Magnus				
Property Address	1912 Mahogany Wood Trl				
City	Knoxville	County	Knox	State	TN
Lender/Client	The Holli McCray Group				
				Zip Code	37932

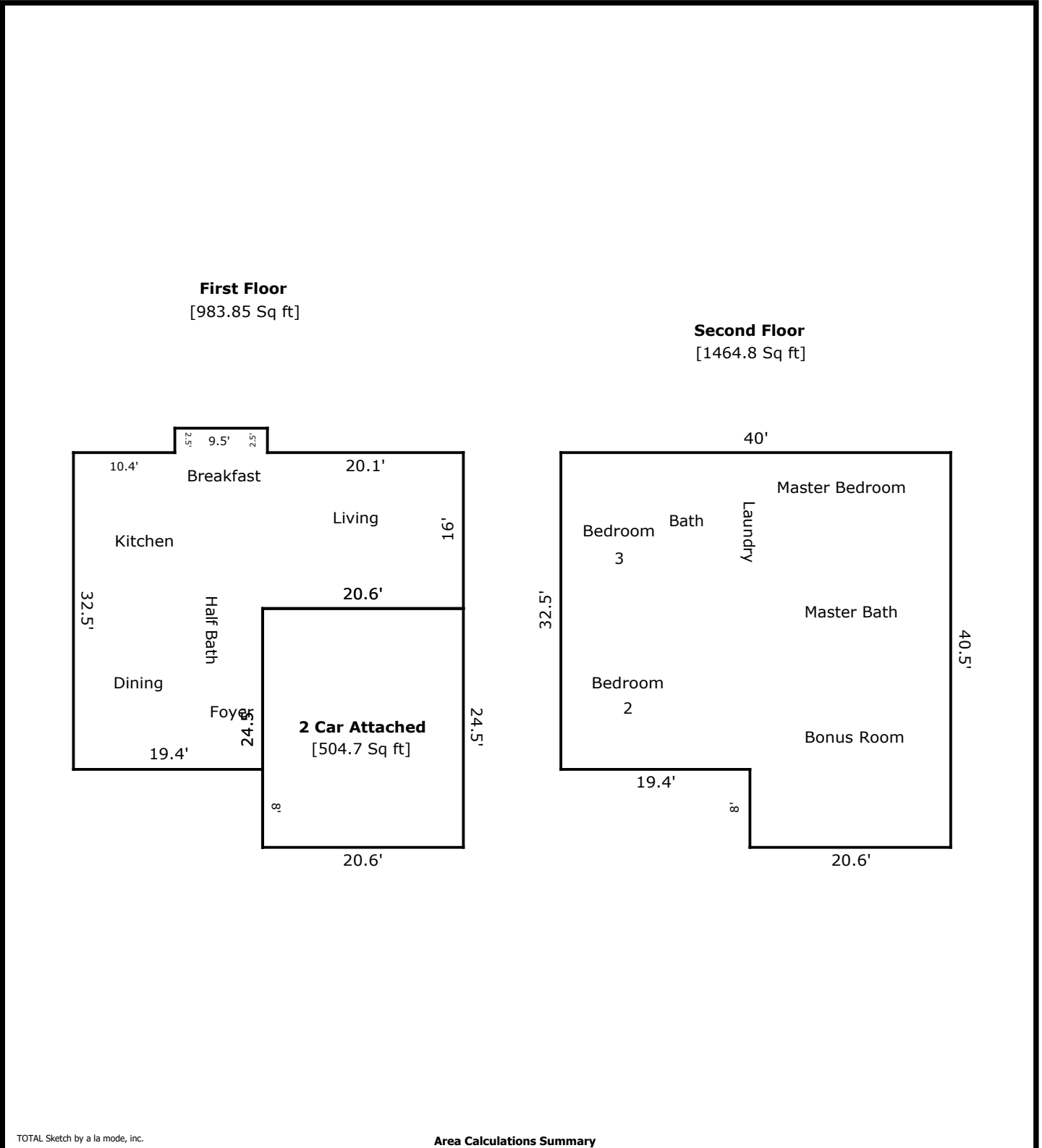

TOTAL Sketch by a la mode, inc.

**Area Calculations Summary**

Living Area		Calculation Details
First Floor	983.85 Sq ft	$9.5 \times 2.5 = 23.75$ $19.4 \times 16.5 = 320.1$ $16 \times 40 = 640$
Second Floor	1464.8 Sq ft	$40 \times 32.5 = 1300$ $20.6 \times 8 = 164.8$
<b>Total Living Area (Rounded):</b>		<b>2449 Sq ft</b>
Non-living Area		
2 Car Attached	504.7 Sq ft	$20.6 \times 24.5 = 504.7$