

FROM:

Telephone Number: (865) 588-4008 **Fax Number:** (865) 637-2394

0043809

Invoice Date: 02/27/2019

Due Date: 02/27/2019

Internal Order #: 0043809

Lender Case #:

Client File #:

FHA/VA Case #:

Main File # on form: 0043809

Other File # on form: 0043809

Federal Tax ID: 62-1867763

Employer ID:

The Holli McCray Group

Knoxville, TN

E-Mail: verdeaux@kw.com

Telephone Number: (865) 851-0181

Fax Number:

Alternate Number:

Lender: The Holli McCray Group

Client: The Holli McCray Group

Purchaser/Borrower: Michelle Murphy

Property Address: 111 Amanda Pl

City: Oak Ridge

County: Anderson

State: TN **Zip:** 37932

Legal Description: Book 1657 Page 2479

AMOUNT

Measure	75.00
Interior	0.00

AMOUNT

Check #:	Date:	Description:
Check #:	Date:	Description:
Check #:	Date:	Description:

SUBTOTAL	0
----------	---

TOTAL DUE	\$	75.00
------------------	-----------	--------------

Supplemental Addendum

File No. 0043809

Borrower	Michelle Murphy					
Property Address	111 Amanda Pl					
City	Oak Ridge	County	Anderson	State	TN	Zip Code 37932
Lender/Client	The Holli McCray Group					

111 Amanda- 3235 sq ft

1st Level- 1286 sq ft

Living 29 x 13
Half Bath 7 x 4
Dining 13 x 13
Kitchen/Breakfast 27 x 14

2nd Level- 1949 sq ft

Bonus 28 x 15
Bath 2 10 x 5
Bed 2 14 x 12
Bed 3 14 x 11
Bath 3 11 x 7
Master Bed 13 x 19
Master Bath 15 x 10
Master Closet 13 x 5

Signature _____
Name Jeremy Skalet
Date Signed _____
State Certification # 3215 State TN
Or State License # _____ State _____

Signature _____
Name _____
Date Signed _____
State Certification # _____ State _____
Or State License # _____ State _____

Building Sketch

Borrower	Michelle Murphy						
Property Address	111 Amanda Pl						
City	Oak Ridge	County	Anderson	State	TN	Zip Code	37932
Lender/Client	The Holli McCray Group						

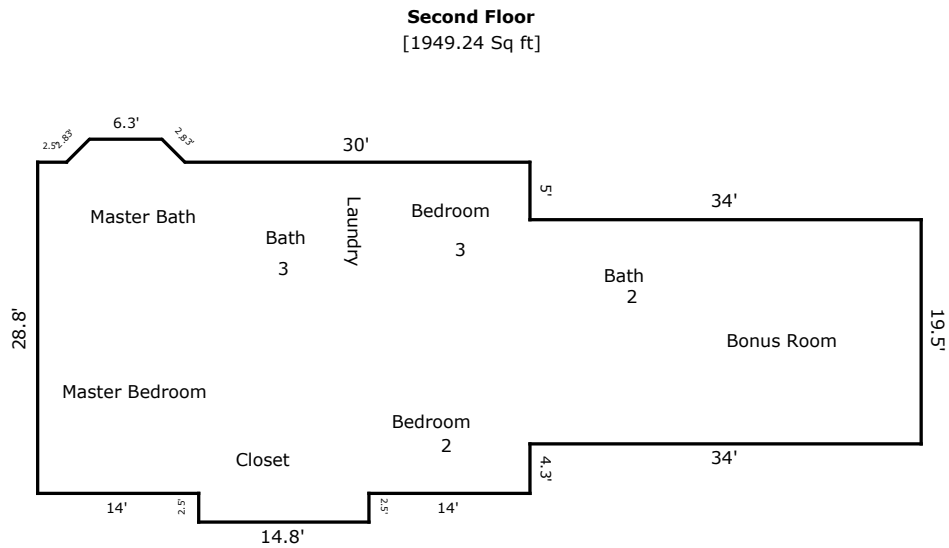
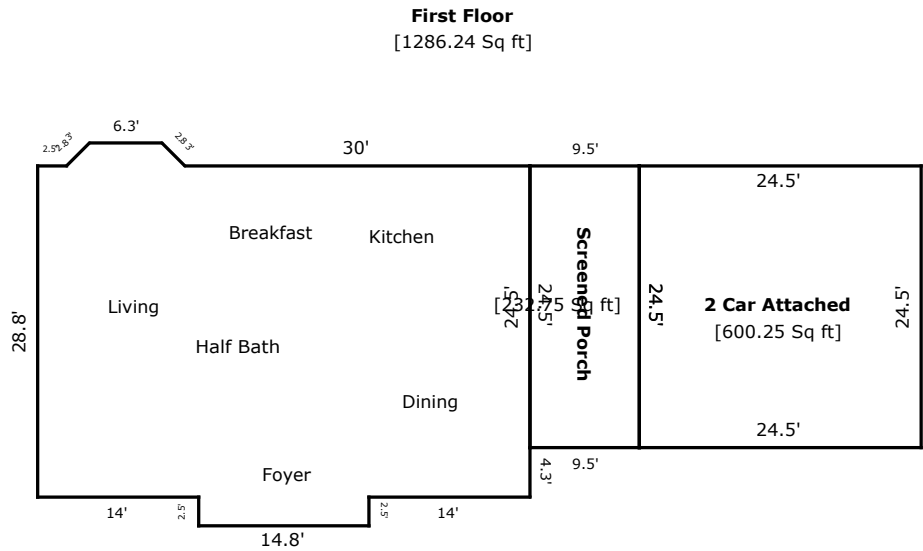

TOTAL Sketch by a la mode, inc.

Area Calculations Summary

Living Area		Calculation Details	
First Floor	1286.24 Sq ft	$14.8 \times 2.5 = 37$ $0.5 \times 2 \times 2 = 2$ $0.5 \times 2 \times 2 = 2$ $6.3 \times 2 = 12.6$ $42.8 \times 28.8 = 1232.64$	
Second Floor	1949.24 Sq ft	$14.8 \times 2.5 = 37$ $0.5 \times 2 \times 2 = 2$ $0.5 \times 2 \times 2 = 2$ $6.3 \times 2 = 12.6$ $19.5 \times 34 = 663$ $28.8 \times 42.8 = 1232.64$	
Total Living Area (Rounded):		3235 Sq ft	
Non-living Area			
2 Car Attached	600.25 Sq ft	$24.5 \times 24.5 =$	600.25
Screened Porch	232.75 Sq ft	$24.5 \times 9.5 =$	232.75