

FROM:

Advanced Appraisal Services
Advanced Appraisal Services
PO Box 11373
Knoxville, TN 37939-1373

Telephone Number: (865) 588-4008Fax Number: (865) 637-2394

TTO:

The Holli McCray Group

Knoxville, TN

E-Mail: verdeaux@kw.com
Telephone Number: (865) 851-0181Fax Number:
Alternate Number:

INVOICE

INVOICE NUMBER

0043623

DATES

Invoice Date: 01/31/2019
Due Date: 01/31/2019

REFERENCE

Internal Order #: 0043623
Lender Case #:
Client File #:
FHA/VA Case #:
Main File # on form: 0043623
Other File # on form: 0043623
Federal Tax ID: 62-1867763
Employer ID:

DESCRIPTION

Lender: The Holli McCray GroupPurchaser/Borrower: n/aProperty Address: 2118 Beacon Light WayCity: KnoxvilleCounty: KnoxLegal Description: Lot 42 Cascade Villas Phase 2F

Client: The Holli McCray GroupState: TNZip: 37932

FEESAMOUNT

Measure interior

75.000.00

SUBTOTAL75.00

PAYMENTSAMOUNT

Check #:Date:Description:

Check #:Date:Description:

Check #:Date:Description:

SUBTOTAL0

TOTAL DUE\$75.00

Supplemental Addendum

File No. 0043623

Borrower	n/a				
Property Address	2118 Beacon Light Way				
City	Knoxville	County	Knox	State	TN Zip Code 37932
Lender/Client	The Holli McCray Group				

2118 Beacon Light- 1134 sq ft

- Bed 12 x 12

Bath 10 x 5

Living 13 x 17

Kitchen 10 x 10

Dining 10 x 10

Master Bed 13 x 14

Master Bath 11 x 5

Signature _____

Name **Jeremy Skalet** _____

Date Signed _____

State Certification # **3215** _____ State **TN** _____

Or State License # _____ State _____

Signature _____

Name _____

Date Signed _____

State Certification # _____ State _____

Or State License # _____ State _____

Subject Photo Page

Borrower	n/a				
Property Address	2118 Beacon Light Way				
City	Knoxville	County	Knox	State	TN Zip Code 37932
Lender/Client	The Holli McCray Group				



Subject Front

2118 Beacon Light Way

1,134



Subject Rear

Subject Street

Building Sketch

Borrower	n/a				
Property Address	2118 Beacon Light Way				
City	Knoxville	County	Knox	State	TN
Lender/Client	The Holli McCray Group				
				Zip Code	37932

First Floor
[1134.31 Sq ft]

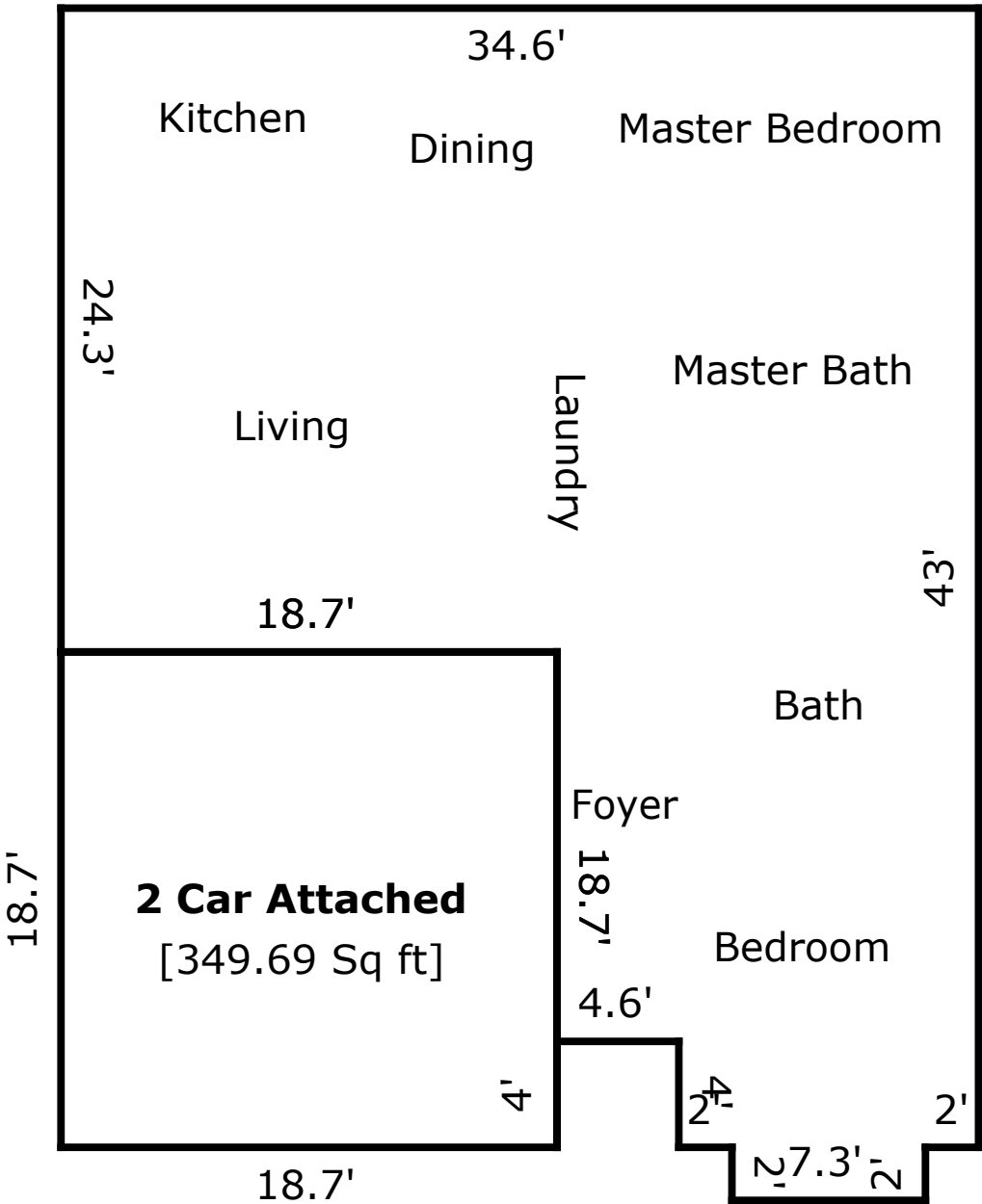

TOTAL Sketch by a la mode, inc.

Area Calculations Summary

Living Area		Calculation Details
First Floor	1134.31 Sq ft	$7.3 \times 2 = 14.6$ $24.3 \times 18.7 = 454.41$ $39 \times 15.9 = 620.1$ $4 \times 11.3 = 45.2$
Total Living Area (Rounded):		1134 Sq ft
Non-living Area		
2 Car Attached	349.69 Sq ft	$18.7 \times 18.7 = 349.69$