

Supplemental Addendum

File No. 0043342

Borrower	The Holli McCray Group					
Property Address	7208 Periwinkle					
City	Knoxville	County	Knox	State	TN	Zip Code 37932
Lender/Client	The Holli McCray Group					

7208 Periwinkle - 1553 sq ft

1st Level- 1093 sq ft

Living 12 x 13

Dining 12 x 9

Kitchen 12 x 8

Bath 11 x 5

Master Bed 12 x 13

Half Bath 5 x 5

Bed 2 10 x 10

Bed 3 13 x 10

Basement- 460 sq ft

Laundry/Bath 10 x 6

Family 22 x 11

Sun Room- 221 sq ft (If this space is heated and cooled, add to total finished space. I could not find a vent in the room)

Signature _____
Name Jeremy Skalet
Date Signed _____
State Certification # 3215 State TN
Or State License # _____ State _____

Signature _____
Name _____
Date Signed _____
State Certification # _____ State _____
Or State License # _____ State _____

Building Sketch

Borrower	The Holli McCray Group						
Property Address	7208 Periwinkle						
City	Knoxville	County	Knox	State	TN	Zip Code	37932
Lender/Client	The Holli McCray Group						

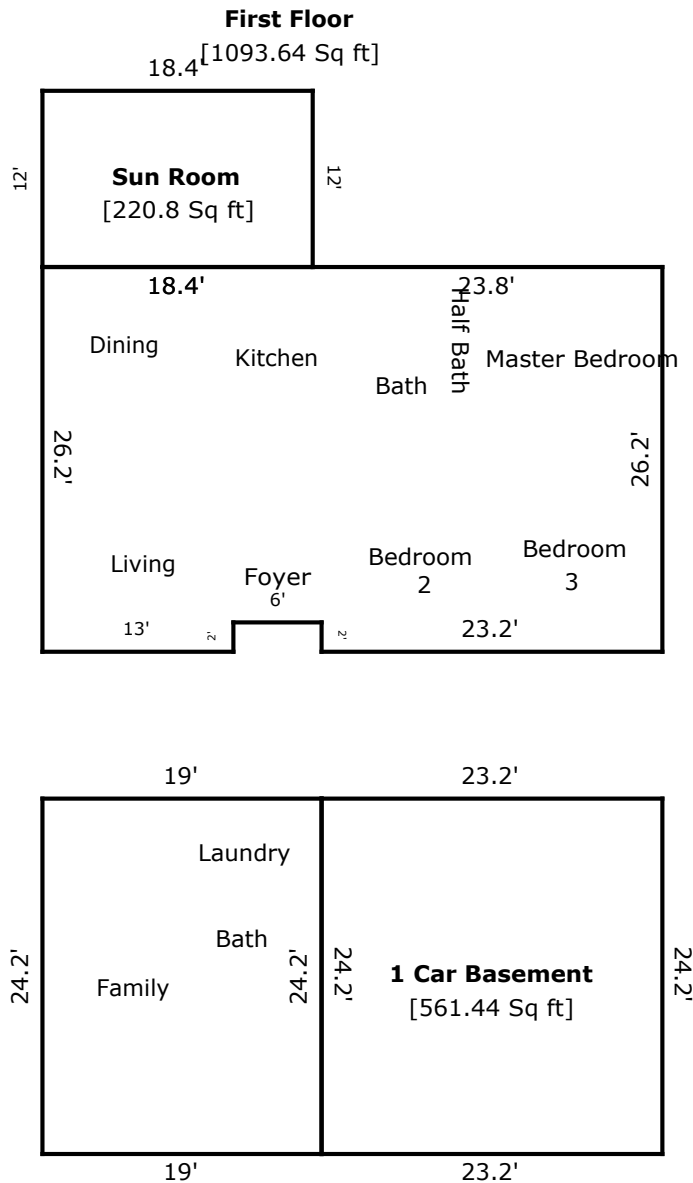

Basement
[459.8 Sq ft]

TOTAL Sketch by a la mode, inc.

Area Calculations Summary

Living Area		Calculation Details	
First Floor	1093.64 Sq ft	$42.2 \times 24.2 =$	1021.24
		$2 \times 13 =$	26
		$2 \times 23.2 =$	46.4
Basement	459.8 Sq ft	$24.2 \times 19 =$	459.8
Total Living Area (Rounded):		1553 Sq ft	
Non-living Area			
1 Car Basement	561.44 Sq ft	$23.2 \times 24.2 =$	561.44
Sun Room	220.8 Sq ft	$12 \times 18.4 =$	220.8

Subject Photo Page

Borrower	The Holli McCray Group					
Property Address	7208 Periwinkle					
City	Knoxville	County	Knox	State	TN	Zip Code 37932
Lender/Client	The Holli McCray Group					



Subject Front

7208 Periwinkle

1,553



Subject Rear

Subject Street