

Subject Photo Page

Borrower	Robin Shell				
Property Address	2312 Cove Field Rd				
City	Knoxville	County	Knox	State	TN
Lender/Client	Robin Shell				
				Zip Code	37919



Subject Front



Subject Street

Supplemental Addendum

File No. 0043363

Borrower	Robin Shell		
Property Address	2312 Cove Field Rd		
City	Knoxville	County	Knox
Lender/Client	Robin Shell		
		State	TN
		Zip Code	37919

Measurements for 2312 Cove Field Rd

1st Floor	1534 square feet
2nd Floor	1952 square feet
Garage	616 square feet

The above measurements are completed according to appraisal industry standards.

Interior Room Measurements**1st Floor**

Eat-In Kitchen	23 x 13.5 x irr
Dining	13.5 x 11
Living	16 x 13.5 x irr
Office	15 x 13.5
Half Bath	6 x 5
Laundry Closet	6 x 3
Sunroom	13 x 11.5

2nd Floor

Master Bedroom	20 x 14 x irr
Master Bath	10 x 7.5
Master Closet	11.5 x 10
Bedroom 2	13.5 x 11.5
Bedroom 3	13.5 x 11.5
Bedroom 4	14 x 13
Jack and Jill Bath	10.5 x 8.5
Bonus	28 x 16

The room measurements are interior wall to interior wall and rounded to the nearest 0.5 foot.

Building Sketch

Borrower	Robin Shell			
Property Address	2312 Cove Field Rd			
City	Knoxville	County	Knox	State TN Zip Code 37919
Lender/Client	Robin Shell			

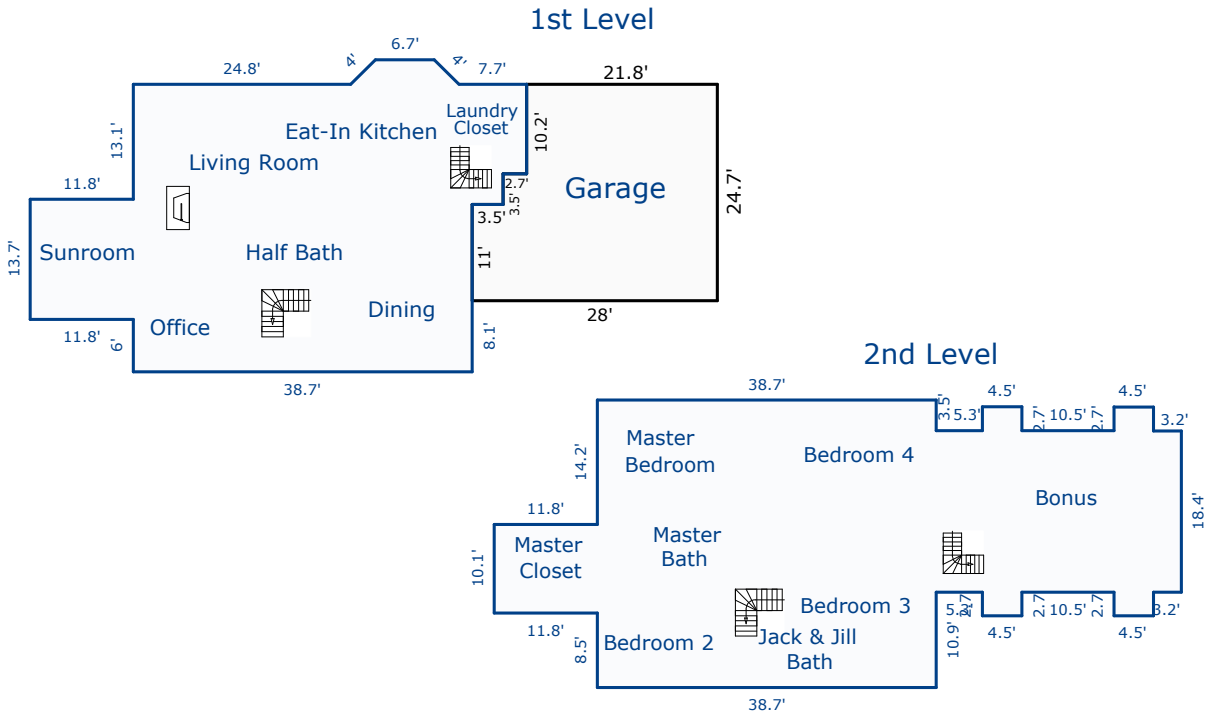

Sketch by Apex Sketch v5 Standard™

Comments:

AREA CALCULATIONS SUMMARY			
Code	Description	Net Size	Net Totals
GLA1	First Floor	1533.46	1533.46
GLA2	Second Floor	1952.34	1952.34
GAR	Garage	616.11	616.11
Net LIVABLE Area		(rounded)	3486

LIVING AREA BREAKDOWN		
	Breakdown	Subtotals
First Floor		
	54.0 x 0.6	32.40
	13.1 x 50.5	661.55
	2.9 x 42.2	122.38
	6.0 x 38.7	232.20
0.5 x	2.8 x 2.8	4.00
	10.2 x 44.9	457.98
	6.7 x 2.8	18.95
0.5 x	2.8 x 2.8	4.00
Second Floor		
	38.7 x 8.5	328.95
	50.5 x 2.4	121.20
	10.7 x 66.7	713.69
	2.7 x 4.5	12.15
	2.7 x 4.5	12.15
	7.7 x 78.5	604.45
	3.5 x 38.7	135.45
	2.7 x 4.5	12.15
	2.7 x 4.5	12.15
17 Items	(rounded)	3486