

INVOICE

FROM:

Advanced Appraisal Services
 Advanced Appraisal Services
 PO Box 11373
 Knoxville, TN 37939-1373

Telephone Number: (865) 588-4008 Fax Number: (865) 637-2394

TO:

The Holli McCray Group

Knoxville, TN

E-Mail: verdeaux@kw.com

Telephone Number: (865) 851-0181 Fax Number:

Alternate Number:

INVOICE NUMBER

0042979

DATES

Invoice Date: 10/29/2018

Due Date: 10/29/2018

REFERENCE

Internal Order #: 0042979

Lender Case #:

Client File #:

FHA/VA Case #:

Main File # on form: 0042979

Other File # on form: 0042979

Federal Tax ID: 62-1867763

Employer ID:

DESCRIPTION

Lender: The Holli McCray Group	Client: The Holli McCray Group
Purchaser/Borrower: Eva Middendorf	
Property Address: 562 Carrington	
City: Lenoir City	
County: Loudon	State: TN Zip: 37932
Legal Description: Lot 94 Carrington	

FEES

AMOUNT

Measure interior	75.00 0.00
SUBTOTAL	75.00

PAYMENTS

AMOUNT

Check #:	Date:	Description:	
Check #:	Date:	Description:	
Check #:	Date:	Description:	
SUBTOTAL			0
TOTAL DUE			\$ 75.00

Supplemental Addendum

File No. 0042979

Borrower	Eva Middendorf				
Property Address	562 Carrington				
City	Lenoir City	County	Loudon	State	TN Zip Code 37932
Lender/Client	The Holli McCray Group				

562 Carrington- 1961 sq ft

1st Level- 1961 sq ft

- Dining 12 x 11**
- Living 16 x 19**
- Bed 2 12 x 12**
- Bath 2 8 x 9**
- Bed 3 12 x 12**
- Kitchen 11 x 11**
- Breakfast 11 x 8**
- Master Bed 15 x 14**
- Master Bath 10 x 10**
- Master Closet 10 x 7**
- Laundry 11 x 7**

Unfinished Basement- 1961 sq ft

Signature _____
 Name Jeremy Skalet
 Date Signed _____
 State Certification # 3215 State TN
 Or State License # _____ State _____

Signature _____
 Name _____
 Date Signed _____
 State Certification # _____ State _____
 Or State License # _____ State _____

Subject Photo Page

Borrower	Eva Middendorf						
Property Address	562 Carrington						
City	Lenoir City	County	Loudon	State	TN	Zip Code	37932
Lender/Client	The Holli McCray Group						



Subject Front

562 Carrington

1,961



Subject Rear

Subject Street

Building Sketch

Borrower	Eva Middendorf			
Property Address	562 Carrington			
City	Lenoir City	County Loudon	State TN	Zip Code 37932
Lender/Client	The Holli McCray Group			

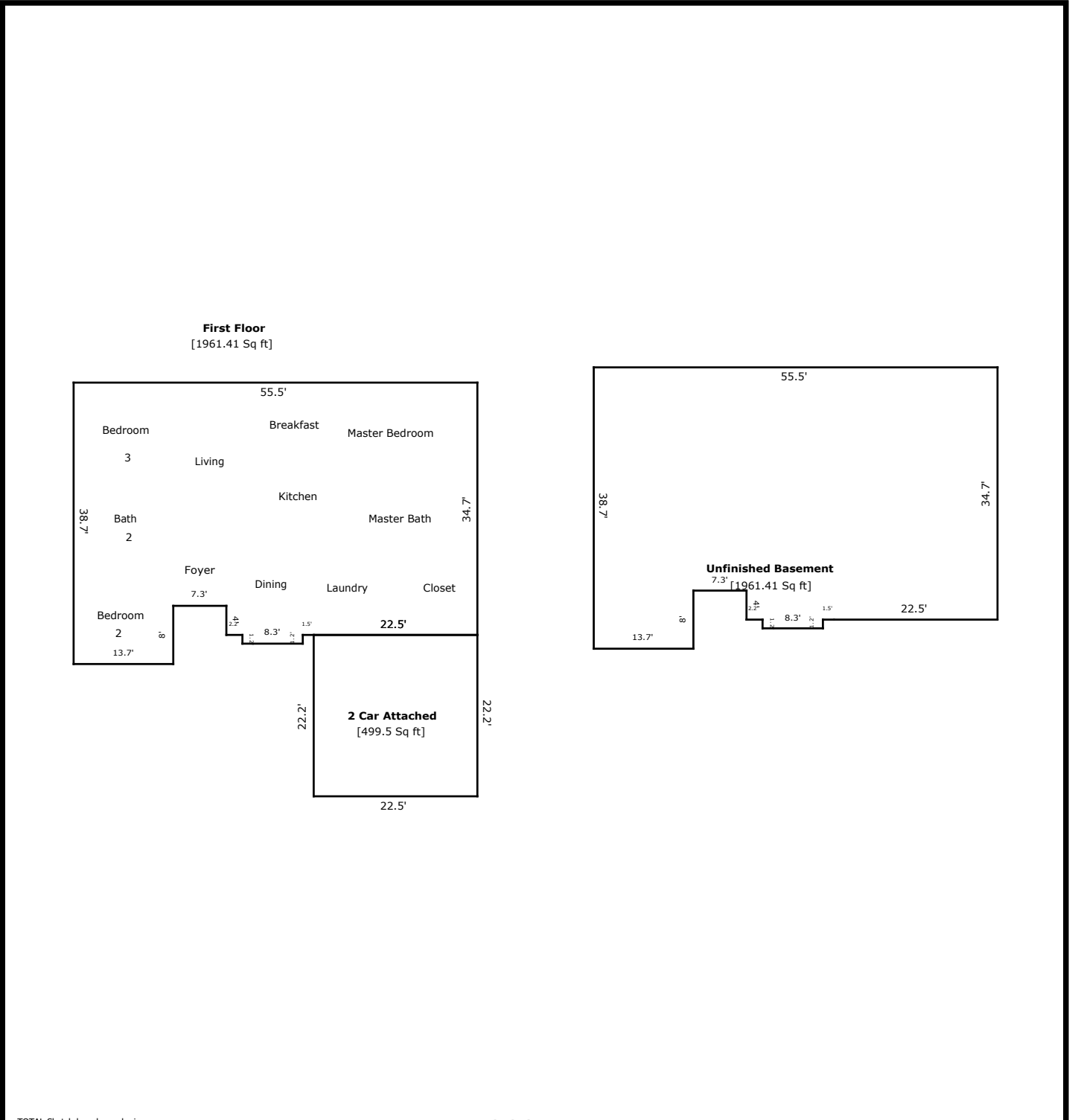

TOTAL Sketch by a la mode, inc.

Area Calculations Summary

Living Area	Area	Calculation Details
First Floor	1961.41 Sq ft	$8.3 \times 1.2 = 9.96$ $34.7 \times 34.5 = 1197.15$ $21 \times 30.7 = 644.7$ $13.7 \times 8 = 109.6$
Total Living Area (Rounded):	1961 Sq ft	
Non-living Area	Area	Calculation Details
Unfinished Basement	1961.41 Sq ft	$8.3 \times 1.2 = 9.96$ $34.7 \times 34.5 = 1197.15$ $21 \times 30.7 = 644.7$ $8 \times 13.7 = 109.6$
2 Car Attached	499.5 Sq ft	$22.5 \times 22.2 = 499.5$