

FROM:

Telephone Number: (865) 588-4008 Fax Number: (865) 637-2394

0042842

Due Date: 10/06/2018

Employer ID:

Alternate Number:

State: TN **Zip:** 37932

AMOUNT

75.00
0.00

AMOUNT

0

TOTAL DUE	\$	75.00
-----------	----	-------

Supplemental Addendum

File No. 0042842

Borrower	Stuart McCullough				
Property Address	362 Garnet Hill				
City	Lenoir City	County	Loudon	State	TN Zip Code 37932
Lender/Client	The Holli McCray Group				

309 Orchard Knob- 3726 sq ft

1st Level- 2843 sq ft

- Great Room 15 x 26
- Dining 12 x 12
- Kitchen 21 x 11
- Future Bonus Room 23 x 31
- Half Bath 5 x 5
- Master Bed 16 x 12
- Master Bath 10 x 7
- Bed 2 12 x 11
- Bed 3 11 x 10
- Bed 4 12 x 11
- Bath 11 x 7

Basement- 883 sq ft

- Laundry 11 x 16
- Bar 5 x 9
- Rec 10 x 12
- Family 13 x 25
- Bath 7 x 8

Signature _____

Name Jeremy Skalet

Date Signed _____

State Certification # 3215 State TN

Or State License # _____ State _____

Signature _____

Name _____

Date Signed _____

State Certification # _____ State _____

Or State License # _____ State _____

Subject Photo Page

Borrower	Stuart McCullough					
Property Address	362 Garnet Hill					
City	Lenoir City	County	Loudon	State	TN	Zip Code 37932
Lender/Client	The Holli McCray Group					



Subject Front

362 Garnet Hill

2,888



Subject Rear

Subject Street

Building Sketch

Borrower	Stuart McCullough					
Property Address	362 Garnet Hill					
City	Lenoir City	County	Loudon	State	TN	Zip Code 37932
Lender/Client	The Holli McCray Group					

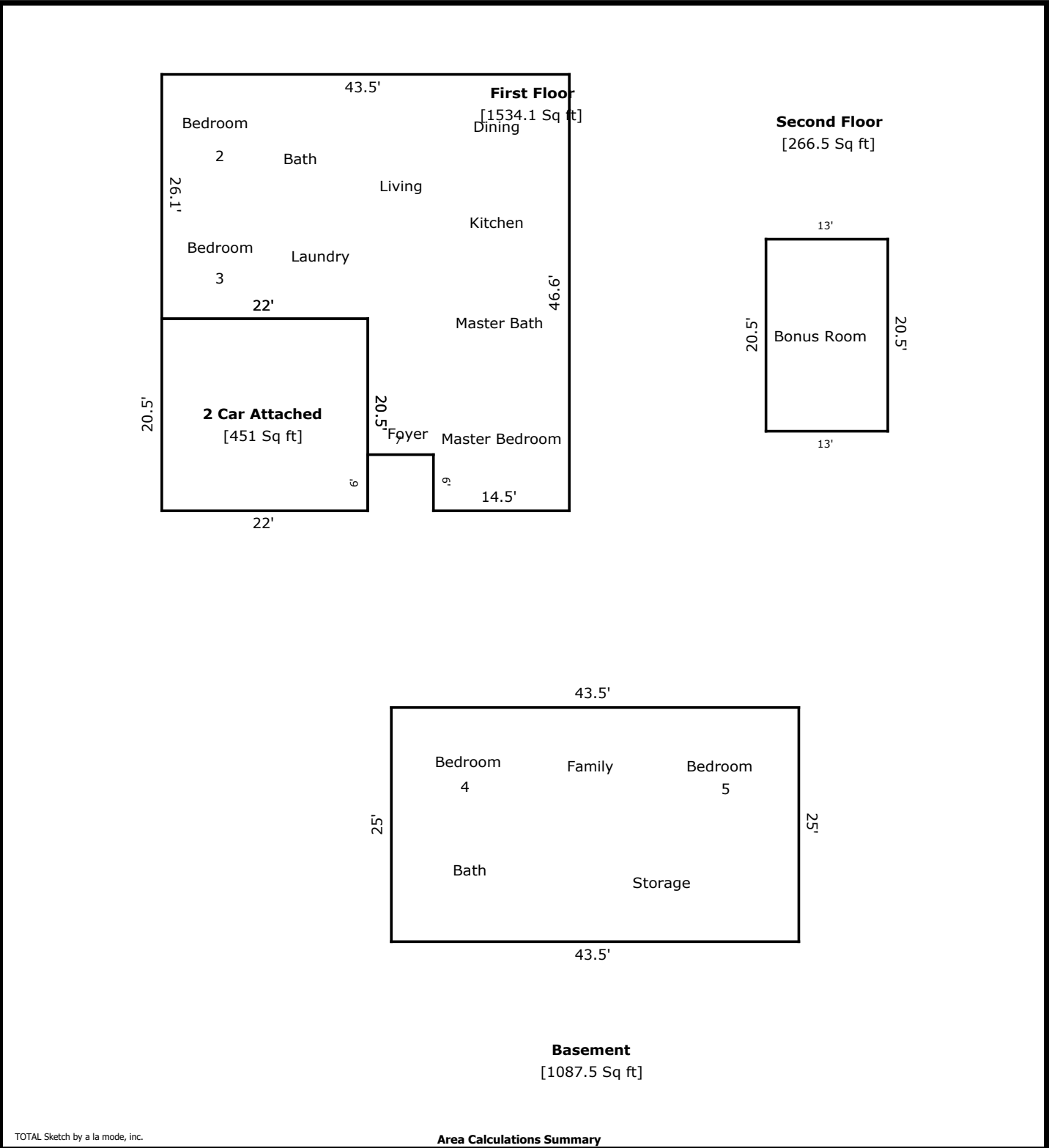

TOTAL Sketch by a la mode, inc.

Area Calculations Summary

Living Area		Calculation Details
First Floor	1534.1 Sq ft	$26.1 \times 22 = 574.2$ $21.5 \times 40.6 = 872.9$ $6 \times 14.5 = 87$
Second Floor	266.5 Sq ft	$20.5 \times 13 = 266.5$
Basement	1087.5 Sq ft	$25 \times 43.5 = 1087.5$
Total Living Area (Rounded):		2888 Sq ft
Non-living Area		
2 Car Attached	451 Sq ft	$20.5 \times 22 = 451$