

Subject Photo Page

Borrower/Client	Matt Davidson					
Property Address	4314 Garden Dr					
City	Knoxville	County	Knox	State	TN	Zip Code 37918
Lender	Lorraine Whitson					



Subject Front

Sales Price
Gross Living Area
Total Rooms
Total Bedrooms
Total Bathrooms
Location
View
Site
Quality
Age



Subject Street

Supplemental Addendum

File No. 0042641

Borrower/Client	Matt Davidson					
Property Address	4314 Garden Dr					
City	Knoxville	County	Knox	State	TN	Zip Code 37918
Lender	Lorraine Whitson					

Measurements for 4314 Garden Dr

1st Floor1929 square feet

Other Areas

Cellar291 square feet

The above measurements are completed according to appraisal industry standards.

Interior Room Measurements

1st Floor

Living	17 x 11
Dining	12 x 9.5
Eat-in-Kitchen	25 x 13.5 x irregular
Laundry	10 x 5.5
1/2 Bath	5.5 x 4
Family Room	19 x 14
Master Bedroom	20 x 14 x irregular
Master Bath	10 x 8
Bedroom	11 x 11.5
Bath	9 x 5
Bedroom	10 x 9

The room measurements are interior wall to interior wall and rounded to the nearest 0.5 foot.

Building Sketch

Borrower/Client	Matt Davidson					
Property Address	4314 Garden Dr					
City	Knoxville	County	Knox	State	TN	Zip Code 37918
Lender	Lorraine Whitson					

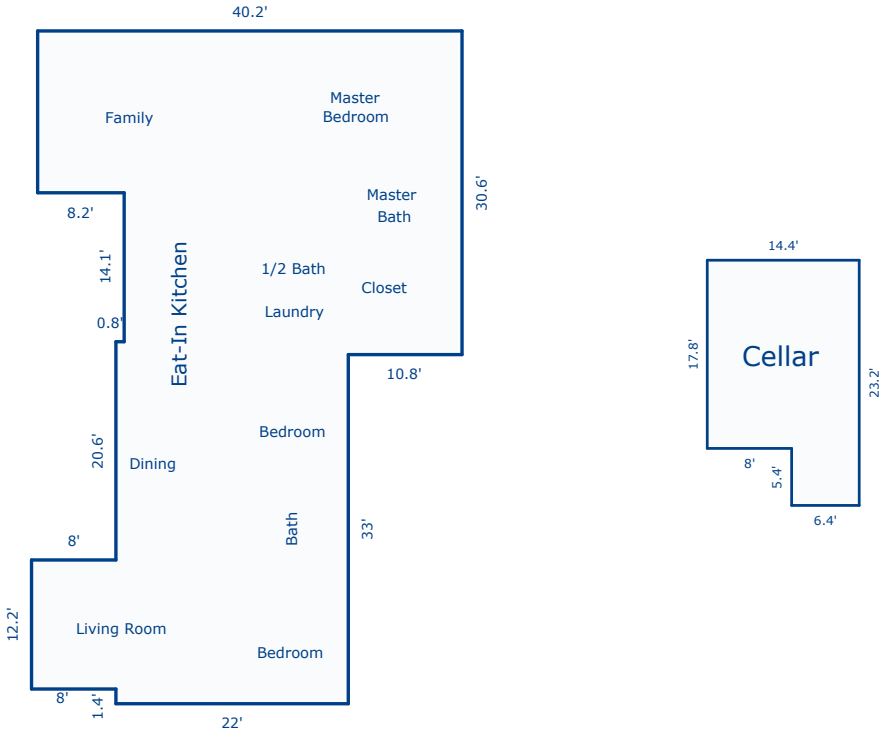

Sketch by Apex Sketch v5 Standard™

Comments:

AREA CALCULATIONS SUMMARY				LIVING AREA BREAKDOWN			
Code	Description	Net Size	Net Totals	Breakdown		Subtotals	
GLA1	First Floor	1929.22	1929.22	First Floor			
OTH	Cellar	290.88	290.88	40.2	x 15.3	615.06	
				19.4	x 22.0	426.80	
				1.2	x 32.8	39.36	
				14.1	x 32.0	451.20	
				1.4	x 22.0	30.80	
				12.2	x 30.0	366.00	
Net LIVABLE Area		(rounded)	1929	6 Items		(rounded)	1929