

INVOICE

FROM:

Advanced Appraisal Services
 Advanced Appraisal Services
 PO Box 11373
 Knoxville, TN 37939-1373

Telephone Number: (865) 588-4008 Fax Number: (865) 637-2394

TO:

The Holli McCray Group

Knoxville, TN

E-Mail: verdeaux@kw.com

Telephone Number: (865) 851-0181 Fax Number:

Alternate Number:

INVOICE NUMBER

0042567

DATES

Invoice Date: 09/04/2018

Due Date: 09/04/2018

REFERENCE

Internal Order #: 0042567

Lender Case #:

Client File #:

FHA/VA Case #:

Main File # on form: 0042567

Other File # on form:

Federal Tax ID: 62-1867763

Employer ID:

DESCRIPTION

Lender: The Holli McCray Group	Client: The Holli McCray Group
Purchaser/Borrower: The Holli McCray Group	
Property Address: 220 Acuff Ln	
City: Blaine	
County: Grainger	State: TN Zip: 37932
Legal Description: Book 333 Page 858	

FEES

AMOUNT

Measure	100.00
Interior	0.00

SUBTOTAL 100.00

PAYMENTS

AMOUNT

Check #:	Date:	Description:	
Check #:	Date:	Description:	
Check #:	Date:	Description:	

SUBTOTAL 0

TOTAL DUE \$ 100.00

Supplemental Addendum

File No. 0042567

Borrower	The Holli McCray Group						
Property Address	220 Acuff Ln						
City	Blaine	County	Grainger	State	TN	Zip Code	37932
Lender/Client	The Holli McCray Group						

220 Acuff- 1700 sq ft

1st Level- 1284 sq ft

Half Bath 5 x 5

Living 13 x 12

Kitchen 13 x 14

Dining 12 x 11

Master Bed 13 x 14

Master Bath 12 x 10

Basement- 416 sq ft

Office 16 x 19

Bath 10 x 6

Unfinished Basement/Garage- 1225 sq ft

Detached Garage- 1223 sq ft

Detached Office/Bath- 370 sq ft

Signature _____
Name Jeremy Skalet
Date Signed _____
State Certification # 3215 State TN
Or State License # _____ State _____

Signature _____
Name _____
Date Signed _____
State Certification # _____ State _____
Or State License # _____ State _____

Subject Photo Page

Borrower	The Holli McCray Group						
Property Address	220 Acuff Ln						
City	Blaine	County	Grainger	State	TN	Zip Code	37932
Lender/Client	The Holli McCray Group						



Subject Front

220 Acuff Ln
Sales Price
Gross Living Area 1,700
Total Rooms
Total Bedrooms
Total Bathrooms
Location
View
Site
Quality
Age



Subject Rear



Garage/Office

Building Sketch

Borrower	The Holli McCray Group				
Property Address	220 Acuff Ln				
City	Blaine	County	Grainger	State	TN
Lender/Client	The Holli McCray Group				
				Zip Code	37932

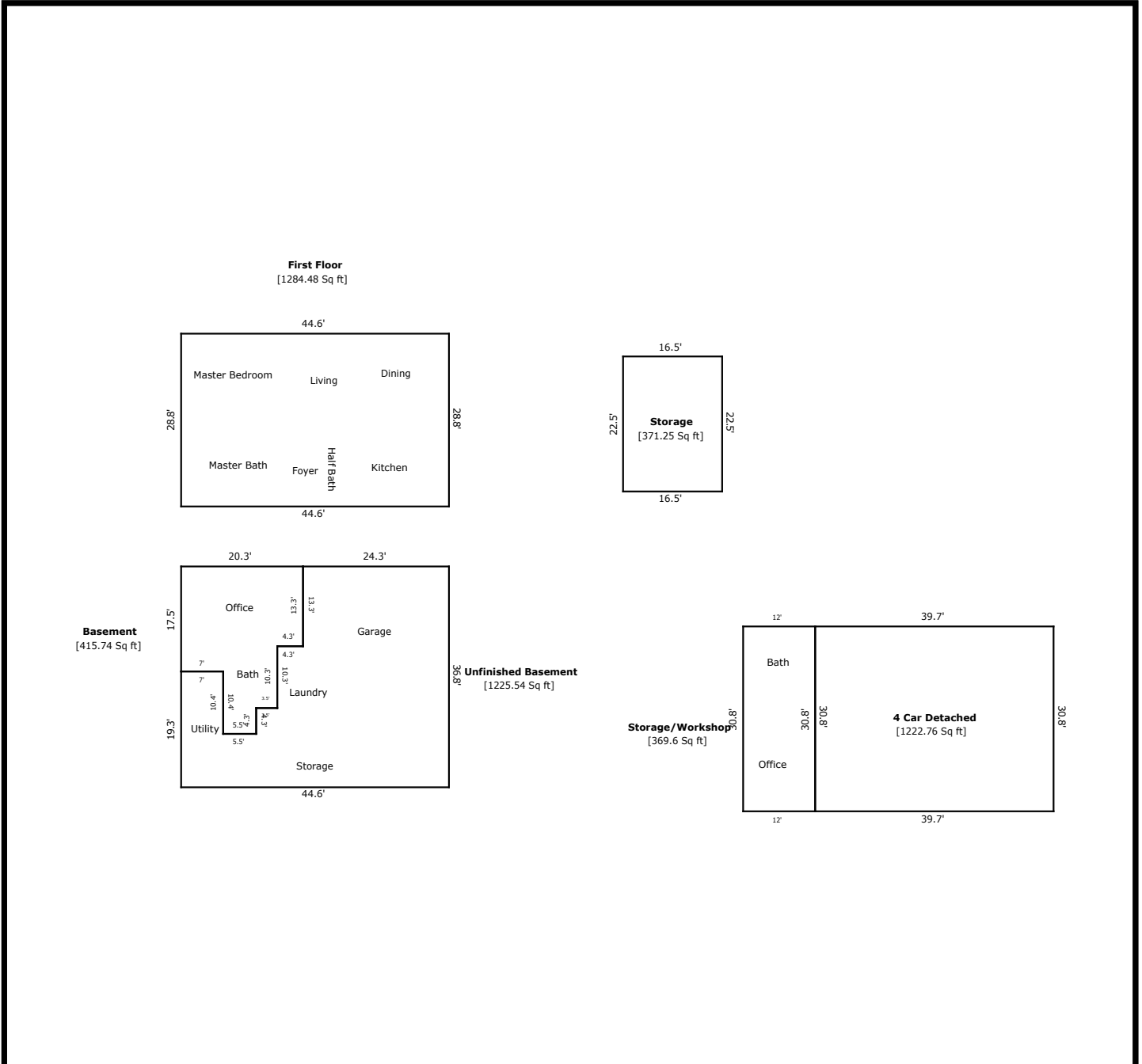

TOTAL Sketch by a la mode, inc.

Area Calculations Summary

Living Area	Area (Sq ft)	Calculation Details
First Floor	1284.48 Sq ft	$28.8 \times 44.6 = 1284.48$
Basement	415.74 Sq ft	$5.5 \times 4.3 = 23.65$ $9 \times 6.1 = 54.9$ $17.5 \times 16 = 280$ $4.3 \times 13.3 = 57.19$
Total Living Area (Rounded):	1700 Sq ft	
Non-living Area		
4 Car Detached	1222.76 Sq ft	$30.8 \times 39.7 = 1222.76$
Storage/Workshop	369.6 Sq ft	$30.8 \times 12 = 369.6$
Unfinished Basement	1225.54 Sq ft	$36.8 \times 24.3 = 894.24$ $20.3 \times 8.9 = 180.67$ $4.3 \times 3.5 = 15.05$ $14.6 \times 4.3 = 62.78$ $10.4 \times 7 = 72.8$
Storage	371.25 Sq ft	$22.5 \times 16.5 = 371.25$